

The Timken Company

4500 Mt Pleasant St. NW

N. Canton, OH 44720

Phone: (234) 262-3000

E-Mail: CustomerCAD@timken.com • **Web site:** www.timken.com
Part Number QACW18A307S, Single Concentric Piloted Flange Cartridge

[Specifications](#) | [Dimensions](#) | [Radial and Thrust Factors](#) | [Engineering Seal Speed](#) | [Engineering Bearing Attributes](#) | [Engineering Internal Radial Clearance](#)

Specifications

Engineering Group Mounted Bearing

Bearing Number 22218

Shaft Size 3 7/16 in

Shaft Size Type Imperial

Full Timken Part Number

- QACW18A307SB
- QACW18A307SC
- QACW18A307SEB
- QACW18A307SEC
- QACW18A307SEM
- QACW18A307SEN
- QACW18A307SEO
- QACW18A307SET
- QACW18A307SM
- QACW18A307SMT
- QACW18A307SN
- QACW18A307SO
- QACW18A307ST



Locking Style Single Concentric

Housing Construction Piloted Flange Cartridge

UPC Code

0883450037402
0883450037419
0883450037433
0883450037440
0883450037457
0883450037464
0883450037471
0883450037488
0883450193924
0883450194082
0883450271097
0883450271257
0883450959445

Dimensions

Dimension BC 8.63 in
219.2 mm

Dimension B Exp 2.54 in
64.5 mm

Dimension B Fix 2.46 in
62.5 mm

Dimension C 5.13 in
130.3 mm

Dimension D 7.13 in
181.1 mm

Dimension E 6.1 in
154.9 mm

Dimension F 10-1/4 in
260.4 mm

Dimension G 7.375 in
187.3 mm

Dimension H	0.88 in 22.4 mm
Dimension J (Bolt Size)	0.75 in 20 mm
Dimension KA	1.44 in 36.6 mm
Dimension L Exp	4.42 in 112.3 mm
Dimension L Fix	4.34 in 110.2 mm
Dimension M	2.59 in 65.8 mm
Dimension N	1.88 in 47.8 mm
Dimension RA	0.3 in 7.6 mm
Dimension SA	4.03 in 102.4 mm

Radial and Thrust Factors

C0 - Static Load	87200 lbf 388000 N
C - Dynamic Load (Basic)	79700 lbf 355000 N
e - Geometry Factor	0.23
Y1 - Geometry Factor	2.90
Y2 - Geometry Factor	4.31

Engineering Seal Speed

Oil Lubrication - M/N Seal	1400 rpm
-----------------------------------	----------

Oil Lubrication - T Seal	2400 rpm
---------------------------------	----------

Oil Lubrication - B/C/O Seal	1000 rpm
-------------------------------------	----------

Grease Lubrication - M/N Seal	1400 rpm
--------------------------------------	----------

Grease Lubrication - T Seal	2000 rpm
------------------------------------	----------

Grease Lubrication - B/C/O Seal	1000 rpm
--	----------

Engineering Bearing Attributes

Float	0.083 in 2.108 mm
--------------	----------------------

Shaft Tolerance	0.0030 in 0.076 mm
------------------------	-----------------------

Engineering Internal Radial Clearance

Eng Internal Radial Clearance - Min	0.0024
--	--------

Eng Internal Radial Clearance - Max	0.0039
--	--------

Pre Install Clearance Min	0.0024 in 0.060 mm
----------------------------------	-----------------------

Pre Install Clearance Max	0.0039 in 0.100 mm
----------------------------------	-----------------------

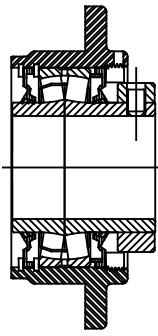
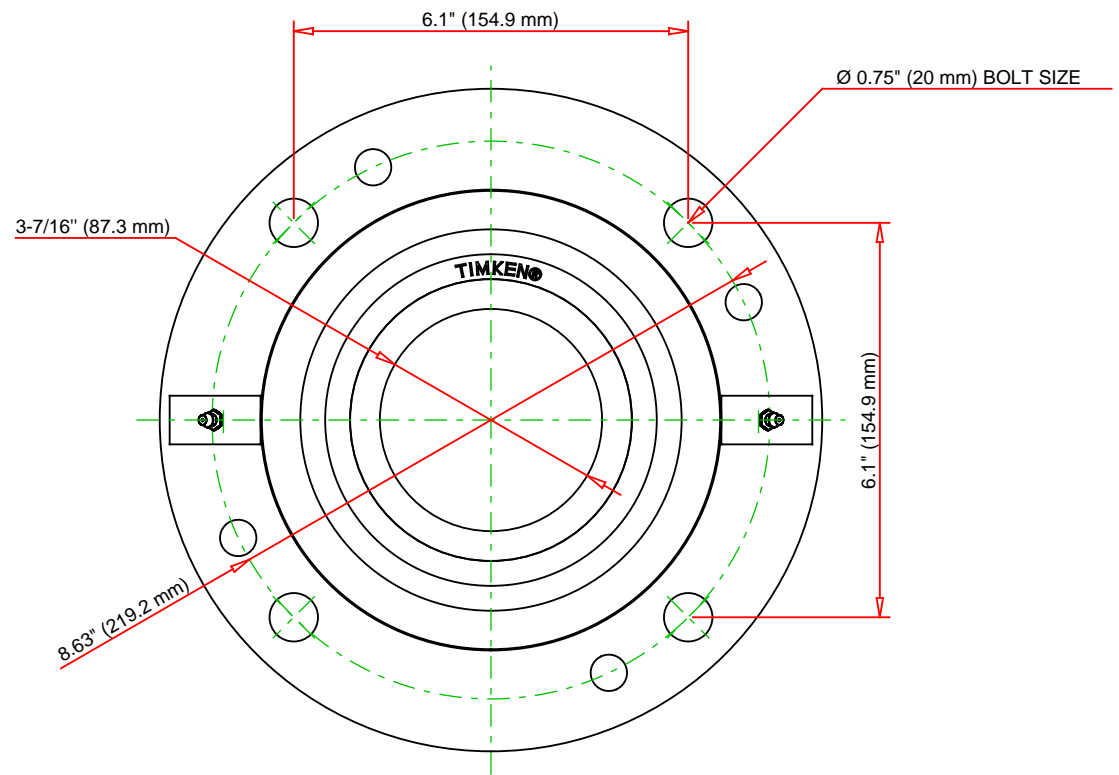
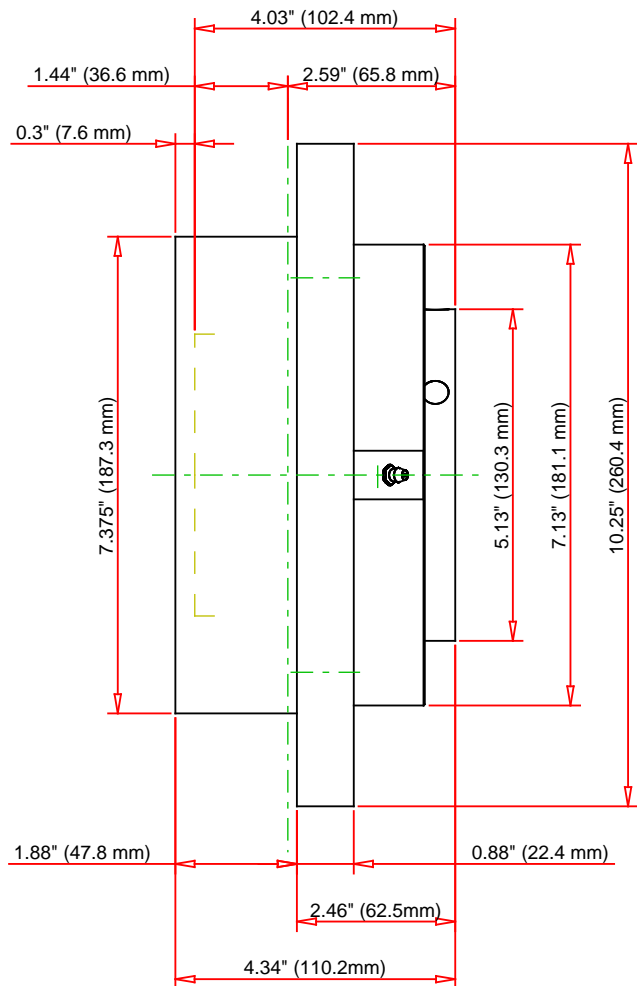

Note: Section View not to Scale

C - Dynamic Load	79700	lbf	355000	N
C0 - Static Load	87200	lbf	388000	N
Weight	32	lb	14.5	kg
Max. Speed T-Seals & Grease	2000	rpm		
Rad. Clearance - Max.	0.0039			

TIMKEN
THE TIMKEN COMPANY
NORTH CANTON, OHIO USA

QACW18A307S
Single Concentric Piloted Flange
Cartridge

Every reasonable effort has been made to ensure the accuracy of the information contained in this writing, but no liability is accepted for errors, omissions or for any other reason.

FOR DISCUSSION ONLY