



The Timken Company

4500 Mt Pleasant St. NW

N. Canton, OH 44720

Phone: (234) 262-3000

E-Mail: CustomerCAD@timken.com • **Web site:** www.timken.com

Part Number QVVP22V315S, Double V-Lock Two-Bolt Pillow Block

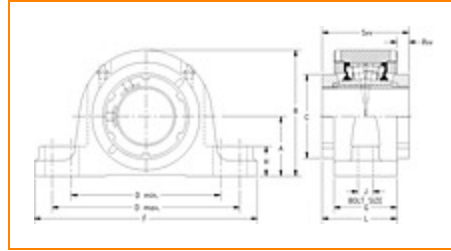

[Specifications](#) | [Dimensions](#) | [Radial and Thrust Factors](#) | [Engineering Seal Speed](#) | [Engineering Bearing Attributes](#) | [Engineering Internal Radial Clearance](#)

Specifications

Engineering Group Mounted Bearing

Bearing Number 22222

Shaft Size 3 15/16 in

Shaft Size Type Imperial

Full Timken Part Number

- QVVP22V315SB
- QVVP22V315SC
- QVVP22V315SEB
- QVVP22V315SEC
- QVVP22V315SEM
- QVVP22V315SEN
- QVVP22V315SEO
- QVVP22V315SET
- QVVP22V315SM
- QVVP22V315SMXYFG



QVVP22V315SN
 QVVP22V315SO
 QVVP22V315ST

Locking Style

Double V-Lock

Housing Construction

Two-Bolt Pillow Block

UPC Code

0883450170888
 0883450171076
 0883450171250
 0883450171632
 0883450171823
 0883450172011
 0883450202404
 0883450202787
 0883450214827
 0883450215206
 0883450227247
 0883450227629
 0883450463034

Dimensions
Dimension A

4.13 in
 104.9 mm

Dimension B

8.65 in
 219.7 mm

Dimension C

5.5 in
 139.7 mm

Dimension D Min

10.04 in
 255 mm

Dimension D Max

12.6 in
 320 mm

Dimension F

14.25 in
 362 mm

Dimension G

4.04 in
 102.6 mm

Dimension H	2 in 50.8 mm
Dimension J (Bolt Size)	1 in 24 mm
Dimension L	4.59 in 116.6 mm
Dimension RVV	0.55 in 14 mm
Dimension SVV	5.13 in 130.3 mm

Radial and Thrust Factors

C0 - Static Load	147000 lbf 653000 N
C - Dynamic Load (Basic)	125000 lbf 555000 N
e - Geometry Factor	0.25
Y1 - Geometry Factor	2.73
Y2 - Geometry Factor	4.06

Engineering Seal Speed

Oil Lubrication - M/N Seal	900 rpm
Oil Lubrication - T Seal	1700 rpm
Oil Lubrication - B/C/O Seal	600 rpm
Grease Lubrication - M/N Seal	900 rpm
Grease Lubrication - T Seal	1200 rpm
Grease Lubrication - B/C/O Seal	600 rpm

Engineering Bearing Attributes

Float	0.083 in 2.108 mm
Shaft Tolerance	0.0030 in 0.076 mm

Engineering Internal Radial Clearance

Eng Internal Radial Clearance - Min	0.0053
Eng Internal Radial Clearance - Max	0.0067
Pre Install Clearance Min	0.0053 in 0.135 mm
Pre Install Clearance Max	0.0067 in 0.170 mm

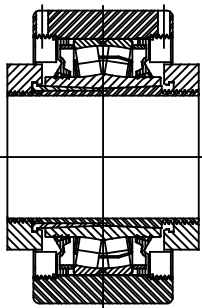
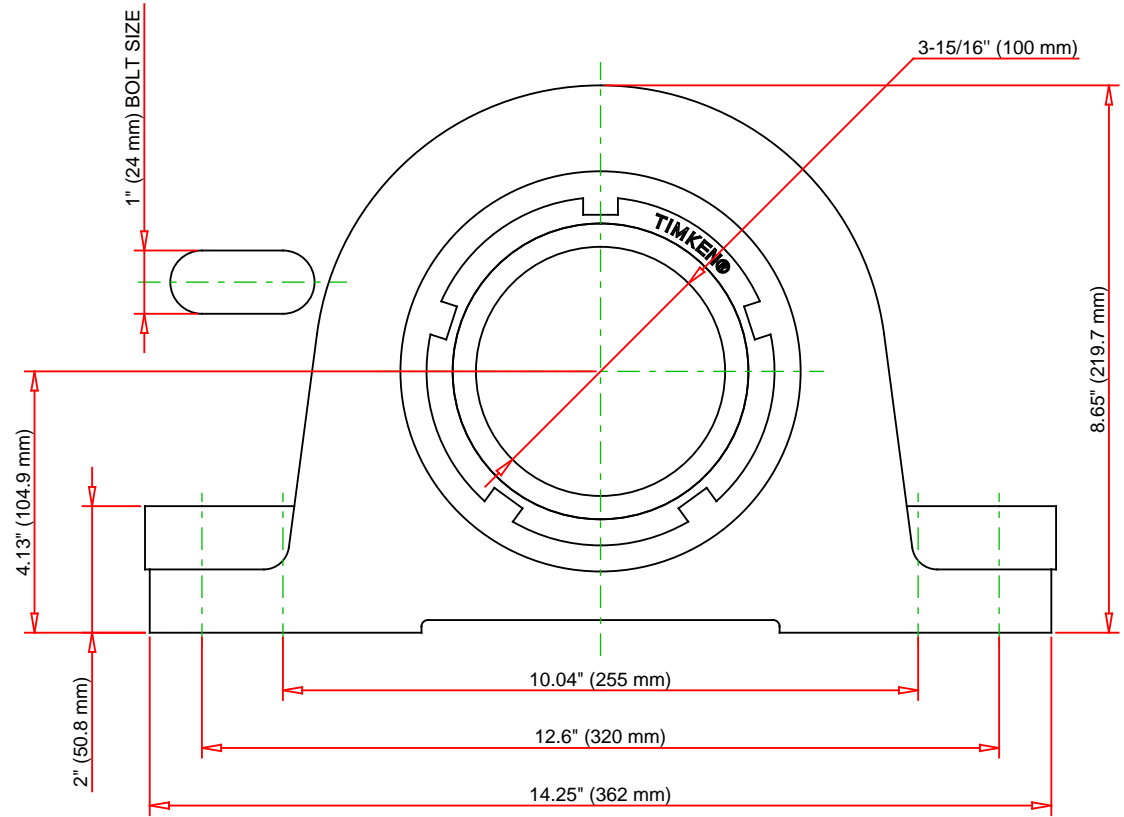
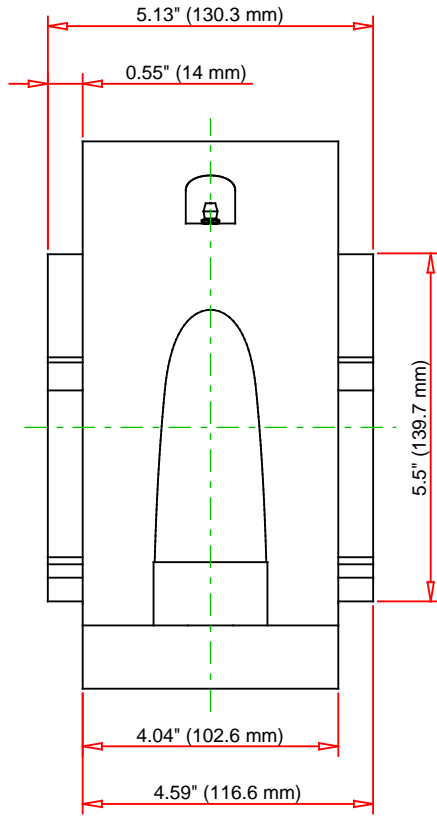

Note: Section View not to Scale

C - Dynamic Load	125000	lbf	555000	N
C0 - Static Load	147000	lbf	653000	N
Weight	59	lb	26.8	kg
Max. Speed T-Seals & Grease	1200	rpm		
Rad. Clearance - Max.	0.0067			

TIMKEN

THE TIMKEN COMPANY
NORTH CANTON, OHIO USA

QVVP22V315S
Double V-Lock Two-Bolt Pillow Block

Every reasonable effort has been made to ensure the accuracy of the information contained in this writing, but no liability is accepted for errors, omissions or for any other reason.

FOR DISCUSSION ONLY