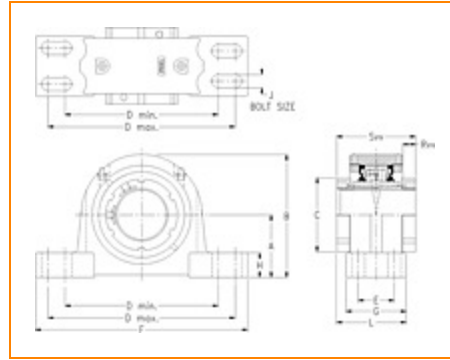
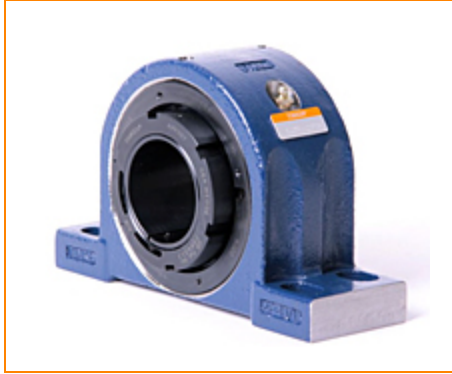

TIMKEN**The Timken Company**

4500 Mt Pleasant St. NW

N. Canton, OH 44720

Phone: (234) 262-3000**E-Mail:** CustomerCAD@timken.com • **Web site:** www.timken.com**Part Number QVVPH17V215S, Double V-Lock Four-Bolt Pillow Block**

[Specifications](#) | [Dimensions](#) | [Radial and Thrust Factors](#) | [Engineering Seal Speed](#) | [Engineering Bearing Attributes](#) | [Engineering Internal Radial Clearance](#)

Specifications

Engineering Group Mounted Bearing

Bearing Number 22217

Shaft Size 2 15/16 in

Shaft Size Type Imperial

Full Timken Part Number

- QVVPH17V215SB
- QVVPH17V215SC
- QVVPH17V215SEB
- QVVPH17V215SEC
- QVVPH17V215SEM
- QVVPH17V215SEN
- QVVPH17V215SEO
- QVVPH17V215SET
- QVVPH17V215SETNG
- QVVPH17V215SM
- QVVPH17V215SN
- QVVPH17V215SO
- QVVPH17V215ST



QVVPH17V215STNG

Locking Style Double V-Lock

Housing Construction Four-Bolt Pillow Block

UPC Code

0883450076227
 0883450076234
 0883450209137
 0883450209281
 0883450221566
 0883450221719
 0883450233996
 0883450234146
 0883450242738
 0883450242882
 0883450247696
 0883450247849
 0883450492553
 0883450492560

Dimensions**Dimension A**

3-3/4 in
 95.3 mm

Dimension B

7.2 in
 182.9 mm

Dimension C

4.19 in
 106.4 mm

Dimension D Min

9.44 in
 239.8 mm

Dimension D Max

11.31 in
 287.3 mm

Dimension E

2.13 in
 54.1 mm

Dimension F

12.63 in
 320.8 mm

Dimension G	3.63 in 92.2 mm
Dimension H	1.26 in 32 mm
Dimension J (Bolt Size)	0.625 in 16 mm
Dimension L	3.91 in 99.3 mm
Dimension RVV	0.59 in 15 mm
Dimension SVV	4.18 in 106.2 mm

Radial and Thrust Factors

C0 - Static Load	71900 lbf 320000 N
C - Dynamic Load (Basic)	66900 lbf 297000 N
e - Geometry Factor	0.22
Y1 - Geometry Factor	3.07
Y2 - Geometry Factor	4.57

Engineering Seal Speed

Oil Lubrication - M/N Seal	1400 rpm
Oil Lubrication - T Seal	2400 rpm
Oil Lubrication - B/C/O Seal	1100 rpm
Grease Lubrication - M/N Seal	1400 rpm

Grease Lubrication - T Seal	2000 rpm
------------------------------------	----------

Grease Lubrication - B/C/O Seal	1100 rpm
--	----------

Engineering Bearing Attributes

Float	0.083 in 2.108 mm
--------------	----------------------

Shaft Tolerance	0.0020 in 0.051 mm
------------------------	-----------------------

Engineering Internal Radial Clearance

Eng Internal Radial Clearance - Min	0.0037
--	--------

Eng Internal Radial Clearance - Max	0.0047
--	--------

Pre Install Clearance Min	0.0037 in 0.095 mm
----------------------------------	-----------------------

Pre Install Clearance Max	0.0047 in 0.120 mm
----------------------------------	-----------------------

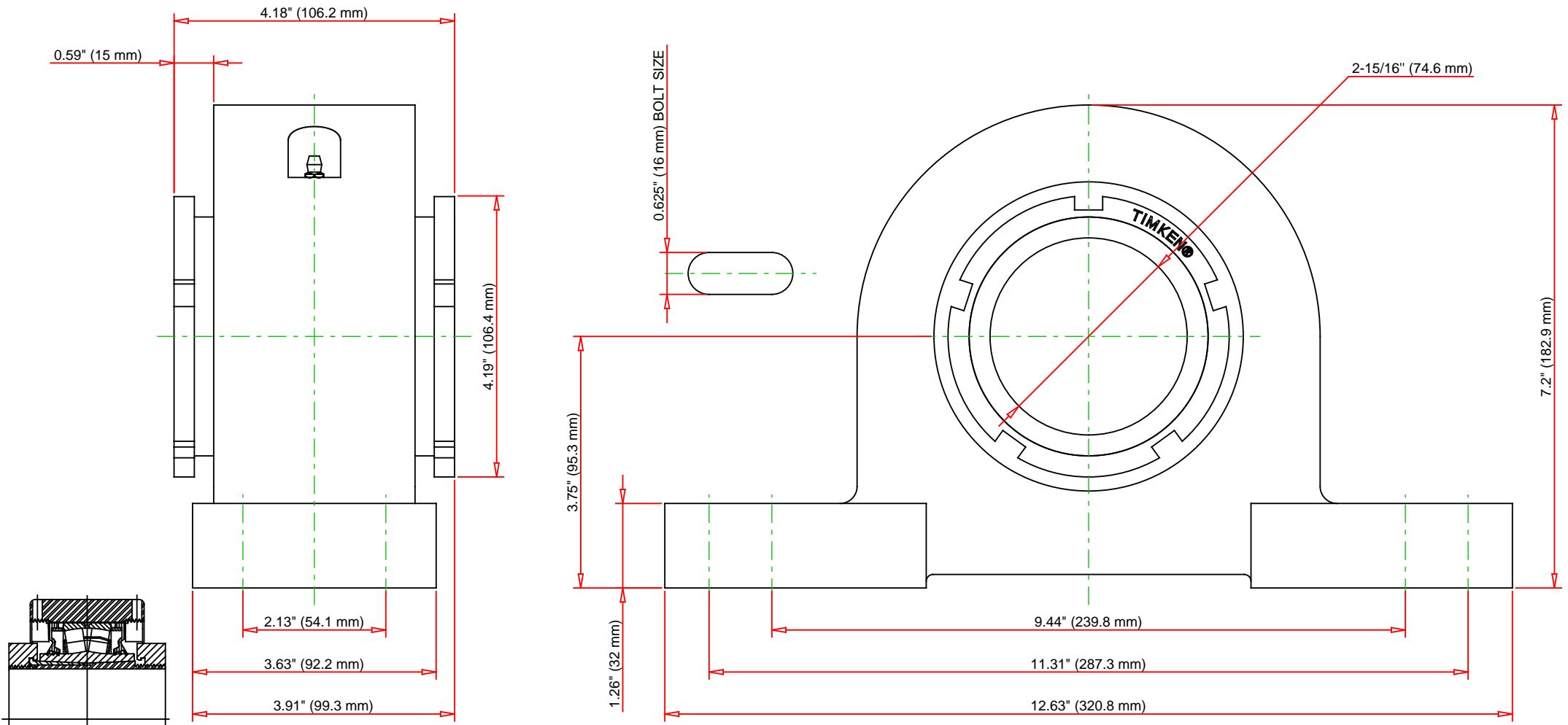

Note: Section View not to Scale

C - Dynamic Load	66900	lbf	297000	N
C0 - Static Load	71900	lbf	320000	N
Weight	37	lb	16.8	kg
Max. Speed T-Seals & Grease	2000	rpm		
Rad. Clearance - Max.	0.0047			

TIMKEN
 THE TIMKEN COMPANY
 NORTH CANTON, OHIO USA

QVVPH17V215S
 Double V-Lock Four-Bolt Pillow Block

Every reasonable effort has been made to ensure the accuracy of the information contained in this writing, but no liability is accepted for errors, omissions or for any other reason.

FOR DISCUSSION ONLY