



The Timken Company

4500 Mt Pleasant St. NW

N. Canton, OH 44720

Phone: (234) 262-3000

E-Mail: CustomerCAD@timken.com • **Web site:** www.timken.com

Part Number QVVPA20V308S, Double V-Lock Two-Bolt Pillow Block

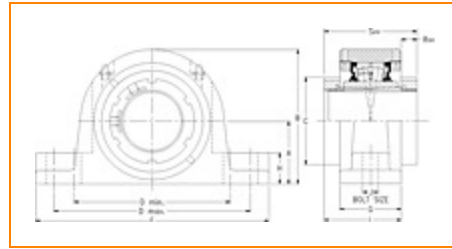

[Specifications](#) | [Dimensions](#) | [Radial and Thrust Factors](#) | [Engineering Seal Speed](#) | [Engineering Bearing Attributes](#) | [Engineering Internal Radial Clearance](#)

Specifications

Engineering Group Mounted Bearing

Bearing Number 22220

Shaft Size 3 1/2 in

Shaft Size Type Imperial

Full Timken Part Number

- QVVPA20V308SB
- QVVPA20V308SC
- QVVPA20V308SEB
- QVVPA20V308SEC
- QVVPA20V308SEM
- QVVPA20V308SEN
- QVVPA20V308SEO
- QVVPA20V308SET
- QVVPA20V308SM
- QVVPA20V308SN
- QVVPA20V308SO
- QVVPA20V308ST



Locking Style	Double V-Lock
Housing Construction	Two-Bolt Pillow Block
UPC Code	0883450073219 0883450073240 0883450208574 0883450208727 0883450221009 0883450221153 0883450233439 0883450233583 0883450242172 0883450242325 0883450247139 0883450247283

Dimensions

Dimension A	4-1/2 in 114.3 mm
Dimension B	8.63 in 219.2 mm
Dimension C	4.9 in 124.5 mm
Dimension D Min	10.88 in 276.4 mm
Dimension D Max	12.88 in 327.2 mm
Dimension F	14.5 in 368.3 mm
Dimension G	3.42 in 86.9 mm
Dimension H	1.63 in 41.4 mm

Dimension J (Bolt Size)	0.875 in 24 mm
Dimension L	4.03 in 102.4 mm
Dimension RVV	0.61 in 15.5 mm
Dimension SVV	4.63 in 117.6 mm

Radial and Thrust Factors

C0 - Static Load	113000 lbf 502000 N
C - Dynamic Load (Basic)	97700 lbf 435000 N
e - Geometry Factor	0.24
Y1 - Geometry Factor	2.85
Y2 - Geometry Factor	4.24

Engineering Seal Speed

Oil Lubrication - M/N Seal	1200 rpm
Oil Lubrication - T Seal	2000 rpm
Oil Lubrication - B/C/O Seal	900 rpm
Grease Lubrication - M/N Seal	1200 rpm
Grease Lubrication - T Seal	1600 rpm
Grease Lubrication - B/C/O Seal	900 rpm

Engineering Bearing Attributes

Float	0.083 in 2.108 mm
--------------	----------------------

Shaft Tolerance	0.0030 in 0.076 mm
------------------------	-----------------------

Engineering Internal Radial Clearance

Eng Internal Radial Clearance - Min	0.0043
--	--------

Eng Internal Radial Clearance - Max	0.0055
--	--------

Pre Install Clearance Min	0.0043 in 0.110 mm
----------------------------------	-----------------------

Pre Install Clearance Max	0.0055 in 0.140 mm
----------------------------------	-----------------------

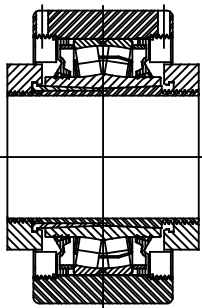
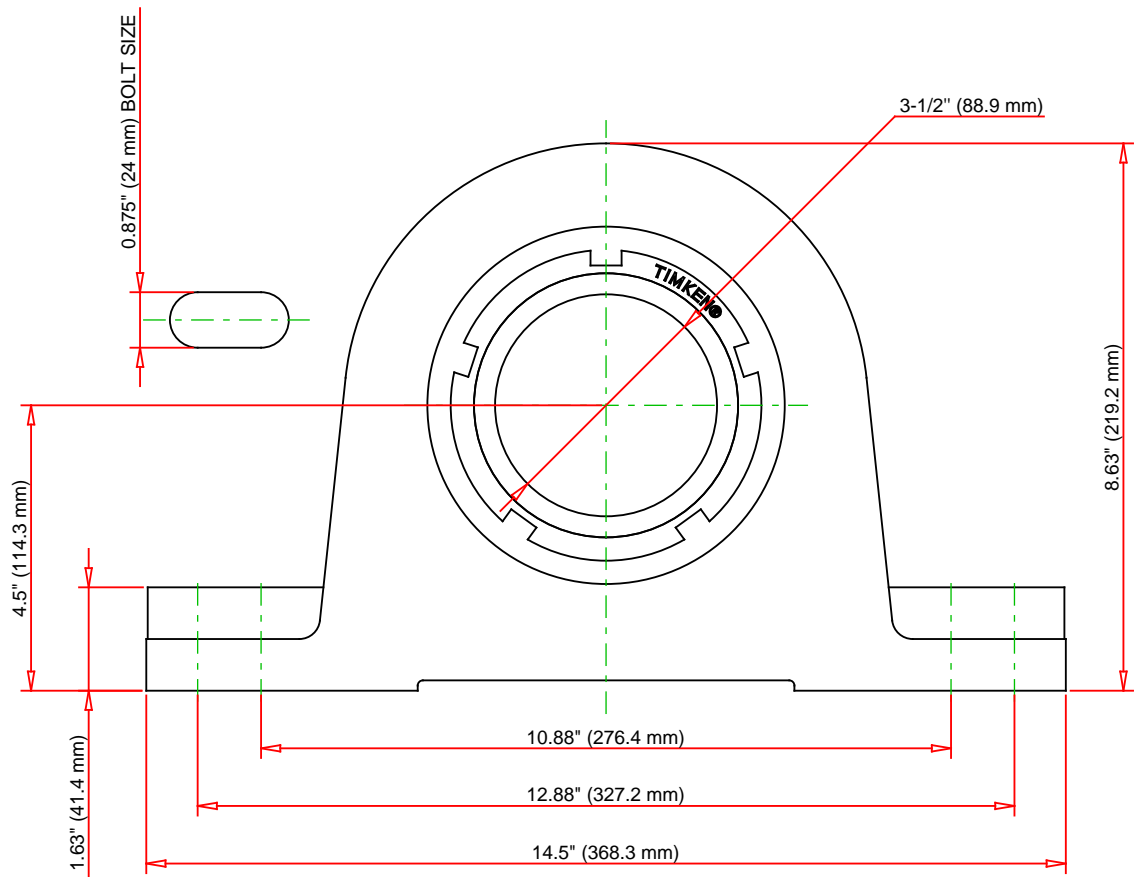
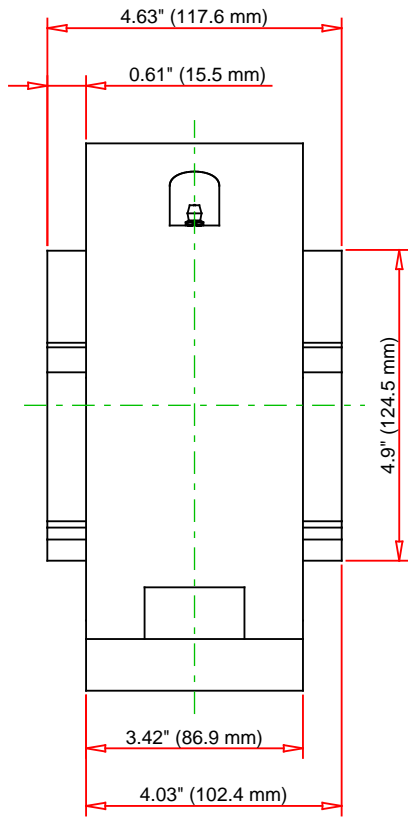

Note: Section View not to Scale

C - Dynamic Load	97700	lbf	435000	N
C0 - Static Load	113000	lbf	502000	N
Weight	65	lb	29.5	kg
Max. Speed T-Seals & Grease	1600	rpm		
Rad. Clearance - Max.	0.0055			

TIMKEN

THE TIMKEN COMPANY
NORTH CANTON, OHIO USA

QVVPA20V308S
Double V-Lock Two-Bolt Pillow Block

Every reasonable effort has been made to ensure the accuracy of the information contained in this writing, but no liability is accepted for errors, omissions or for any other reason.

FOR DISCUSSION ONLY