

**The Timken Company**

4500 Mt Pleasant St. NW

N. Canton, OH 44720

**Phone:** (234) 262-3000

**E-Mail:** [CustomerCAD@timken.com](mailto:CustomerCAD@timken.com) • **Web site:** [www.timken.com](http://www.timken.com)

## Part Number QMP13J208S, Eccentric Two-Bolt Pillow Block

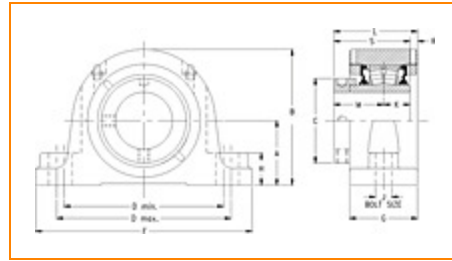

[Specifications](#) | [Dimensions](#) | [Radial and Thrust Factors](#) | [Engineering Seal Speed](#) | [Engineering Bearing Attributes](#) | [Engineering Internal Radial Clearance](#)

## Specifications

**Engineering Group** Mounted Bearing

**Bearing Number** 22213

**Shaft Size** 2 1/2 in

**Shaft Size Type** Imperial

**Full Timken Part Number**

- QMP13J208SB
- QMP13J208SC
- QMP13J208SEB
- QMP13J208SEC
- QMP13J208SEM
- QMP13J208SEN
- QMP13J208SEO
- QMP13J208SET
- QMP13J208SM
- QMP13J208SN
- QMP13J208SO
- QMP13J208ST



QMP13J208STSLA

**Locking Style**

Eccentric

**Housing Construction**

Two-Bolt Pillow Block

**UPC Code**

0883450081429  
0883450081436  
0883450081450  
0883450081467  
0883450081474  
0883450081481  
0883450081498  
0883450081504  
0883450154406  
0883450154741  
0883450249379  
0883450249713  
0883450472746

**Dimensions****Dimension A**

2.75 in  
69.9 mm

**Dimension B**

5.8 in  
147.3 mm

**Dimension C**

3.62 in  
91.9 mm

**Dimension D Min**

6.88 in  
174.8 mm

**Dimension D Max**

8.63 in  
219.2 mm

**Dimension F**

10 1/4 in  
260.4 mm

**Dimension G**

2.9 in  
73.7 mm

<b>Dimension H</b>	1.38 in 35.1 mm
<b>Dimension J (Bolt Size)</b>	0.625 in 16 mm
<b>Dimension K</b>	1.24 in 31.5 mm
<b>Dimension L</b>	3.59 in 91.2 mm
<b>Dimension M</b>	2.13 in 54.1 mm
<b>Dimension R</b>	0.21 in 5.3 mm
<b>Dimension S</b>	3.37 in 85.6 mm

### Radial and Thrust Factors

<b>C0 - Static Load</b>	48600 lbf 216000 N
<b>C - Dynamic Load (Basic)</b>	46400 lbf 206000 N
<b>e - Geometry Factor</b>	0.24
<b>Y1 - Geometry Factor</b>	2.79
<b>Y2 - Geometry Factor</b>	4.15

### Engineering Seal Speed

<b>Oil Lubrication - M/N Seal</b>	1800 rpm
<b>Oil Lubrication - T Seal</b>	3200 rpm
<b>Oil Lubrication - B/C/O Seal</b>	1500 rpm

<b>Grease Lubrication - M/N Seal</b>	1800 rpm
--------------------------------------	----------

<b>Grease Lubrication - T Seal</b>	2800 rpm
------------------------------------	----------

<b>Grease Lubrication - B/C/O Seal</b>	1500 rpm
--	----------

### Engineering Bearing Attributes

<b>Float</b>	0.083 in 2.108 mm
--------------	----------------------

<b>Shaft Tolerance</b>	0.0015 in 0.038 mm
------------------------	-----------------------

### Engineering Internal Radial Clearance

<b>Eng Internal Radial Clearance - Min</b>	0.0016
--	--------

<b>Eng Internal Radial Clearance - Max</b>	0.0026
--	--------

<b>Pre Install Clearance Min</b>	0.0016 in 0.040 mm
----------------------------------	-----------------------

<b>Pre Install Clearance Max</b>	0.0026 in 0.065 mm
----------------------------------	-----------------------

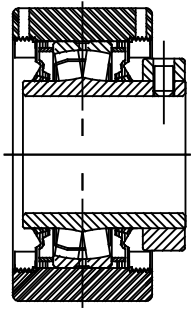
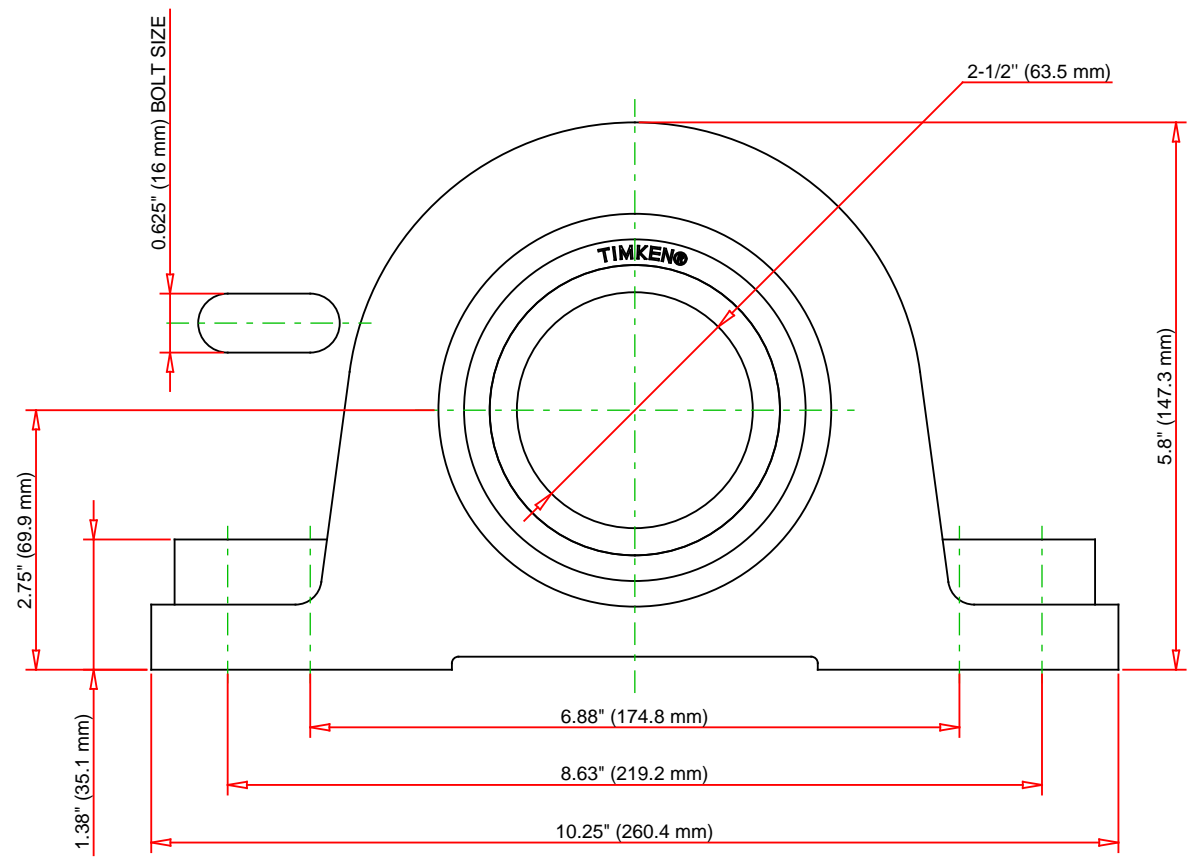
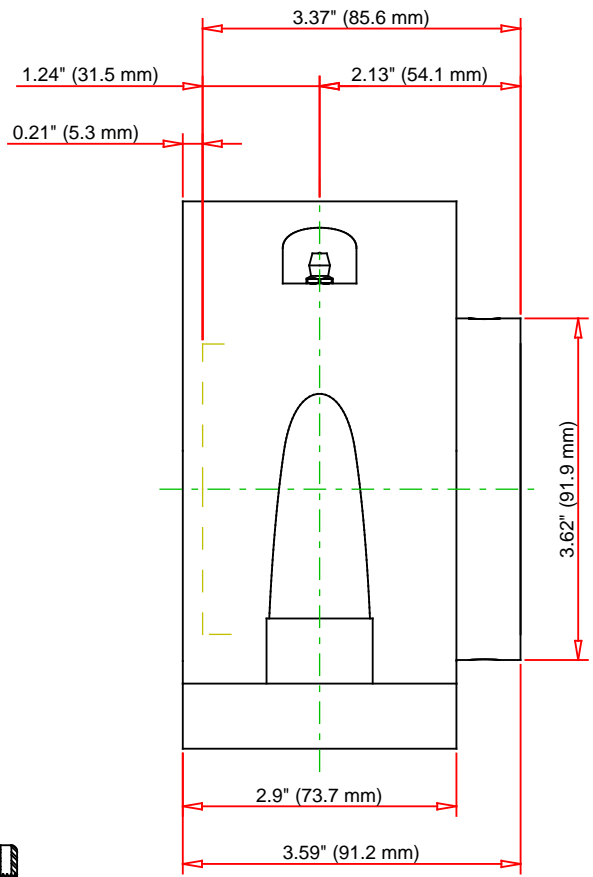

Note: Section View not to Scale

C - Dynamic Load	46400	lbf	206000	N
C0 - Static Load	48600	lbf	216000	N
Weight	22	lb	10	kg
Max. Speed T-Seals & Grease	2800	rpm		
Rad. Clearance - Max.	0.0026			

**TIMKEN**  
 THE TIMKEN COMPANY  
 NORTH CANTON, OHIO USA

**QMP13J208S**  
 Eccentric Two-Bolt Pillow Block

Every reasonable effort has been made to ensure the accuracy of the information contained in this writing, but no liability is accepted for errors, omissions or for any other reason.

**FOR DISCUSSION ONLY**