

The Timken Company

4500 Mt Pleasant St. NW

N. Canton, OH 44720

Phone: (234) 262-3000

E-Mail: CustomerCAD@timken.com • **Web site:** www.timken.com

Part Number QMP15J211S, Eccentric Two-Bolt Pillow Block

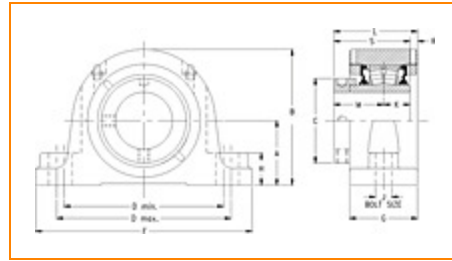

[Specifications](#) | [Dimensions](#) | [Radial and Thrust Factors](#) | [Engineering Seal Speed](#) | [Engineering Bearing Attributes](#) | [Engineering Internal Radial Clearance](#)

Specifications

Engineering Group Mounted Bearing

Bearing Number 22215

Shaft Size 2 11/16 in

Shaft Size Type Imperial

Full Timken Part Number
 QMP15J211SB
 QMP15J211SC
 QMP15J211SEB
 QMP15J211SEC
 QMP15J211SEM
 QMP15J211SEN
 QMP15J211SEO
 QMP15J211SET
 QMP15J211SETHT
 QMP15J211SM
 QMP15J211SMNP
 QMP15J211SN



QMP15J211SO
 QMP15J211ST
 QMP15J211STHT

Locking Style

Eccentric

Housing Construction

Two-Bolt Pillow Block

UPC Code

0883450081726
 0883450081733
 0883450081757
 0883450081764
 0883450081771
 0883450081788
 0883450081795
 0883450081801
 0883450154420
 0883450154765
 0883450249393
 0883450249737
 0883450457743
 0883450462631
 0883450462648

Dimensions**Dimension A**

3.13 in
 79.5 mm

Dimension B

6.47 in
 164.3 mm

Dimension C

4.01 in
 101.9 mm

Dimension D Min

7.88 in
 200.2 mm

Dimension D Max

9.63 in
 244.6 mm

Dimension F

11.6 in
 294.6 mm

Dimension G	3 in 76.2 mm
Dimension H	1.38 in 35.1 mm
Dimension J (Bolt Size)	0.75 in 20 mm
Dimension K	1-1/4 in 31.8 mm
Dimension L	3.87 in 98.3 mm
Dimension M	2.37 in 60.2 mm
Dimension R	0.25 in 6.4 mm
Dimension S	3.62 in 91.9 mm

Radial and Thrust Factors

C0 - Static Load	54100 lbf 240000 N
C - Dynamic Load (Basic)	49900 lbf 222000 N
e - Geometry Factor	0.22
Y1 - Geometry Factor	3.14
Y2 - Geometry Factor	4.67

Engineering Seal Speed

Oil Lubrication - M/N Seal	1600 rpm
-----------------------------------	----------

Oil Lubrication - T Seal	2900 rpm
---------------------------------	----------

Oil Lubrication - B/C/O Seal	1300 rpm
-------------------------------------	----------

Grease Lubrication - M/N Seal	1600 rpm
--------------------------------------	----------

Grease Lubrication - T Seal	2400 rpm
------------------------------------	----------

Grease Lubrication - B/C/O Seal	1300 rpm
--	----------

Engineering Bearing Attributes

Float	0.083 in 2.108 mm
--------------	----------------------

Shaft Tolerance	0.0020 in 0.051 mm
------------------------	-----------------------

Engineering Internal Radial Clearance

Eng Internal Radial Clearance - Min	0.0020
--	--------

Eng Internal Radial Clearance - Max	0.0031
--	--------

Pre Install Clearance Min	0.0020 in 0.050 mm
----------------------------------	-----------------------

Pre Install Clearance Max	0.0031 in 0.080 mm
----------------------------------	-----------------------

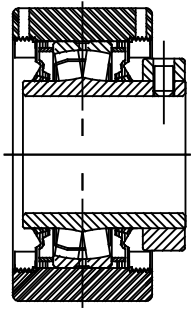
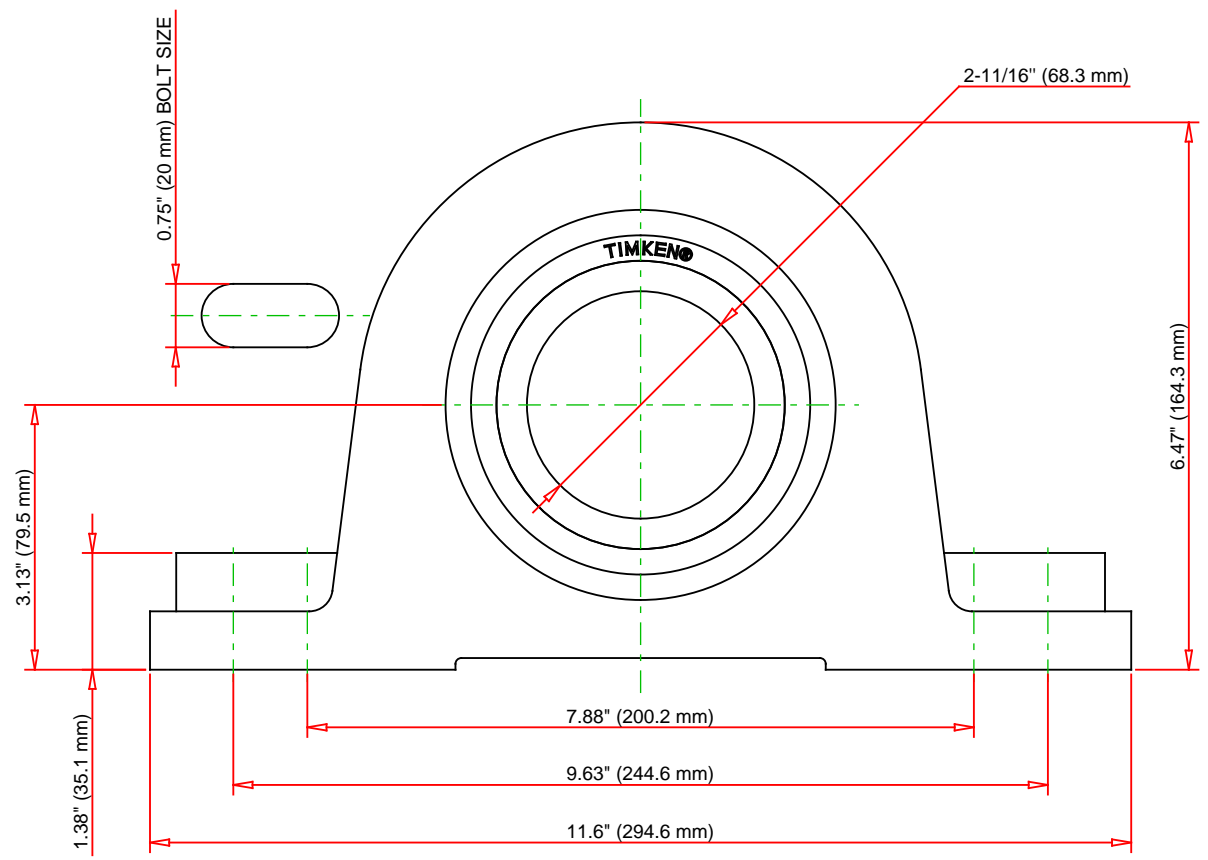
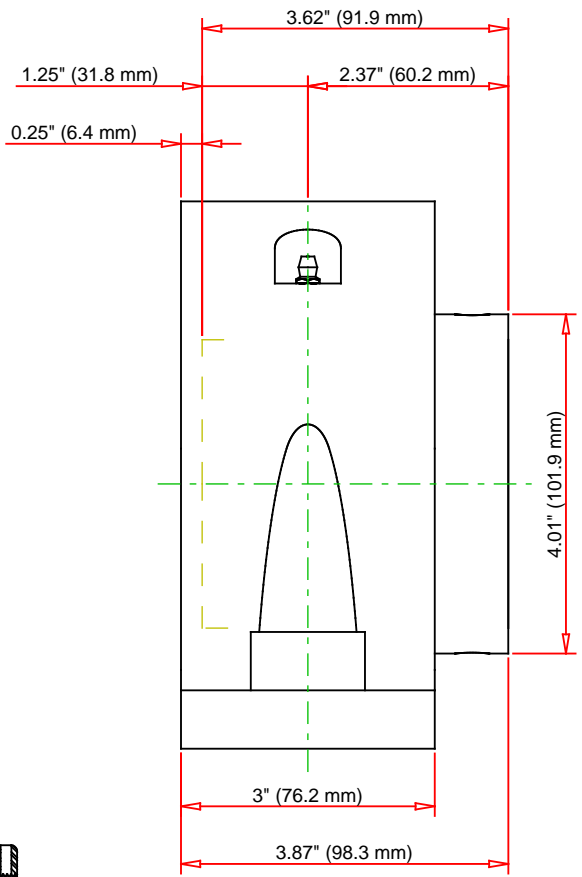

Note: Section View not to Scale

C - Dynamic Load	49900	lbf	222000	N
C0 - Static Load	54100	lbf	240000	N
Weight	28	lb	12.7	kg
Max. Speed T-Seals & Grease	2400	rpm		
Rad. Clearance - Max.	0.0031			

TIMKEN
 THE TIMKEN COMPANY
 NORTH CANTON, OHIO USA

QMP15J211S
 Eccentric Two-Bolt Pillow Block

Every reasonable effort has been made to ensure the accuracy of the information contained in this writing, but no liability is accepted for errors, omissions or for any other reason.

FOR DISCUSSION ONLY