



**The Timken Company**

4500 Mt Pleasant St. NW

N. Canton, OH 44720

**Phone:** (234) 262-3000

**E-Mail:** [CustomerCAD@timken.com](mailto:CustomerCAD@timken.com) • **Web site:** [www.timken.com](http://www.timken.com)

## Part Number QMC11J203S, Eccentric Piloted Flange Cartridge

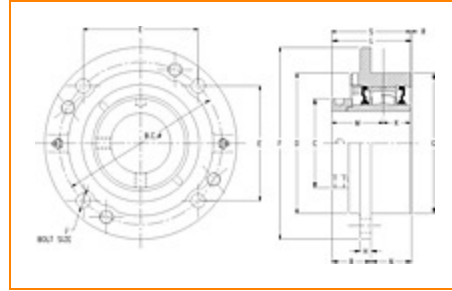

[Specifications](#) | [Dimensions](#) | [Radial and Thrust Factors](#) | [Engineering Seal Speed](#) | [Engineering Bearing Attributes](#) | [Engineering Internal Radial Clearance](#)

### Specifications

**Engineering Group** Mounted Bearing

**Bearing Number** 22211

**Shaft Size** 2 3/16 in

**Shaft Size Type** Imperial

**Full Timken Part Number**

- QMC11J203SB
- QMC11J203SC
- QMC11J203SEB
- QMC11J203SEC
- QMC11J203SEM
- QMC11J203SEN
- QMC11J203SEO
- QMC11J203SET
- QMC11J203SM
- QMC11J203SMYDR
- QMC11J203SN
- QMC11J203SO
- QMC11J203ST



QMC11J203STREV

**Locking Style**

Eccentric

**Housing Construction**

Piloted Flange Cartridge

**UPC Code**

0883450058926  
 0883450058933  
 0883450058957  
 0883450058964  
 0883450058971  
 0883450058988  
 0883450058995  
 0883450059008  
 0883450165617  
 0883450166034  
 0883450257855  
 0883450258234  
 0883450461962  
 0883450492409

**Dimensions****Dimension BC**

6 in  
 152.4 mm

**Dimension B Exp**

2.22 in  
 56.4 mm

**Dimension B Fix**

2.14 in  
 54.4 mm

**Dimension C**

2.99 in  
 75.9 mm

**Dimension D**

5 in  
 127 mm

**Dimension E**

4.24 in  
 107.7 mm

**Dimension F**

7.3 in  
 185.4 mm

<b>Dimension G</b>	5 in 127 mm
<b>Dimension H</b>	0.58 in 14.7 mm
<b>Dimension J (Bolt Size)</b>	0.5 in 12 mm
<b>Dimension K</b>	1.13 in 28.7 mm
<b>Dimension L Exp</b>	3.35 in 85.1 mm
<b>Dimension L Fix</b>	3.27 in 83.1 mm
<b>Dimension M</b>	1.99 in 50.5 mm
<b>Dimension N</b>	1.13 in 28.7 mm
<b>Dimension R</b>	0.14 in 3.6 mm
<b>Dimension S</b>	3.12 in 79.2 mm

## Radial and Thrust Factors

<b>C0 - Static Load</b>	31900 lbf 142000 N
<b>C - Dynamic Load (Basic)</b>	31400 lbf 140000 N
<b>e - Geometry Factor</b>	0.23
<b>Y1 - Geometry Factor</b>	2.95
<b>Y2 - Geometry Factor</b>	4.40

## Engineering Seal Speed

<b>Oil Lubrication - M/N Seal</b>	2200 rpm
<b>Oil Lubrication - T Seal</b>	3800 rpm
<b>Oil Lubrication - B/C/O Seal</b>	1600 rpm
<b>Grease Lubrication - M/N Seal</b>	2200 rpm
<b>Grease Lubrication - T Seal</b>	3200 rpm
<b>Grease Lubrication - B/C/O Seal</b>	1600 rpm

## Engineering Bearing Attributes

<b>Float</b>	0.050 in 1.270 mm
<b>Shaft Tolerance</b>	0.0015 in 0.038 mm

## Engineering Internal Radial Clearance

<b>Eng Internal Radial Clearance - Min</b>	0.0016
<b>Eng Internal Radial Clearance - Max</b>	0.0026
<b>Pre Install Clearance Min</b>	0.0016 in 0.040 mm
<b>Pre Install Clearance Max</b>	0.0026 in 0.065 mm

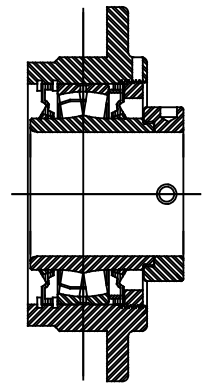
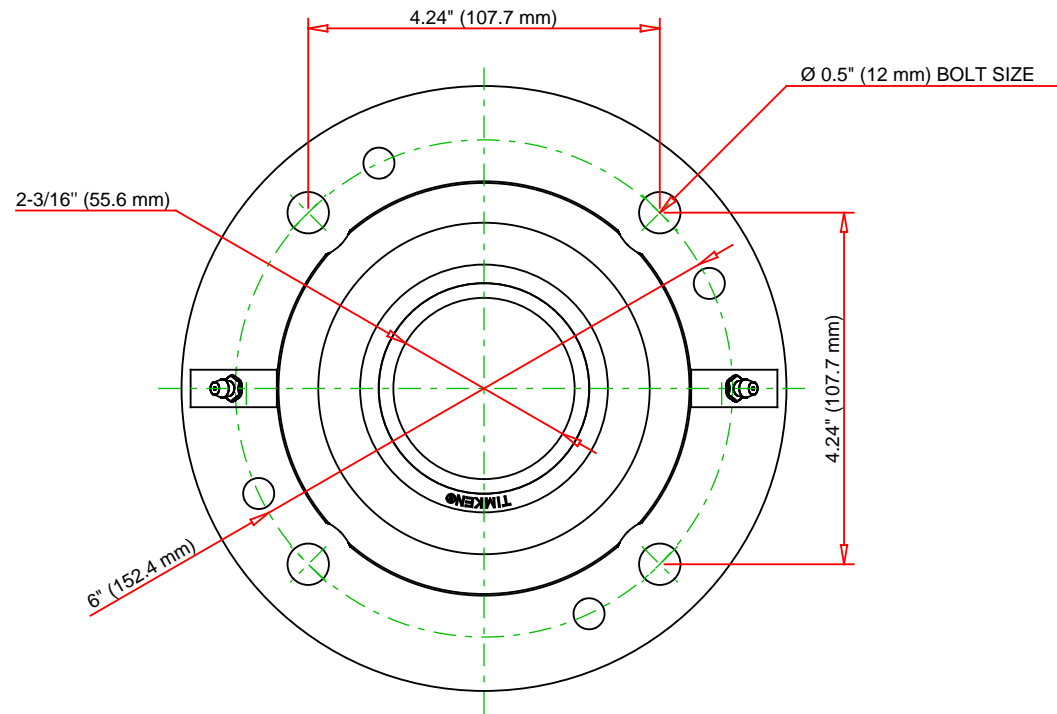
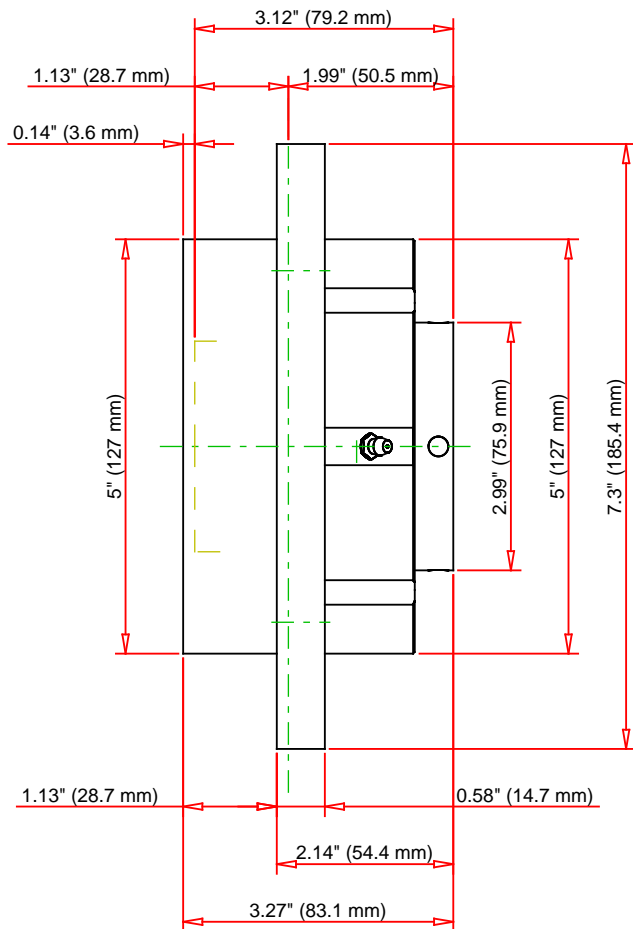

Note: Section View not to Scale

C - Dynamic Load	31400	lbf	140000	N
C0 - Static Load	31900	lbf	142000	N
Weight	13	lb	5.9	kg
Max. Speed T-Seals & Grease	3200	rpm		
Rad. Clearance - Max.	0.0026			

**TIMKEN**

THE TIMKEN COMPANY  
NORTH CANTON, OHIO USA

**QMC11J203S**  
Eccentric Piloted Flange Cartridge

Every reasonable effort has been made to ensure the accuracy of the information contained in this writing, but no liability is accepted for errors, omissions or for any other reason.

**FOR DISCUSSION ONLY**