



The Timken Company

4500 Mt Pleasant St. NW

N. Canton, OH 44720

Phone: (234) 262-3000

E-Mail: CustomerCAD@timken.com • **Web site:** www.timken.com

Part Number QMF15J211S, Eccentric Four Bolt Square Flange Block

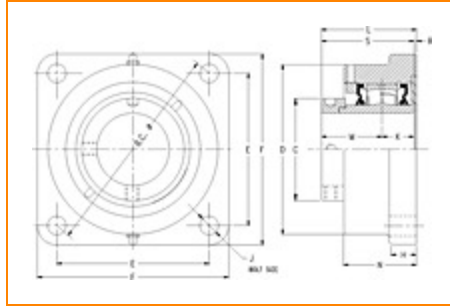

[Specifications](#) | [Dimensions](#) | [Radial and Thrust Factors](#) | [Engineering Seal Speed](#) | [Engineering Bearing Attributes](#) | [Engineering Internal Radial Clearance](#)

Specifications

Engineering Group	Mounted Bearing
Bearing Number	22215
Shaft Size	2 11/16 in
Shaft Size Type	Imperial
Full Timken Part Number	QMF15J211SB QMF15J211SC QMF15J211SEB QMF15J211SEC QMF15J211SEM QMF15J211SEN QMF15J211SEO QMF15J211SET QMF15J211SM QMF15J211SN QMF15J211SO



QMF15J211ST
QMF15J211STREV

Locking Style

Eccentric

Housing Construction

Four-Bolt Square Flange

UPC Code

0883450067027
0883450067034
0883450067058
0883450067065
0883450067072
0883450067089
0883450067096
0883450067102
0883450161633
0883450162319
0883450254397
0883450254878
0883450964418

Dimensions**Dimension BC**

8.49 in
215.6 mm

Dimension C

4.01 in
101.9 mm

Dimension D

6.65 in
168.9 mm

Dimension E

6 in
152.4 mm

Dimension F

7.44 in
189 mm

Dimension H

1.06 in
26.9 mm

Dimension J (Bolt Size)

0.75 in
20 mm

Dimension K	1.25 in 31.8 mm
Dimension L Exp	3.86 in 98 mm
Dimension L Fix	3.78 in 96 mm
Dimension M	2.37 in 60.2 mm
Dimension N	3 in 76.2 mm
Dimension R	0.16 in 4.1 mm
Dimension S	3.62 in 91.9 mm

Radial and Thrust Factors

C0 - Static Load	54100 lbf 240000 N
C - Dynamic Load (Basic)	49900 lbf 222000 N
e - Geometry Factor	0.22
Y1 - Geometry Factor	3.01
Y2 - Geometry Factor	4.48

Engineering Seal Speed

Oil Lubrication - M/N Seal	1600 rpm
Oil Lubrication - T Seal	2900 rpm
Oil Lubrication - B/C/O Seal	1300 rpm

Grease Lubrication - M/N Seal	1600 rpm
--------------------------------------	----------

Grease Lubrication - T Seal	2400 rpm
------------------------------------	----------

Grease Lubrication - B/C/O Seal	1300 rpm
--	----------

Engineering Bearing Attributes

Float	0.083 in 2.108 mm
--------------	----------------------

Shaft Tolerance	0.0020 in 0.051 mm
------------------------	-----------------------

Engineering Internal Radial Clearance

Eng Internal Radial Clearance - Min	0.002
--	-------

Eng Internal Radial Clearance - Max	0.0031
--	--------

Pre Install Clearance Min	0.0020 in 0.050 mm
----------------------------------	-----------------------

Pre Install Clearance Max	0.0031 in 0.080 mm
----------------------------------	-----------------------

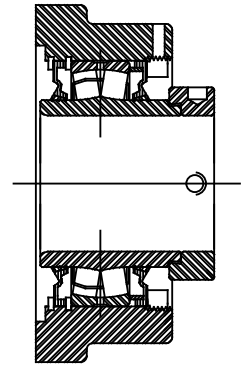
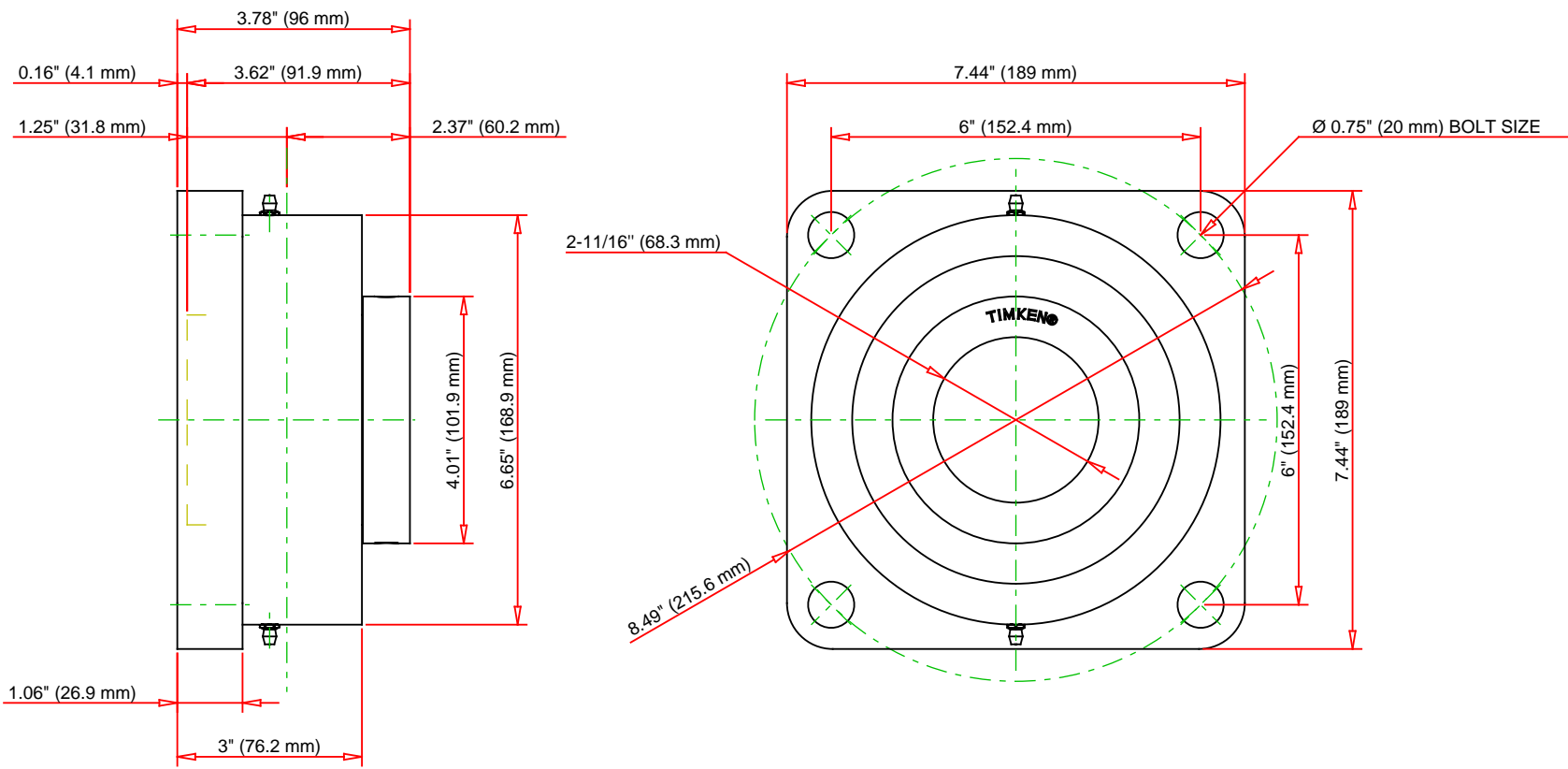

Note: Section View not to Scale

C - Dynamic Load	49900	lbf	222000	N
C0 - Static Load	54100	lbf	240000	N
Weight	23	lb	10.4	kg
Max. Speed T-Seals & Grease	2400	rpm		
Rad. Clearance - Max.	0.0031			

TIMKEN
THE TIMKEN COMPANY
NORTH CANTON, OHIO USA

QMF15J211S
Eccentric Four Bolt Square Flange
Block

Every reasonable effort has been made to ensure the accuracy of the information contained in this writing, but no liability is accepted for errors, omissions or for any other reason.

FOR DISCUSSION ONLY