



**The Timken Company**

4500 Mt Pleasant St. NW

N. Canton, OH 44720

**Phone:** (234) 262-3000

**E-Mail:** [CustomerCAD@timken.com](mailto:CustomerCAD@timken.com) • **Web site:** [www.timken.com](http://www.timken.com)

## Part Number QVVPL11V200S, Double V-Lock Two-Bolt Pillow Block

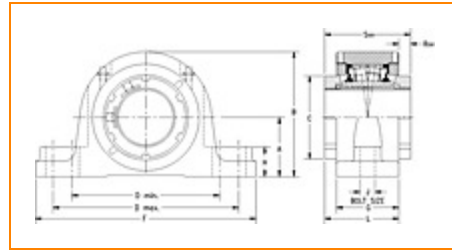

[Specifications](#) | [Dimensions](#) | [Radial and Thrust Factors](#) | [Engineering Seal Speed](#) | [Engineering Bearing Attributes](#) | [Engineering Internal Radial Clearance](#)

### Specifications

**Engineering Group** Mounted Bearing

**Bearing Number** 22211

**Shaft Size** 2 in

**Shaft Size Type** Imperial

**Full Timken Part Number**

- QVVPL11V200SB
- QVVPL11V200SC
- QVVPL11V200SEB
- QVVPL11V200SEC
- QVVPL11V200SEM
- QVVPL11V200SEN
- QVVPL11V200SEO
- QVVPL11V200SET
- QVVPL11V200SM
- QVVPL11V200SN



QVWPL11V200SO  
 QVWPL11V200ST  
 QVWPL11V200STHT

<b>Locking Style</b>	Double V-Lock
<b>Housing Construction</b>	Two-Bolt Pillow Block
<b>UPC Code</b>	0883450096812 0883450097246 0883450107372 0883450107501 0883450114240 0883450114387 0883450128292 0883450128766 0883450137966 0883450138055 0883450357487 0883450357739 0883450463249

## Dimensions

<b>Dimension A</b>	2.25 in 57.2 mm
<b>Dimension B</b>	4.81 in 122.2 mm
<b>Dimension C</b>	2.99 in 75.9 mm
<b>Dimension D Min</b>	5.93 in 150.6 mm
<b>Dimension D Max</b>	6.36 in 161.5 mm
<b>Dimension F</b>	8.38 in 212.9 mm
<b>Dimension G</b>	2.44 in 62 mm

<b>Dimension H</b>	1-1/4 in 31.8 mm
<b>Dimension J (Bolt Size)</b>	0.625 in 16 mm
<b>Dimension L</b>	3.23 in 82 mm
<b>Dimension RVV</b>	0.79 in 20.1 mm
<b>Dimension SVV</b>	4.02 in 102.1 mm

### Radial and Thrust Factors

<b>C0 - Static Load</b>	31900 lbf 142000 N
<b>C - Dynamic Load (Basic)</b>	31400 lbf 140000 N
<b>e - Geometry Factor</b>	0.23
<b>Y1 - Geometry Factor</b>	2.95
<b>Y2 - Geometry Factor</b>	4.40

### Engineering Seal Speed

<b>Oil Lubrication - M/N Seal</b>	2200 rpm
<b>Oil Lubrication - T Seal</b>	3800 rpm
<b>Oil Lubrication - B/C/O Seal</b>	1800 rpm
<b>Grease Lubrication - M/N Seal</b>	2200 rpm
<b>Grease Lubrication - T Seal</b>	3200 rpm
<b>Grease Lubrication - B/C/O Seal</b>	1600 rpm

## Engineering Bearing Attributes

<b>Float</b>	0.050 in 1.270 mm
<b>Shaft Tolerance</b>	0.0015 in 0.038 mm

## Engineering Internal Radial Clearance

<b>Eng Internal Radial Clearance - Min</b>	0.0030
<b>Eng Internal Radial Clearance - Max</b>	0.0037
<b>Pre Install Clearance Min</b>	0.0030 in 0.075 mm
<b>Pre Install Clearance Max</b>	0.0037 in 0.094 mm

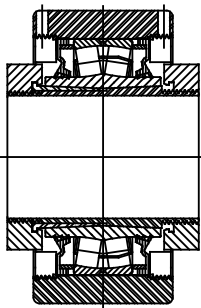
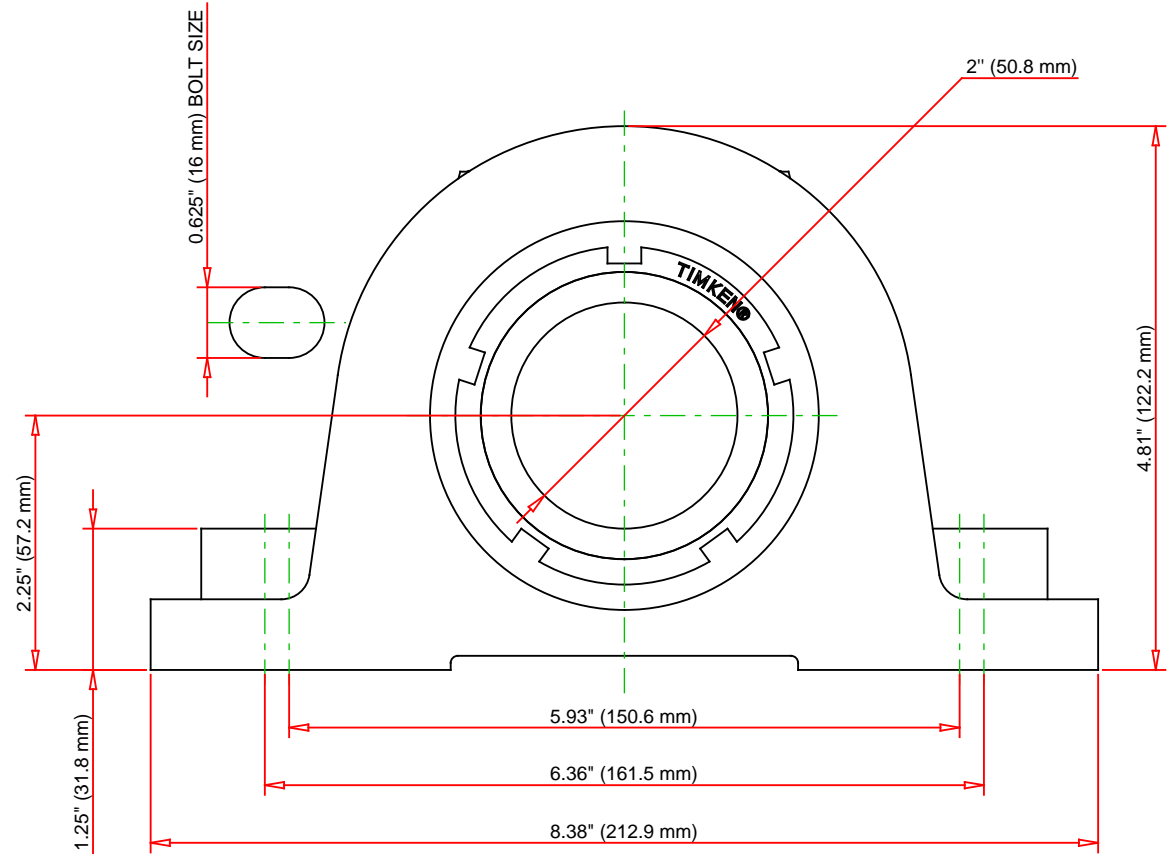
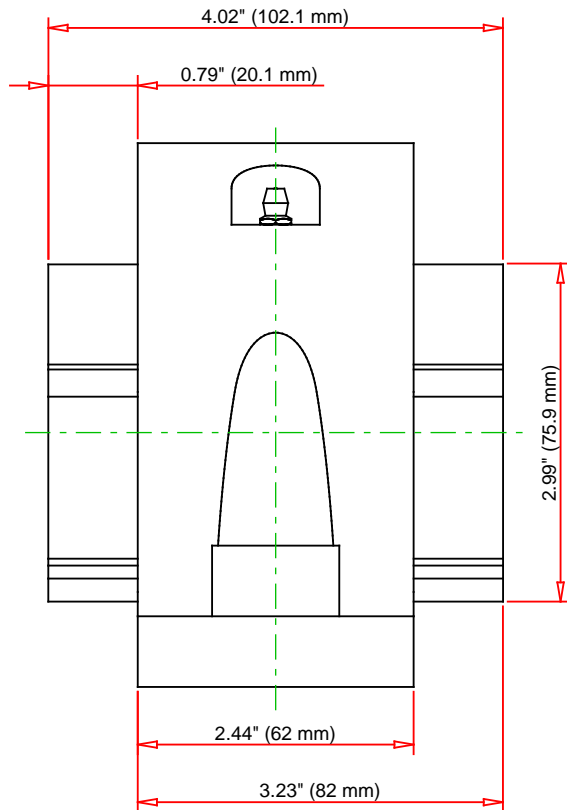

Note: Section View not to Scale

C - Dynamic Load	31400	lbf	140000	N
C0 - Static Load	31900	lbf	142000	N
Weight	14	lb	6.4	kg
Max. Speed T-Seals & Grease	3200	rpm		
Rad. Clearance - Max.	0.0037			

**TIMKEN**

THE TIMKEN COMPANY  
NORTH CANTON, OHIO USA

**QVVPL11V200S**  
Double V-Lock Two-Bolt Pillow Block

Every reasonable effort has been made to ensure the accuracy of the information contained in this writing, but no liability is accepted for errors, omissions or for any other reason.

**FOR DISCUSSION ONLY**