



**The Timken Company**

4500 Mt Pleasant St. NW

N. Canton, OH 44720

**Phone:** (234) 262-3000

**E-Mail:** [CustomerCAD@timken.com](mailto:CustomerCAD@timken.com) • **Web site:** [www.timken.com](http://www.timken.com)

## Part Number QMCW09J111S, Eccentric Piloted Flange Cartridge

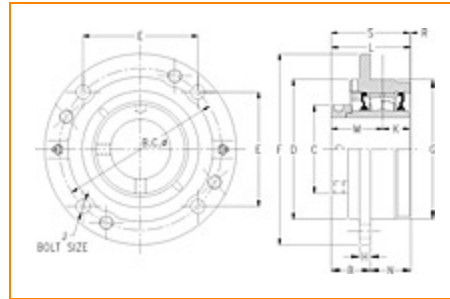

[Specifications](#) | [Dimensions](#) | [Radial and Thrust Factors](#) | [Engineering Seal Speed](#) | [Engineering Bearing Attributes](#) | [Engineering Internal Radial Clearance](#)

### Specifications

**Engineering Group** Mounted Bearing

**Bearing Number** 22209

**Shaft Size** 1 11/16 in

**Shaft Size Type** Imperial

**Full Timken Part Number**

- QMCW09J111SB
- QMCW09J111SC
- QMCW09J111SEB
- QMCW09J111SEC
- QMCW09J111SEM
- QMCW09J111SEN
- QMCW09J111SEO
- QMCW09J111SET
- QMCW09J111SM
- QMCW09J111SN
- QMCW09J111SO
- QMCW09J111ST



<b>Locking Style</b>	Eccentric
<b>Housing Construction</b>	Piloted Flange Cartridge
<b>UPC Code</b>	0883450061629 0883450061636 0883450061650 0883450061667 0883450061674 0883450061681 0883450061698 0883450061704 0883450166409 0883450167123 0883450258548 0883450259095

## Dimensions

<b>Dimension BC</b>	5.13 in 130.3 mm
<b>Dimension B Exp</b>	1.58 in 40.1 mm
<b>Dimension B Fix</b>	1.53 in 38.9 mm
<b>Dimension C</b>	2.63 in 66.8 mm
<b>Dimension D</b>	4.38 in 111.3 mm
<b>Dimension E</b>	3.62 in 91.9 mm
<b>Dimension F</b>	6.13 in 155.7 mm
<b>Dimension G</b>	4.25 in 108 mm

<b>Dimension H</b>	0.4 in 10.2 mm
<b>Dimension J (Bolt Size)</b>	0.438 in 10 mm
<b>Dimension K</b>	0.99 in 25.1 mm
<b>Dimension L Exp</b>	3.08 in 78.2 mm
<b>Dimension L Fix</b>	3.03 in 77 mm
<b>Dimension M</b>	1.88 in 47.8 mm
<b>Dimension N</b>	1.5 in 38.1 mm
<b>Dimension R</b>	0.16 in 4.1 mm
<b>Dimension S</b>	2.87 in 72.9 mm

## Radial and Thrust Factors

<b>C0 - Static Load</b>	24200 lbf 108000 N
<b>C - Dynamic Load (Basic)</b>	24500 lbf 109000 N
<b>e - Geometry Factor</b>	0.26
<b>Y1 - Geometry Factor</b>	2.64
<b>Y2 - Geometry Factor</b>	3.93

## Engineering Seal Speed

<b>Oil Lubrication - M/N Seal</b>	2700 rpm
-----------------------------------	----------

<b>Oil Lubrication - T Seal</b>	4500 rpm
---------------------------------	----------

<b>Oil Lubrication - B/C/O Seal</b>	1950 rpm
-------------------------------------	----------

<b>Grease Lubrication - M/N Seal</b>	2700 rpm
--------------------------------------	----------

<b>Grease Lubrication - T Seal</b>	4000 rpm
------------------------------------	----------

<b>Grease Lubrication - B/C/O Seal</b>	1950 rpm
--	----------

## Engineering Bearing Attributes

<b>Float</b>	0.050 in 1.270 mm
--------------	----------------------

<b>Shaft Tolerance</b>	0.0015 in 0.038 mm
------------------------	-----------------------

## Engineering Internal Radial Clearance

<b>Eng Internal Radial Clearance - Min</b>	0.0014
--	--------

<b>Eng Internal Radial Clearance - Max</b>	0.0022
--	--------

<b>Pre Install Clearance Min</b>	0.0014 in 0.035 mm
----------------------------------	-----------------------

<b>Pre Install Clearance Max</b>	0.0022 in 0.055 mm
----------------------------------	-----------------------

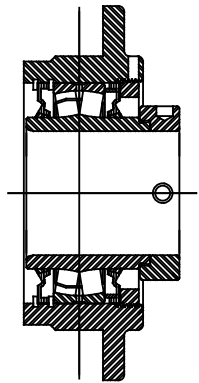
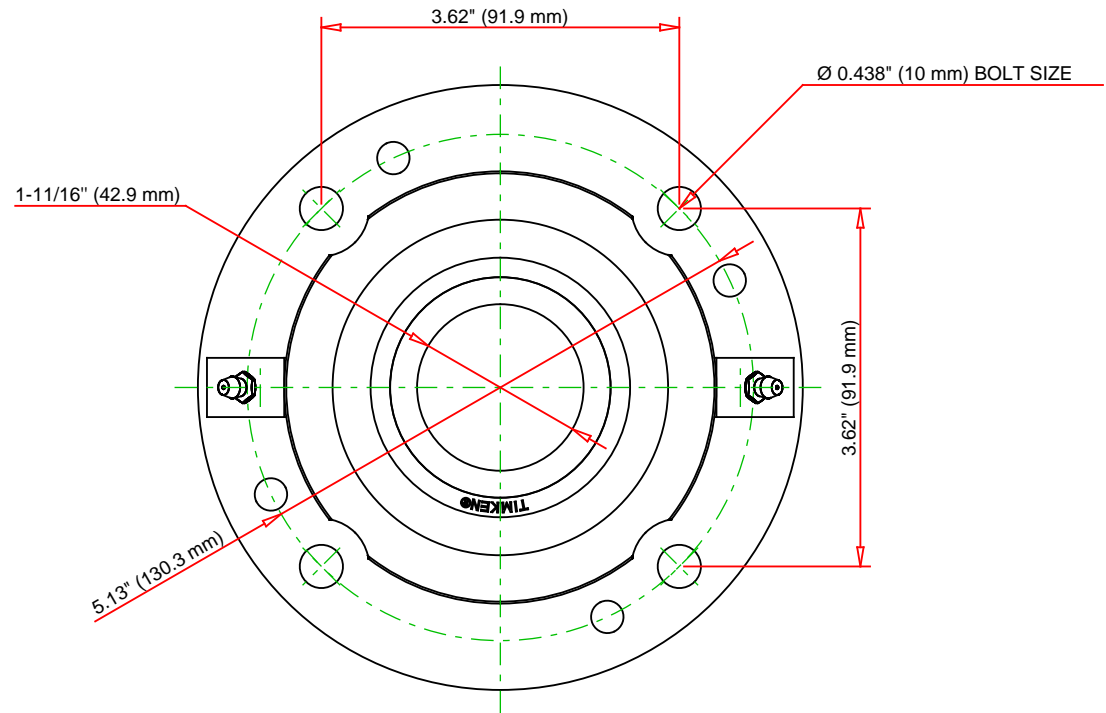
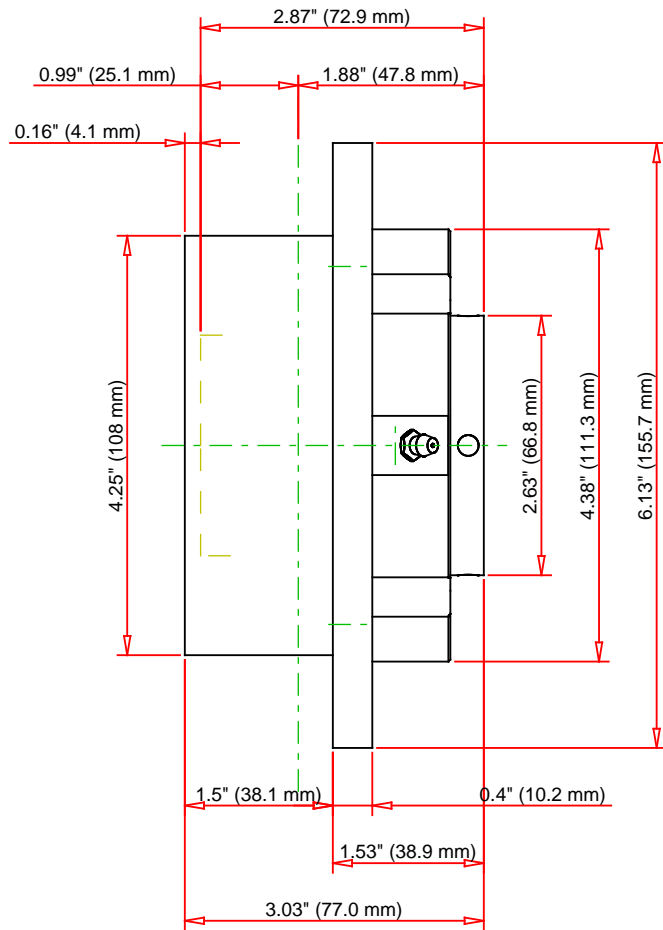

Note: Section View not to Scale

C - Dynamic Load	24500	lbf	109000	N
C0 - Static Load	24200	lbf	108000	N
Weight	9	lb	4.1	kg
Max. Speed T-Seals & Grease	4000	rpm		
Rad. Clearance - Max.	0.0022			

**TIMKEN**

THE TIMKEN COMPANY  
NORTH CANTON, OHIO USA

**QMCW09J111S**  
Eccentric Piloted Flange Cartridge

Every reasonable effort has been made to ensure the accuracy of the information contained in this writing, but no liability is accepted for errors, omissions or for any other reason.

**FOR DISCUSSION ONLY**