



The Timken Company

4500 Mt Pleasant St. NW

N. Canton, OH 44720

Phone: (234) 262-3000

E-Mail: CustomerCAD@timken.com • **Web site:** www.timken.com

Part Number QMCW18J090S, Eccentric Piloted Flange Cartridge

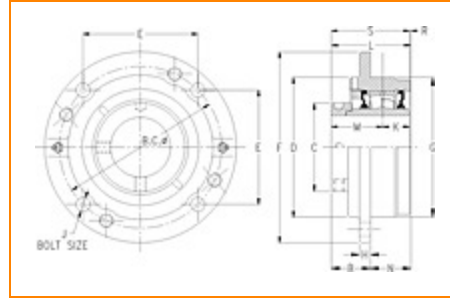

[Specifications](#) | [Dimensions](#) | [Radial and Thrust Factors](#) | [Engineering Seal Speed](#) | [Engineering Bearing Attributes](#) | [Engineering Internal Radial Clearance](#)

Specifications

Engineering Group Mounted Bearing

Bearing Number 22218

Shaft Size 90 mm

Shaft Size Type Metric

Full Timken Part Number

- QMCW18J090SB
- QMCW18J090SC
- QMCW18J090SEB
- QMCW18J090SEC
- QMCW18J090SEM
- QMCW18J090SEN
- QMCW18J090SEO
- QMCW18J090SET
- QMCW18J090SM
- QMCW18J090SN
- QMCW18J090SO
- QMCW18J090ST



Locking Style	Eccentric
Housing Construction	Piloted Flange Cartridge

UPC Code	0883450063326
	0883450063333
	0883450063357
	0883450063364
	0883450063371
	0883450063388
	0883450063395
	0883450063401
	0883450166621
	0883450167345
0883450258807	
0883450259347	

Dimensions

Dimension BC	8.63 in 219.2 mm
---------------------	---------------------

Dimension B Exp	2.54 in 64.5 mm
------------------------	--------------------

Dimension B Fix	2.46 in 62.5 mm
------------------------	--------------------

Dimension C	4.76 in 120.9 mm
--------------------	---------------------

Dimension D	7.38 in 187.5 mm
--------------------	---------------------

Dimension E	6.1 in 154.9 mm
--------------------	--------------------

Dimension F	10-1/4 in 260.4 mm
--------------------	-----------------------

Dimension G	7.375 in 187.3 mm
--------------------	----------------------

Dimension H	0.88 in 22.4 mm
Dimension J (Bolt Size)	0.75 in 20 mm
Dimension K	1.44 in 36.6 mm
Dimension L Exp	4.42 in 112.3 mm
Dimension L Fix	4.34 in 110.2 mm
Dimension M	2.59 in 65.8 mm
Dimension N	1.88 in 47.8 mm
Dimension R	0.31 in 7.9 mm
Dimension S	4.03 in 102.4 mm

Radial and Thrust Factors

C0 - Static Load	87200 lbf 388000 N
C - Dynamic Load (Basic)	79700 lbf 355000 N
e - Geometry Factor	0.23
Y1 - Geometry Factor	2.90
Y2 - Geometry Factor	4.31

Engineering Seal Speed

Oil Lubrication - M/N Seal	1400 rpm
-----------------------------------	----------

Oil Lubrication - T Seal	2400 rpm
---------------------------------	----------

Oil Lubrication - B/C/O Seal	1000 rpm
-------------------------------------	----------

Grease Lubrication - M/N Seal	1400 rpm
--------------------------------------	----------

Grease Lubrication - T Seal	2000 rpm
------------------------------------	----------

Grease Lubrication - B/C/O Seal	1000 rpm
--	----------

Engineering Bearing Attributes

Float	0.083 in 2.108 mm
--------------	----------------------

Shaft Tolerance	0.0030 in 0.076 mm
------------------------	-----------------------

Engineering Internal Radial Clearance

Eng Internal Radial Clearance - Min	0.0024
--	--------

Eng Internal Radial Clearance - Max	0.0039
--	--------

Pre Install Clearance Min	0.0024 in 0.060 mm
----------------------------------	-----------------------

Pre Install Clearance Max	0.0039 in 0.100 mm
----------------------------------	-----------------------

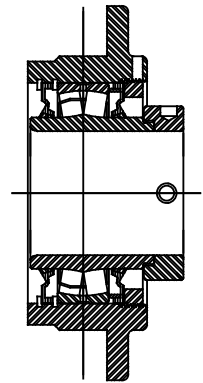
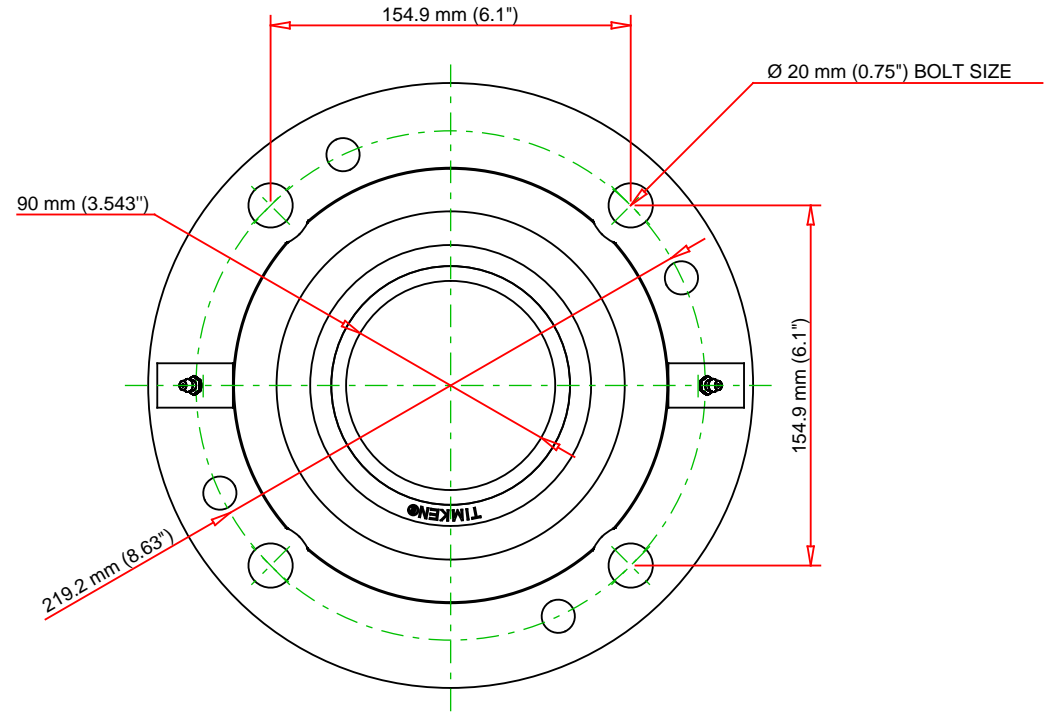
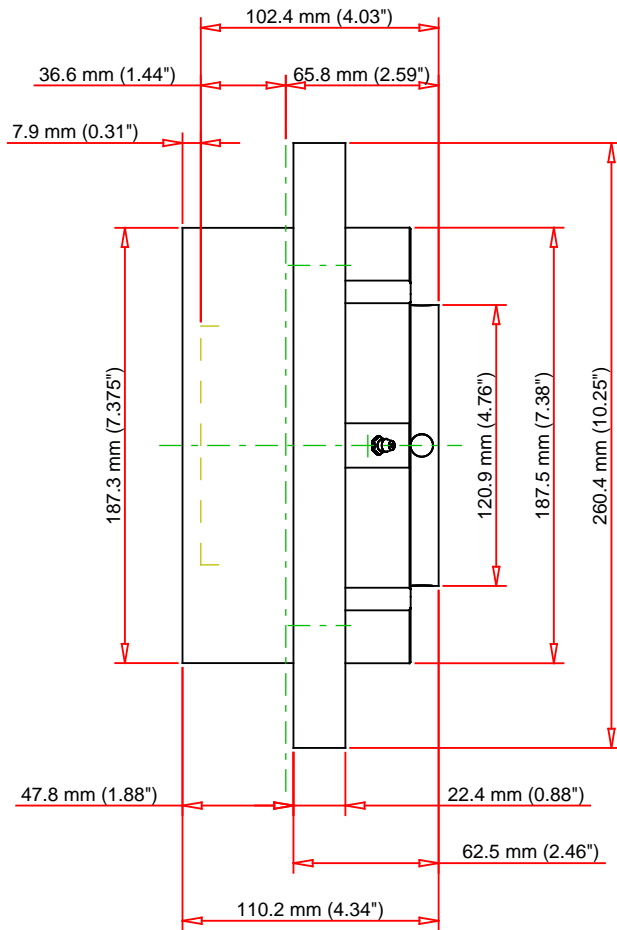

Note: Section View not to Scale

C - Dynamic Load	79700	lbf	355000	N
C0 - Static Load	87200	lbf	388000	N
Weight	32	lb	14.5	kg
Max. Speed T-Seals & Grease	2000	rpm		
Rad. Clearance - Max.	0.0039			

TIMKEN

THE TIMKEN COMPANY
NORTH CANTON, OHIO USA

QMCW18J090S
Eccentric Piloted Flange Cartridge

Every reasonable effort has been made to ensure the accuracy of the information contained in this writing, but no liability is accepted for errors, omissions or for any other reason.

FOR DISCUSSION ONLY