



The Timken Company

4500 Mt Pleasant St. NW

N. Canton, OH 44720

Phone: (234) 262-3000

E-Mail: CustomerCAD@timken.com • **Web site:** www.timken.com

Part Number DVC17K300S, Tapered Adapter Piloted Flange Cartridge

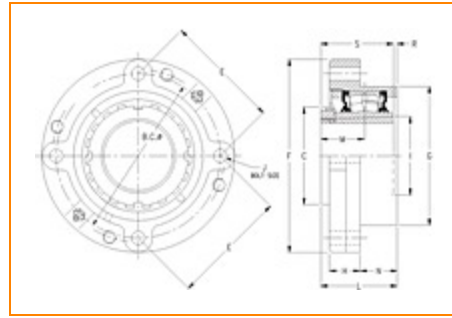

[Specifications](#) | [Dimensions](#) | [Radial and Thrust Factors](#) | [Engineering Seal Speed](#) | [Engineering Bearing Attributes](#) | [Engineering Internal Radial Clearance](#)

Specifications

Engineering Group Mounted Bearing

Bearing Number 22217

Shaft Size 3 in

Shaft Size Type Imperial

Full Timken Part Number

- DVC17K300SB
- DVC17K300SC
- DVC17K300SEB
- DVC17K300SEC
- DVC17K300SEM
- DVC17K300SEN
- DVC17K300SEO
- DVC17K300SET
- DVC17K300SM
- DVC17K300SN



DVC17K300SO
DVC17K300ST
DVC17K300STNG

Locking Style	Tapered Adapter
Housing Construction	Piloted Flange Cartridge
UPC Code	0883450004626 0883450004633 0883450004657 0883450004664 0883450004671 0883450004688 0883450004695 0883450004701 0883450196932 0883450197137 0883450274449 0883450274647 0883450476157

Dimensions

Dimension BC	7-1/2 in 190.5 mm
Dimension C	4.33 in 110 mm
Dimension E	5.3 in 134.6 mm
Dimension F	8-3/4 in 222.3 mm
Dimension G	6.375 in 161.9 mm
Dimension H	1.28 in 32.5 mm
Dimension I	3.55 in 90.2 mm

Dimension J (Bolt Size)	0.625 in 16 mm
Dimension L	3.14 in 79.8 mm
Dimension M	1.96 in 49.8 mm
Dimension N	1.38 in 35.1 mm
Dimension R	0.09 in 2.3 mm
Dimension S	3.23 in 82 mm

Radial and Thrust Factors

C0 - Static Load	71900 lbf 320000 N
C - Dynamic Load (Basic)	66900 lbf 297000 N
e - Geometry Factor	0.22
Y1 - Geometry Factor	3.07
Y2 - Geometry Factor	4.57

Engineering Seal Speed

Oil Lubrication - M/N Seal	1400 rpm
Oil Lubrication - T Seal	2400 rpm
Oil Lubrication - B/C/O Seal	1100 rpm
Grease Lubrication - M/N Seal	1400 rpm

Grease Lubrication - T Seal	2000 rpm
------------------------------------	----------

Grease Lubrication - B/C/O Seal	1100 rpm
--	----------

Engineering Bearing Attributes

Float	0.083 in 2.108 mm
--------------	----------------------

Shaft Tolerance	0.0040 in 0.102 mm
------------------------	-----------------------

Engineering Internal Radial Clearance

Pre Install Clearance Min	0.0043 in 0.109 mm
----------------------------------	-----------------------

Pre Install Clearance Max	0.0055 in 0.140 mm
----------------------------------	-----------------------

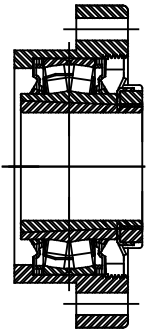
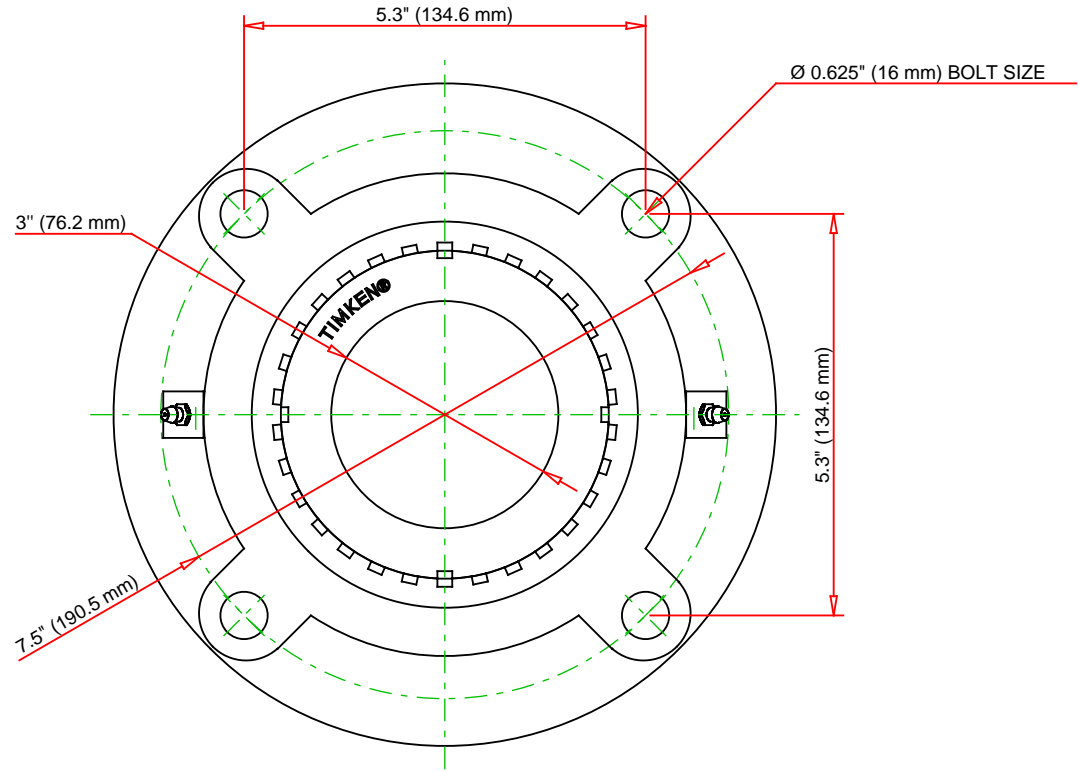
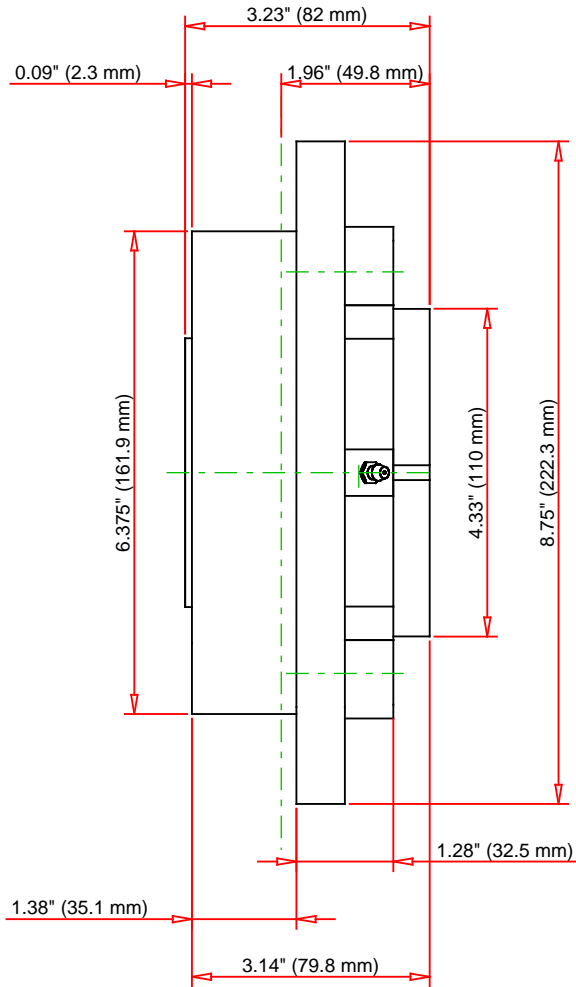

Note: Section View not to Scale

C - Dynamic Load	66900	lbf	297000	N
C0 - Static Load	71900	lbf	320000	N
Weight	25	lb	11.3	kg
Max. Speed T-Seals & Grease	2000	rpm		
Rad. Clearance - Max.				

TIMKEN

THE TIMKEN COMPANY
NORTH CANTON, OHIO USA

DVC17K300S

Tapered Adapter Piloted Flange
Cartridge

Every reasonable effort has been made to ensure the accuracy of the information contained in this writing, but no liability is accepted for errors, omissions or for any other reason.

FOR DISCUSSION ONLY