



**The Timken Company**

4500 Mt Pleasant St. NW

N. Canton, OH 44720

**Phone:** (234) 262-3000

**E-Mail:** [CustomerCAD@timken.com](mailto:CustomerCAD@timken.com) • **Web site:** [www.timken.com](http://www.timken.com)

## Part Number QMC20J311S, Eccentric Piloted Flange Cartridge

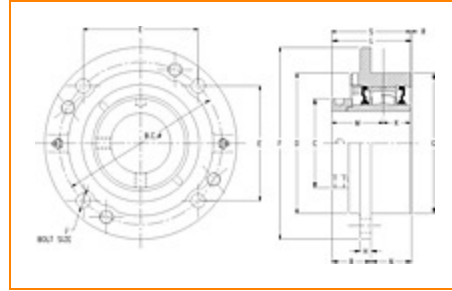

[Specifications](#) | [Dimensions](#) | [Radial and Thrust Factors](#) | [Engineering Seal Speed](#) | [Engineering Bearing Attributes](#) | [Engineering Internal Radial Clearance](#)

### Specifications

**Engineering Group** Mounted Bearing

**Bearing Number** 22220

**Shaft Size** 3 11/16 in

**Shaft Size Type** Imperial

**Full Timken Part Number**

- QMC20J311SB
- QMC20J311SC
- QMC20J311SEB
- QMC20J311SEC
- QMC20J311SEM
- QMC20J311SEN
- QMC20J311SEO
- QMC20J311SET
- QMC20J311SM
- QMC20J311SN
- QMC20J311SO
- QMC20J311ST



<b>Locking Style</b>	Eccentric
<b>Housing Construction</b>	Piloted Flange Cartridge
<b>UPC Code</b>	0883450060721 0883450060738 0883450060752 0883450060769 0883450060776 0883450060783 0883450060790 0883450060806 0883450165792 0883450166218 0883450258050 0883450258432

## Dimensions

<b>Dimension BC</b>	9.38 in 238.3 mm
<b>Dimension B Exp</b>	2.92 in 74.2 mm
<b>Dimension B Fix</b>	2.84 in 72.1 mm
<b>Dimension C</b>	6 in 152.4 mm
<b>Dimension D</b>	8.13 in 206.5 mm
<b>Dimension E</b>	6.63 in 168.4 mm
<b>Dimension F</b>	10.88 in 276.4 mm
<b>Dimension G</b>	8.125 in 206.4 mm

<b>Dimension H</b>	1 in 25.4 mm
<b>Dimension J (Bolt Size)</b>	0.75 in 20 mm
<b>Dimension K</b>	1.63 in 41.4 mm
<b>Dimension L Exp</b>	5.04 in 128 mm
<b>Dimension L Fix</b>	4.96 in 126 mm
<b>Dimension M</b>	2.96 in 75.2 mm
<b>Dimension N</b>	2.13 in 54.1 mm
<b>Dimension R</b>	0.37 in 9.4 mm
<b>Dimension S</b>	4.56 in 115.8 mm

## Radial and Thrust Factors

<b>C0 - Static Load</b>	113000 lbf 502000 N
<b>C - Dynamic Load (Basic)</b>	97700 lbf 435000 N
<b>e - Geometry Factor</b>	0.24
<b>Y1 - Geometry Factor</b>	2.85
<b>Y2 - Geometry Factor</b>	4.24

## Engineering Seal Speed

<b>Oil Lubrication - M/N Seal</b>	1200 rpm
-----------------------------------	----------

<b>Oil Lubrication - T Seal</b>	2000 rpm
---------------------------------	----------

<b>Oil Lubrication - B/C/O Seal</b>	900 rpm
-------------------------------------	---------

<b>Grease Lubrication - M/N Seal</b>	1200 rpm
--------------------------------------	----------

<b>Grease Lubrication - T Seal</b>	1600 rpm
------------------------------------	----------

<b>Grease Lubrication - B/C/O Seal</b>	900 rpm
--	---------

## Engineering Bearing Attributes

<b>Float</b>	0.083 in 2.108 mm
--------------	----------------------

<b>Shaft Tolerance</b>	0.0030 in 0.076 mm
------------------------	-----------------------

## Engineering Internal Radial Clearance

<b>Eng Internal Radial Clearance - Min</b>	0.0030
--	--------

<b>Eng Internal Radial Clearance - Max</b>	0.0047
--	--------

<b>Pre Install Clearance Min</b>	0.0030 in 0.075 mm
----------------------------------	-----------------------

<b>Pre Install Clearance Max</b>	0.0047 in 0.120 mm
----------------------------------	-----------------------

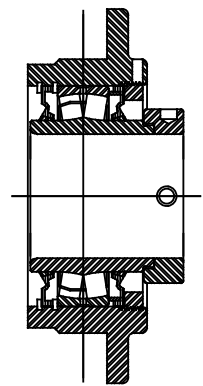
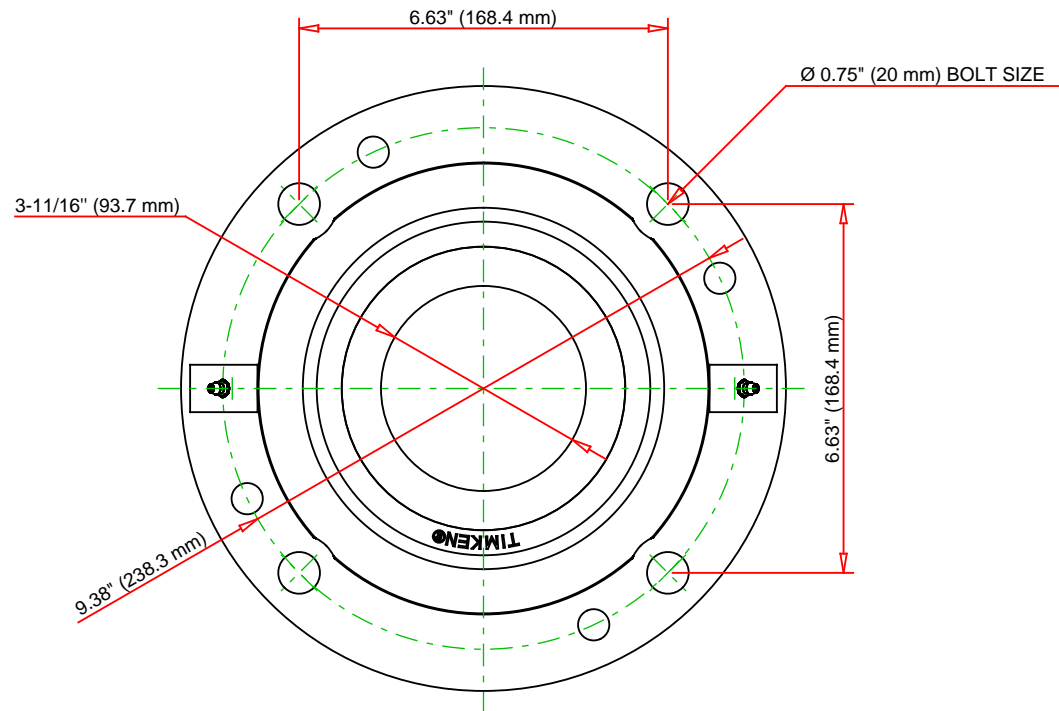
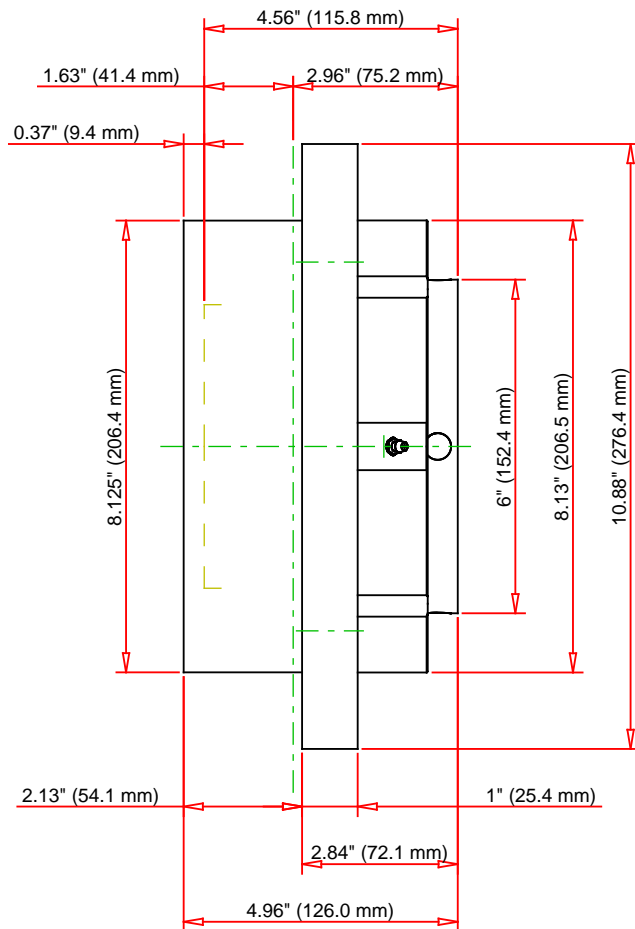

Note: Section View not to Scale

C - Dynamic Load	97700	lbf	435000	N
C0 - Static Load	113000	lbf	502000	N
Weight	43	lb	19.5	kg
Max. Speed T-Seals & Grease	1600	rpm		
Rad. Clearance - Max.	0.0047			

**TIMKEN**

THE TIMKEN COMPANY  
NORTH CANTON, OHIO USA

**QMC20J311S**  
Eccentric Piloted Flange Cartridge

Every reasonable effort has been made to ensure the accuracy of the information contained in this writing, but no liability is accepted for errors, omissions or for any other reason.

**FOR DISCUSSION ONLY**