



The Timken Company

4500 Mt Pleasant St. NW

N. Canton, OH 44720

Phone: (234) 262-3000

E-Mail: CustomerCAD@timken.com • **Web site:** www.timken.com

Part Number QMC09J112S, Eccentric Piloted Flange Cartridge

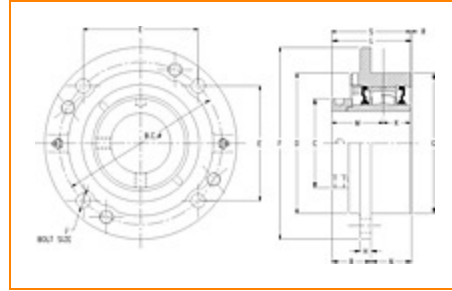

[Specifications](#) | [Dimensions](#) | [Radial and Thrust Factors](#) | [Engineering Seal Speed](#) | [Engineering Bearing Attributes](#) | [Engineering Internal Radial Clearance](#)

Specifications

Engineering Group Mounted Bearing

Bearing Number 22209

Shaft Size 1 3/4 in

Shaft Size Type Imperial

Full Timken Part Number

- QMC09J112SB
- QMC09J112SC
- QMC09J112SEB
- QMC09J112SEC
- QMC09J112SEM
- QMC09J112SEN
- QMC09J112SEO
- QMC09J112SET
- QMC09J112SM
- QMC09J112SN
- QMC09J112SO
- QMC09J112ST



| | |
|-----------------------------|--|
| Locking Style | Eccentric |
| Housing Construction | Piloted Flange Cartridge |
| UPC Code | 0883450058520 0883450058537 0883450058551 0883450058568 0883450058575 0883450058582 0883450058599 0883450058605 0883450165570 0883450165990 0883450257800 0883450258180 |

Dimensions

| | |
|------------------------|---------------------|
| Dimension BC | 5.13 in 130.3 mm |
| Dimension B Exp | 2.23 in 56.6 mm |
| Dimension B Fix | 2.15 in 54.6 mm |
| Dimension C | 2.63 in 66.8 mm |
| Dimension D | 4.38 in 111.3 mm |
| Dimension E | 3.62 in 91.9 mm |
| Dimension F | 6.13 in 155.7 mm |
| Dimension G | 4.25 in 108 mm |

| | |
|--------------------------------|--------------------|
| Dimension H | 0.5 in 12.7 mm |
| Dimension J (Bolt Size) | 0.438 in 10 mm |
| Dimension K | 1 in 25.4 mm |
| Dimension L Exp | 3.11 in 79 mm |
| Dimension L Fix | 3.03 in 77 mm |
| Dimension M | 1.87 in 47.5 mm |
| Dimension N | 0.88 in 22.4 mm |
| Dimension R | 0.15 in 3.8 mm |
| Dimension S | 2.87 in 72.9 mm |

Radial and Thrust Factors

| | |
|---------------------------------|-----------------------|
| C0 - Static Load | 24200 lbf 108000 N |
| C - Dynamic Load (Basic) | 24500 lbf 109000 N |
| e - Geometry Factor | 0.26 |
| Y1 - Geometry Factor | 2.64 |
| Y2 - Geometry Factor | 3.93 |

Engineering Seal Speed

| | |
|-----------------------------------|----------|
| Oil Lubrication - M/N Seal | 2700 rpm |
|-----------------------------------|----------|

| | |
|---------------------------------|----------|
| Oil Lubrication - T Seal | 4500 rpm |
|---------------------------------|----------|

| | |
|-------------------------------------|----------|
| Oil Lubrication - B/C/O Seal | 1950 rpm |
|-------------------------------------|----------|

| | |
|--------------------------------------|----------|
| Grease Lubrication - M/N Seal | 2700 rpm |
|--------------------------------------|----------|

| | |
|------------------------------------|----------|
| Grease Lubrication - T Seal | 4000 rpm |
|------------------------------------|----------|

| | |
|--|----------|
| Grease Lubrication - B/C/O Seal | 1950 rpm |
|--|----------|

Engineering Bearing Attributes

| | |
|--------------|----------------------|
| Float | 0.050 in 1.270 mm |
|--------------|----------------------|

| | |
|------------------------|-----------------------|
| Shaft Tolerance | 0.0015 in 0.038 mm |
|------------------------|-----------------------|

Engineering Internal Radial Clearance

| | |
|--|--------|
| Eng Internal Radial Clearance - Min | 0.0014 |
|--|--------|

| | |
|--|--------|
| Eng Internal Radial Clearance - Max | 0.0022 |
|--|--------|

| | |
|----------------------------------|-----------------------|
| Pre Install Clearance Min | 0.0014 in 0.035 mm |
|----------------------------------|-----------------------|

| | |
|----------------------------------|-----------------------|
| Pre Install Clearance Max | 0.0022 in 0.055 mm |
|----------------------------------|-----------------------|

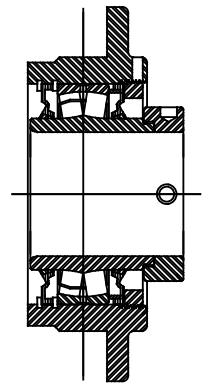
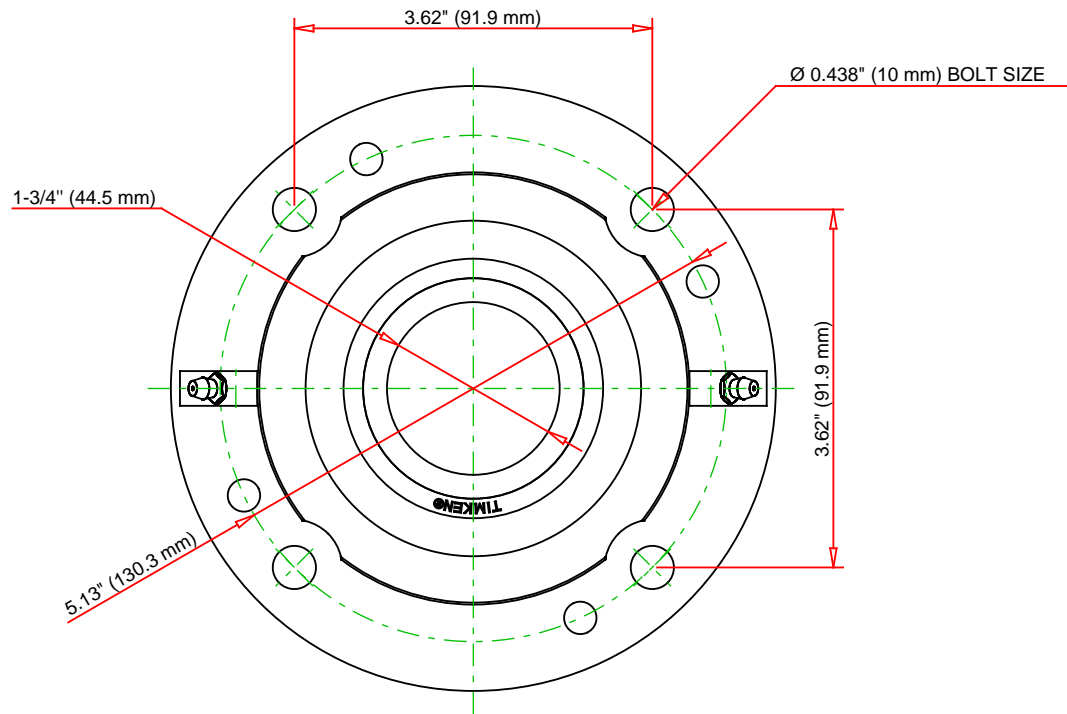
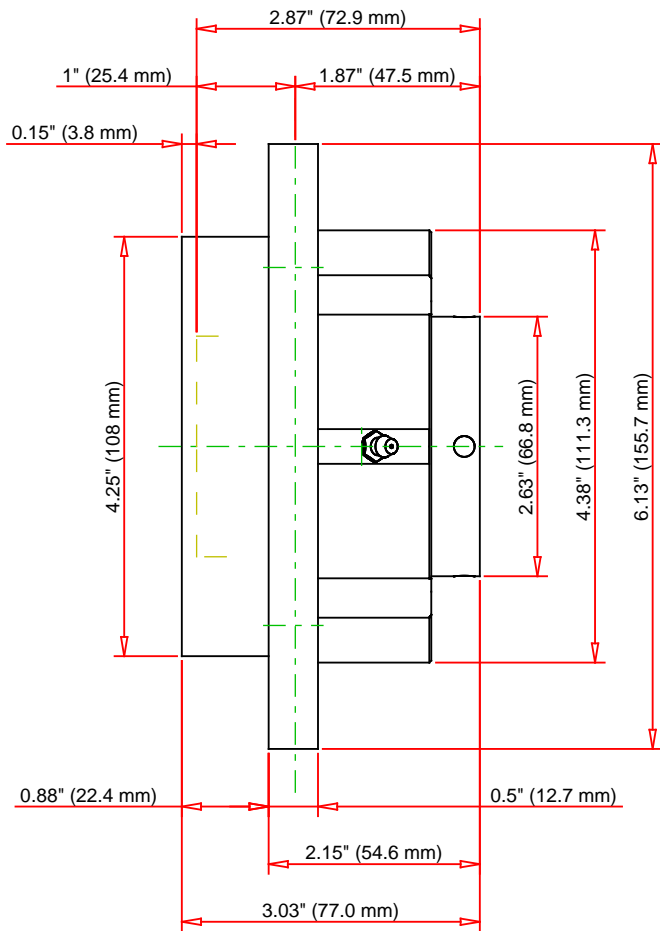

Note: Section View not to Scale

| | | | | |
|-----------------------------|--------|-----|--------|----|
| C - Dynamic Load | 24500 | lbf | 109000 | N |
| C0 - Static Load | 24200 | lbf | 108000 | N |
| Weight | 9 | lb | 4.1 | kg |
| Max. Speed T-Seals & Grease | 4000 | rpm | | |
| Rad. Clearance - Max. | 0.0022 | | | |

TIMKEN

THE TIMKEN COMPANY
NORTH CANTON, OHIO USA

QMC09J112S
Eccentric Piloted Flange Cartridge

Every reasonable effort has been made to ensure the accuracy of the information contained in this writing, but no liability is accepted for errors, omissions or for any other reason.

FOR DISCUSSION ONLY