



The Timken Company

4500 Mt Pleasant St. NW

N. Canton, OH 44720

Phone: (234) 262-3000

E-Mail: CustomerCAD@timken.com • **Web site:** www.timken.com

Part Number QAMC11A203S, Single Concentric Cartridge Block

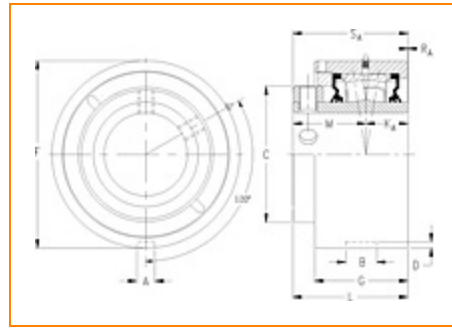

[Specifications](#) | [Dimensions](#) | [Radial and Thrust Factors](#) | [Engineering Seal Speed](#) | [Engineering Bearing Attributes](#) | [Engineering Internal Radial Clearance](#)

Specifications

Engineering Group Mounted Bearing

Bearing Number 22211

Shaft Size 2 3/16 in

Shaft Size Type Imperial

Full Timken Part Number

- QAMC11A203SB
- QAMC11A203SC
- QAMC11A203SEB
- QAMC11A203SEC
- QAMC11A203SEM
- QAMC11A203SEN
- QAMC11A203SEO
- QAMC11A203SET
- QAMC11A203SM
- QAMC11A203SN
- QAMC11A203SO
- QAMC11A203ST



Locking Style	Single Concentric
Housing Construction	Cartridge
UPC Code	0883450042901 0883450042918 0883450042932 0883450042949 0883450042956 0883450042963 0883450042970 0883450042987 0883450194525 0883450194686 0883450271691 0883450271851

Dimensions

Dimension A	0.53 in 13.5 mm
Dimension B	0.91 in 23.1 mm
Dimension C	3.25 in 82.6 mm
Dimension D	0.19 in 4.8 mm
Dimension F	4.531 in 115.1 mm
Dimension G	2.58 in 65.5 mm
Dimension KA	1.13 in 28.7 mm
Dimension L Exp	3.38 in 85.9 mm

Dimension L Fix	3.3 in 83.8 mm
------------------------	-------------------

Dimension M	2 in 50.8 mm
--------------------	-----------------

Dimension RA	0.16 in 4.1 mm
---------------------	-------------------

Dimension SA	3.13 in 79.5 mm
---------------------	--------------------

Radial and Thrust Factors

C0 - Static Load	31900 lbf 142000 N
-------------------------	-----------------------

C - Dynamic Load (Basic)	31400 lbf 140000 N
---------------------------------	-----------------------

e - Geometry Factor	0.23
----------------------------	------

Y1 - Geometry Factor	2.95
-----------------------------	------

Y2 - Geometry Factor	4.40
-----------------------------	------

Engineering Seal Speed

Oil Lubrication - M/N Seal	2200 rpm
-----------------------------------	----------

Oil Lubrication - T Seal	3800 rpm
---------------------------------	----------

Oil Lubrication - B/C/O Seal	1600 rpm
-------------------------------------	----------

Grease Lubrication - M/N Seal	2200 rpm
--------------------------------------	----------

Grease Lubrication - T Seal	3200 rpm
------------------------------------	----------

Grease Lubrication - B/C/O Seal	1600 rpm
--	----------

Engineering Bearing Attributes

Float	0.050 in 1.270 mm
--------------	----------------------

Shaft Tolerance	0.0015 in 0.038 mm
------------------------	-----------------------

Engineering Internal Radial Clearance

Eng Internal Radial Clearance - Min	0.0016
--	--------

Eng Internal Radial Clearance - Max	0.0026
--	--------

Pre Install Clearance Min	0.0016 in 0.040 mm
----------------------------------	-----------------------

Pre Install Clearance Max	0.0026 in 0.065 mm
----------------------------------	-----------------------

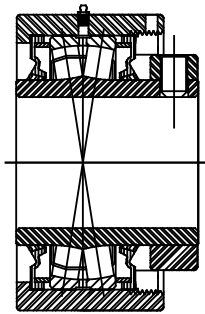
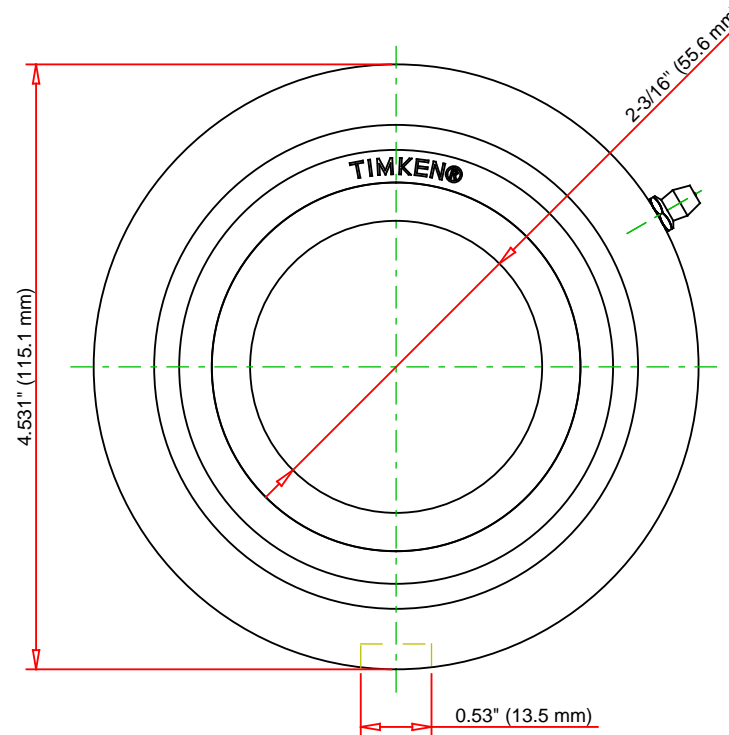
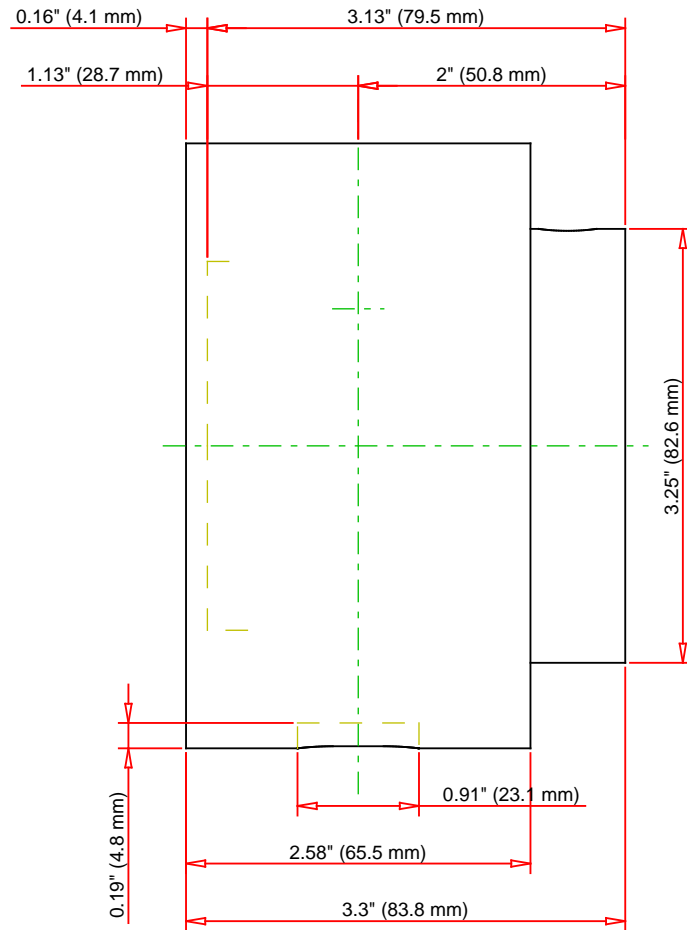

Note: Section View not to Scale

C - Dynamic Load	31400	lbf	140000	N
C0 - Static Load	31900	lbf	142000	N
Weight	10	lb	4.5	kg
Max. Speed T-Seals & Grease	3200	rpm		
Rad. Clearance - Max.	0.0026			

TIMKEN

THE TIMKEN COMPANY
NORTH CANTON, OHIO USA

QAMC11A203S
Single Concentric Cartridge Block

Every reasonable effort has been made to ensure the accuracy of the information contained in this writing, but no liability is accepted for errors, omissions or for any other reason.

FOR DISCUSSION ONLY