

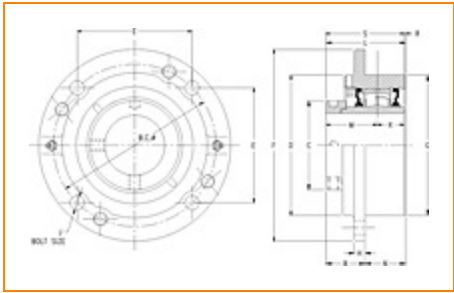

The Timken Company
4500 Mt Pleasant St. NW
N. Canton, OH 44720
Phone: (234) 262-3000
E-Mail: CustomerCAD@timken.com • **Web site:** www.timken.com

Part Number QMC20J315S, Eccentric Piloted Flange Cartridge



[Specifications](#) | [Dimensions](#) | [Radial and Thrust Factors](#) | [Engineering Seal Speed](#) | [Engineering Bearing Attributes](#) | [Engineering Internal Radial Clearance](#)

Specifications

Engineering Group	Mounted Bearing
Bearing Number	22220
Shaft Size	3 15/16 in
Shaft Size Type	Imperial
Full Timken Part Number	QMC20J315SB QMC20J315SC QMC20J315SEB QMC20J315SEC QMC20J315SEM QMC20J315SEN QMC20J315SEO QMC20J315SET QMC20J315SM QMC20J315SN QMC20J315SO QMC20J315ST



Locking Style	Eccentric
Housing Construction	Piloted Flange Cartridge
UPC Code	0883450060929
	0883450060936
	0883450060950
	0883450060967
	0883450060974
	0883450060981
	0883450060998
	0883450061001
	0883450165815
	0883450166232
	0883450258074
	0883450258456

Dimensions

Dimension BC	9.38 in 238.3 mm
Dimension B Exp	2.92 in 74.2 mm
Dimension B Fix	2.84 in 72.1 mm
Dimension C	6 in 152.4 mm
Dimension D	8.13 in 206.5 mm
Dimension E	6.63 in 168.4 mm
Dimension F	10.88 in 276.4 mm
Dimension G	8.125 in 206.4 mm

Dimension H	1 in 25.4 mm
Dimension J (Bolt Size)	0.75 in 20 mm
Dimension K	1.63 in 41.4 mm
Dimension L Exp	5.04 in 128 mm
Dimension L Fix	4.96 in 126 mm
Dimension M	2.96 in 75.2 mm
Dimension N	2.13 in 54.1 mm
Dimension R	0.37 in 9.4 mm
Dimension S	4.56 in 115.8 mm

Radial and Thrust Factors

C0 - Static Load	113000 lbf 502000 N
C - Dynamic Load (Basic)	97700 lbf 435000 N
e - Geometry Factor	0.24
Y1 - Geometry Factor	2.85
Y2 - Geometry Factor	4.24

Engineering Seal Speed

Oil Lubrication - M/N Seal	1200 rpm
Oil Lubrication - T Seal	2000 rpm
Oil Lubrication - B/C/O Seal	900 rpm
Grease Lubrication - M/N Seal	1200 rpm
Grease Lubrication - T Seal	1600 rpm
Grease Lubrication - B/C/O Seal	900 rpm

Engineering Bearing Attributes

Float	0.083 in 2.108 mm
Shaft Tolerance	0.0030 in 0.076 mm

Engineering Internal Radial Clearance

Eng Internal Radial Clearance - Min	0.0030
Eng Internal Radial Clearance - Max	0.0047
Pre Install Clearance Min	0.0030 in 0.075 mm
Pre Install Clearance Max	0.0047 in 0.120 mm

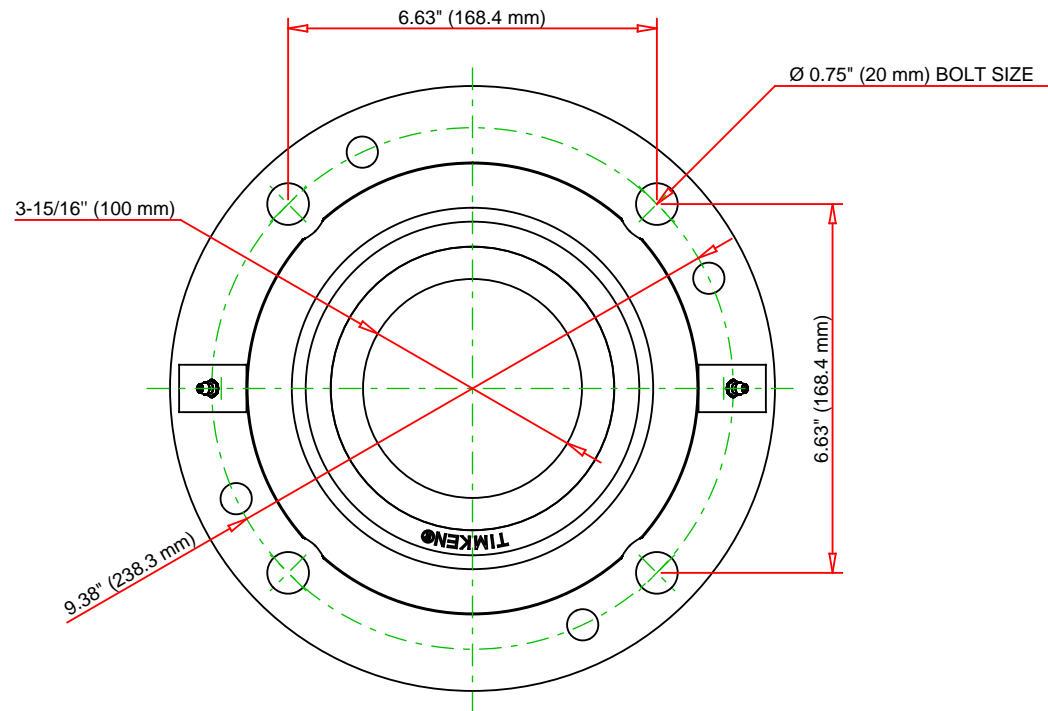
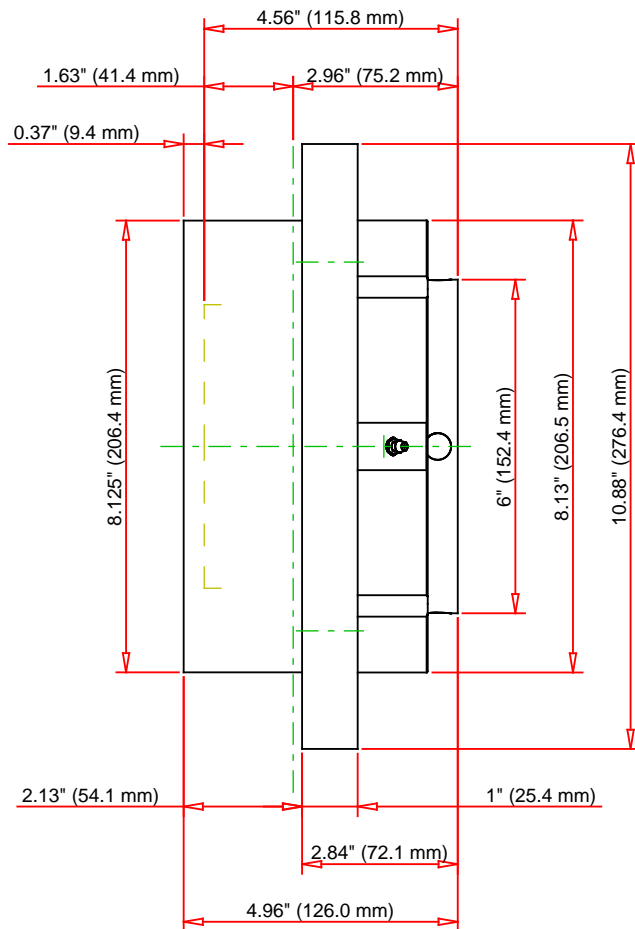

Note: Section View not to Scale

C - Dynamic Load	97700	lbf	435000	N
C0 - Static Load	113000	lbf	502000	N
Weight	43	lb	19.5	kg
Max. Speed T-Seals & Grease	1600	rpm		
Rad. Clearance - Max.	0.0047			

TIMKEN

THE TIMKEN COMPANY
NORTH CANTON, OHIO USA

QMC20J315S

Eccentric Piloted Flange Cartridge

Every reasonable effort has been made to ensure the accuracy of the information contained in this writing, but no liability is accepted for errors, omissions or for any other reason.

FOR DISCUSSION ONLY