



**The Timken Company**

4500 Mt Pleasant St. NW

N. Canton, OH 44720

**Phone:** (234) 262-3000

**E-Mail:** [CustomerCAD@timken.com](mailto:CustomerCAD@timken.com) • **Web site:** [www.timken.com](http://www.timken.com)

## Part Number DVC15K065S, Tapered Adapter Piloted Flange Cartridge

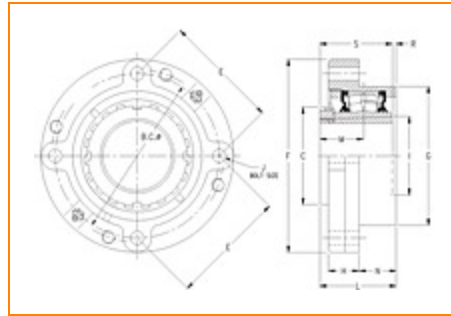

[Specifications](#) | [Dimensions](#) | [Radial and Thrust Factors](#) | [Engineering Seal Speed](#) | [Engineering Bearing Attributes](#) | [Engineering Internal Radial Clearance](#)

### Specifications

**Engineering Group** Mounted Bearing

**Bearing Number** 22215

**Shaft Size** 65 mm

**Shaft Size Type** Metric

**Full Timken Part Number**

- DVC15K065SB
- DVC15K065SC
- DVC15K065SEB
- DVC15K065SEC
- DVC15K065SEM
- DVC15K065SEN
- DVC15K065SEO
- DVC15K065SET
- DVC15K065SM
- DVC15K065SN
- DVC15K065SO
- DVC15K065ST



<b>Locking Style</b>	Tapered Adapter
<b>Housing Construction</b>	Piloted Flange Cartridge
<b>UPC Code</b>	0883450004121 0883450004138 0883450004152 0883450004169 0883450004176 0883450004183 0883450004190 0883450004206 0883450196918 0883450197113 0883450274425 0883450274623

## Dimensions

<b>Dimension BC</b>	6-1/2 in 165.1 mm
<b>Dimension C</b>	3.86 in 98 mm
<b>Dimension E</b>	4.6 in 116.8 mm
<b>Dimension F</b>	7.63 in 193.8 mm
<b>Dimension G</b>	5.5 in 139.7 mm
<b>Dimension H</b>	1.27 in 32.3 mm
<b>Dimension I</b>	3.11 in 79 mm
<b>Dimension J (Bolt Size)</b>	0.5 in 12 mm

<b>Dimension L</b>	2.75 in 69.9 mm
--------------------	--------------------

<b>Dimension M</b>	1.73 in 43.9 mm
--------------------	--------------------

<b>Dimension N</b>	1.25 in 31.8 mm
--------------------	--------------------

<b>Dimension R</b>	0.14 in 3.6 mm
--------------------	-------------------

<b>Dimension S</b>	2.87 in 72.9 mm
--------------------	--------------------

## Radial and Thrust Factors

<b>C0 - Static Load</b>	54100 lbf 240000 N
-------------------------	-----------------------

<b>C - Dynamic Load (Basic)</b>	49900 lbf 222000 N
---------------------------------	-----------------------

<b>e - Geometry Factor</b>	0.22
----------------------------	------

<b>Y1 - Geometry Factor</b>	3.14
-----------------------------	------

<b>Y2 - Geometry Factor</b>	4.67
-----------------------------	------

## Engineering Seal Speed

<b>Oil Lubrication - M/N Seal</b>	1600 rpm
-----------------------------------	----------

<b>Oil Lubrication - T Seal</b>	2900 rpm
---------------------------------	----------

<b>Oil Lubrication - B/C/O Seal</b>	1300 rpm
-------------------------------------	----------

<b>Grease Lubrication - M/N Seal</b>	1600 rpm
--------------------------------------	----------

<b>Grease Lubrication - T Seal</b>	2400 rpm
------------------------------------	----------

<b>Grease Lubrication - B/C/O Seal</b>	1300 rpm
--	----------

## Engineering Bearing Attributes

<b>Float</b>	0.083 in 2.108 mm
<b>Shaft Tolerance</b>	0.0035 in 0.089 mm

## Engineering Internal Radial Clearance

<b>Pre Install Clearance Min</b>	0.0037 in 0.095 mm
<b>Pre Install Clearance Max</b>	0.0047 in 0.120 mm

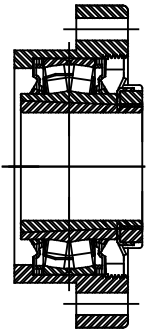
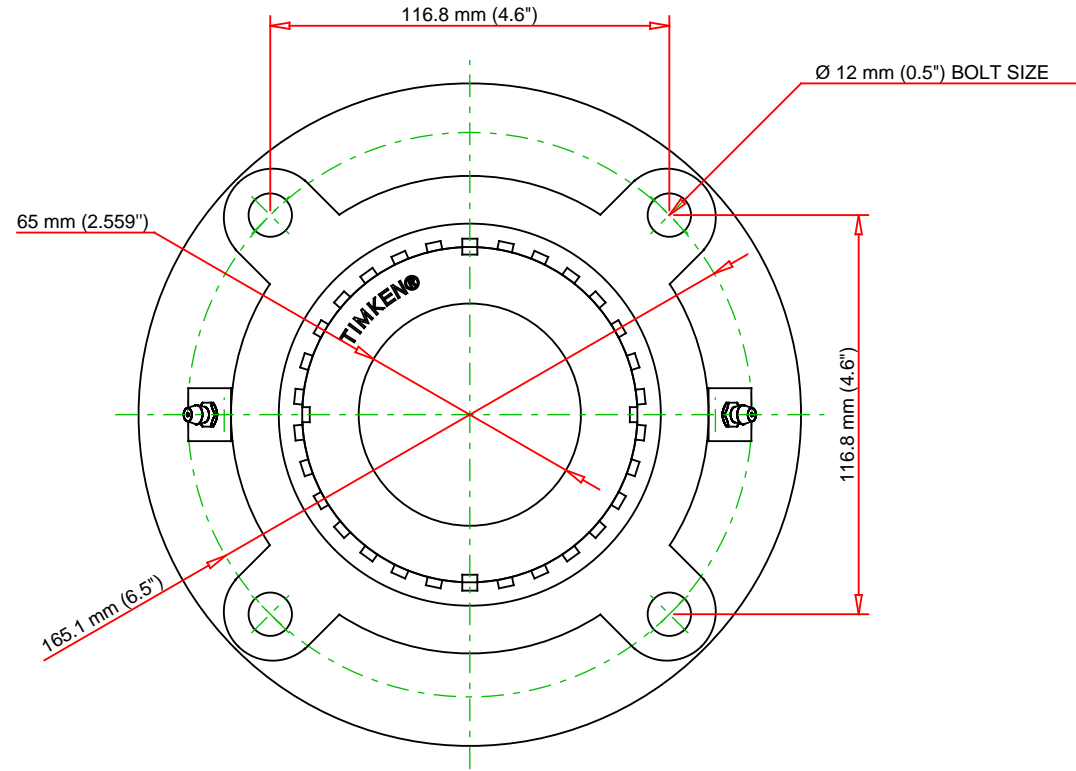
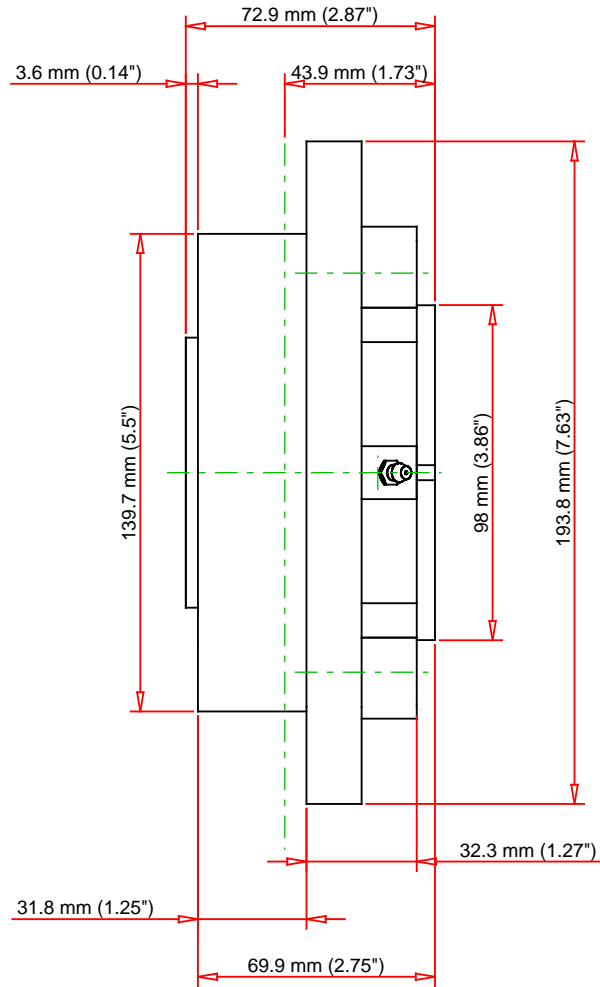

Note: Section View not to Scale

C - Dynamic Load	49900	lbf	222000	N
C0 - Static Load	54100	lbf	240000	N
Weight	18	lb	8.2	kg
Max. Speed T-Seals & Grease	2400	rpm		
Rad. Clearance - Max.				

**TIMKEN**

THE TIMKEN COMPANY  
NORTH CANTON, OHIO USA

**DVC15K065S**

Tapered Adapter Piloted Flange  
Cartridge

Every reasonable effort has been made to ensure the accuracy of the information contained in this writing, but no liability is accepted for errors, omissions or for any other reason.

**FOR DISCUSSION ONLY**