



The Timken Company

4500 Mt Pleasant St. NW

N. Canton, OH 44720

Phone: (234) 262-3000

E-Mail: CustomerCAD@timken.com • **Web site:** www.timken.com

Part Number QAASN15A075S, Double Concentric Two-Bolt Pillow Block

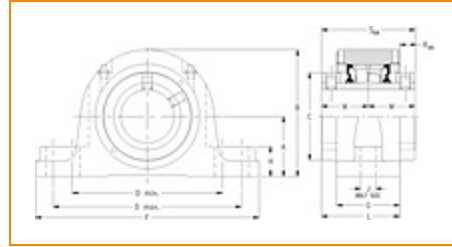
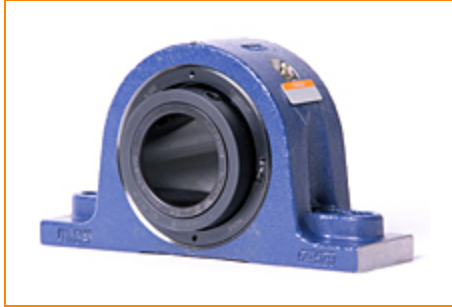

[Specifications](#) | [Dimensions](#) | [Radial and Thrust Factors](#) | [Engineering Seal Speed](#) | [Engineering Bearing Attributes](#) | [Engineering Internal Radial Clearance](#)

Specifications

Engineering Group Mounted Bearing

Bearing Number 22215

Shaft Size 75 mm

Shaft Size Type Metric

Full Timken Part Number

- QAASN15A075SB
- QAASN15A075SC
- QAASN15A075SEB
- QAASN15A075SEC
- QAASN15A075SEM
- QAASN15A075SEN
- QAASN15A075SEO
- QAASN15A075SET
- QAASN15A075SM
- QAASN15A075SN
- QAASN15A075SO
- QAASN15A075ST



Locking Style

Double Concentric

Housing Construction

Two-Bolt Pillow Block

UPC Code

0883450349710
 0883450349727
 0883450349734
 0883450349741
 0883450349758
 0883450349765
 0883450349772
 0883450349789
 0883450349796
 0883450349802
 0883450349819
 0883450349826

Dimensions**Dimension A**

3.74 in
 95 mm

Dimension B

7.2 in
 183 mm

Dimension C

4.29 in
 109 mm

Dimension D Min

9.49 in
 241 mm

Dimension D Max

10.98 in
 279 mm

Dimension F

12.44 in
 316 mm

Dimension G

2.99 in
 76 mm

Dimension H

1.34 in
 34 mm

Dimension J (Bolt Size)

0.75 in
 20 mm

Dimension L	3.86 in 98 mm
Dimension M	2.37 in 60.2 mm
Dimension RAA	0.87 in 22 mm
Dimension SAA	4.72 in 120 mm

Radial and Thrust Factors

C0 - Static Load	54100 lbf 240000 N
C - Dynamic Load (Basic)	49900 lbf 222000 N
e - Geometry Factor	0.22
Y1 - Geometry Factor	3.14
Y2 - Geometry Factor	4.67

Engineering Seal Speed

Oil Lubrication - M/N Seal	1600 rpm
Oil Lubrication - T Seal	2900 rpm
Oil Lubrication - B/C/O Seal	1300 rpm
Grease Lubrication - M/N Seal	1600 rpm
Grease Lubrication - T Seal	2400 rpm
Grease Lubrication - B/C/O Seal	1300 rpm

Engineering Bearing Attributes

Float	0.083 in 2.108 mm
--------------	----------------------

Shaft Tolerance	0.0020 in 0.051 mm
------------------------	-----------------------

Engineering Internal Radial Clearance

Eng Internal Radial Clearance - Min	0.0020
--	--------

Eng Internal Radial Clearance - Max	0.0031
--	--------

Pre Install Clearance Min	0.0020 in 0.050 mm
----------------------------------	-----------------------

Pre Install Clearance Max	0.0031 in 0.080 mm
----------------------------------	-----------------------

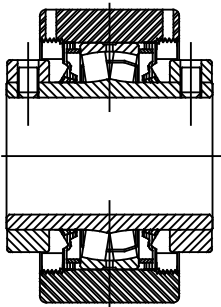
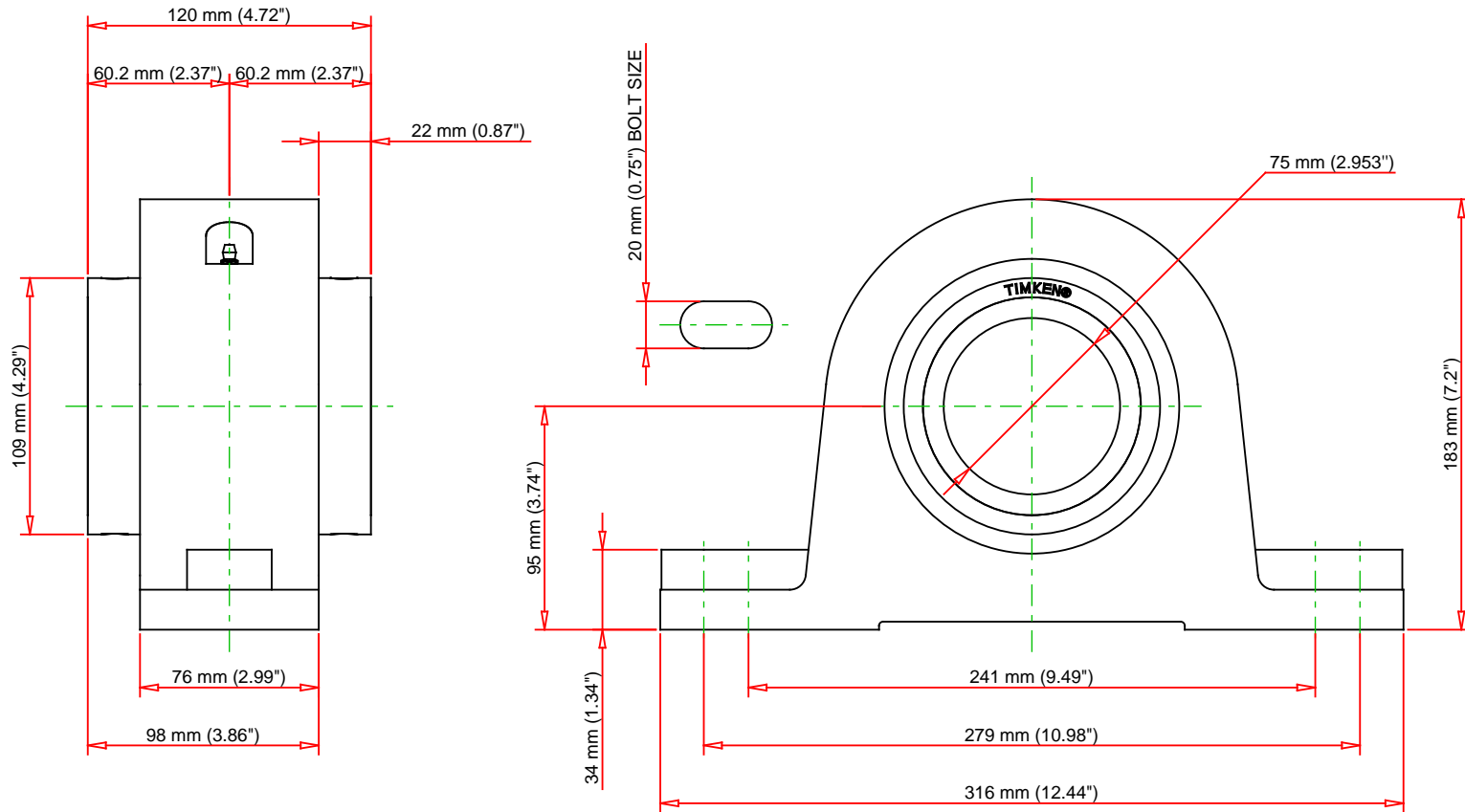

Note: Section View not to Scale

C - Dynamic Load	49900	lbf	222000	N
C0 - Static Load	54100	lbf	240000	N
Weight	46	lb	20.9	kg
Max. Speed T-Seals & Grease	2400	rpm		
Rad. Clearance - Max.	0.0031			

TIMKEN

THE TIMKEN COMPANY
NORTH CANTON, OHIO USA

QAASN15A075S

Double Concentric Two-Bolt Pillow
Block

Every reasonable effort has been made to ensure the accuracy of the information contained in this writing, but no liability is accepted for errors, omissions or for any other reason.

FOR DISCUSSION ONLY