



The Timken Company

4500 Mt Pleasant St. NW

N. Canton, OH 44720

Phone: (234) 262-3000

E-Mail: CustomerCAD@timken.com • **Web site:** www.timken.com

Part Number QMFX15J215S, Eccentric Four Bolt Square Flange Block

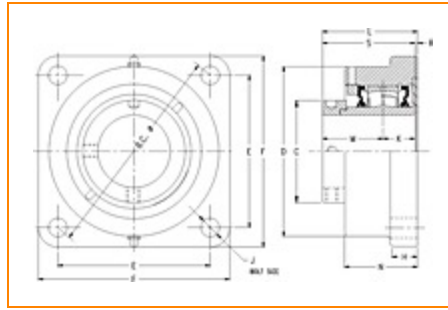

[Specifications](#) | [Dimensions](#) | [Radial and Thrust Factors](#) | [Engineering Seal Speed](#) | [Engineering Bearing Attributes](#) | [Engineering Internal Radial Clearance](#)

Specifications

Engineering Group Mounted Bearing

Bearing Number 22215

Shaft Size 2 15/16 in

Shaft Size Type Imperial

Full Timken Part Number

- QMFX15J215SB
- QMFX15J215SC
- QMFX15J215SEB
- QMFX15J215SEC
- QMFX15J215SEM
- QMFX15J215SEN
- QMFX15J215SEO
- QMFX15J215SET
- QMFX15J215SM
- QMFX15J215SN
- QMFX15J215SO



QMF15J215ST

Locking Style

Eccentric

Housing Construction

Four-Bolt Square Flange

UPC Code

0883450143660
 0883450143677
 0883450143684
 0883450143691
 0883450143707
 0883450143714
 0883450143721
 0883450143738
 0883450164818
 0883450165310
 0883450257114
 0883450257534

Dimensions**Dimension BC**

8.5 in
 215.9 mm

Dimension C

4.02 in
 102.1 mm

Dimension D

6.65 in
 168.9 mm

Dimension E

6.01 in
 152.7 mm

Dimension F

7.44 in
 189 mm

Dimension H

1.06 in
 26.9 mm

Dimension J (Bolt Size)

0.75 in
 20 mm

Dimension K

1.25 in
 31.8 mm

| | |
|------------------------|--------------------|
| Dimension L Exp | 3.86 in 98 mm |
| Dimension L Fix | 3.78 in 96 mm |
| Dimension M | 2.37 in 60.2 mm |
| Dimension N | 3 in 76.2 mm |
| Dimension R | 0.16 in 4.1 mm |
| Dimension S | 3.62 in 91.9 mm |

Radial and Thrust Factors

| | |
|---------------------------------|-----------------------|
| C0 - Static Load | 54100 lbf 240000 N |
| C - Dynamic Load (Basic) | 49900 lbf 222000 N |
| e - Geometry Factor | 0.22 |
| Y1 - Geometry Factor | 3.01 |
| Y2 - Geometry Factor | 4.48 |

Engineering Seal Speed

| | |
|--------------------------------------|----------|
| Oil Lubrication - M/N Seal | 1600 rpm |
| Oil Lubrication - T Seal | 2900 rpm |
| Oil Lubrication - B/C/O Seal | 1300 rpm |
| Grease Lubrication - M/N Seal | 1600 rpm |

| | |
|------------------------------------|----------|
| Grease Lubrication - T Seal | 2400 rpm |
|------------------------------------|----------|

| | |
|--|----------|
| Grease Lubrication - B/C/O Seal | 1300 rpm |
|--|----------|

Engineering Bearing Attributes

| | |
|--------------|----------------------|
| Float | 0.083 in 2.108 mm |
|--------------|----------------------|

| | |
|------------------------|-----------------------|
| Shaft Tolerance | 0.0020 in 0.051 mm |
|------------------------|-----------------------|

Engineering Internal Radial Clearance

| | |
|--|-------|
| Eng Internal Radial Clearance - Min | 0.002 |
|--|-------|

| | |
|--|--------|
| Eng Internal Radial Clearance - Max | 0.0031 |
|--|--------|

| | |
|----------------------------------|-----------------------|
| Pre Install Clearance Min | 0.0020 in 0.050 mm |
|----------------------------------|-----------------------|

| | |
|----------------------------------|-----------------------|
| Pre Install Clearance Max | 0.0031 in 0.080 mm |
|----------------------------------|-----------------------|

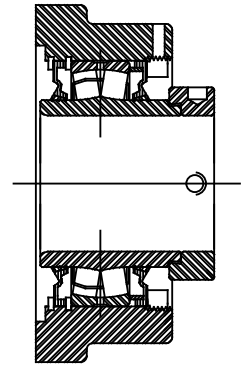
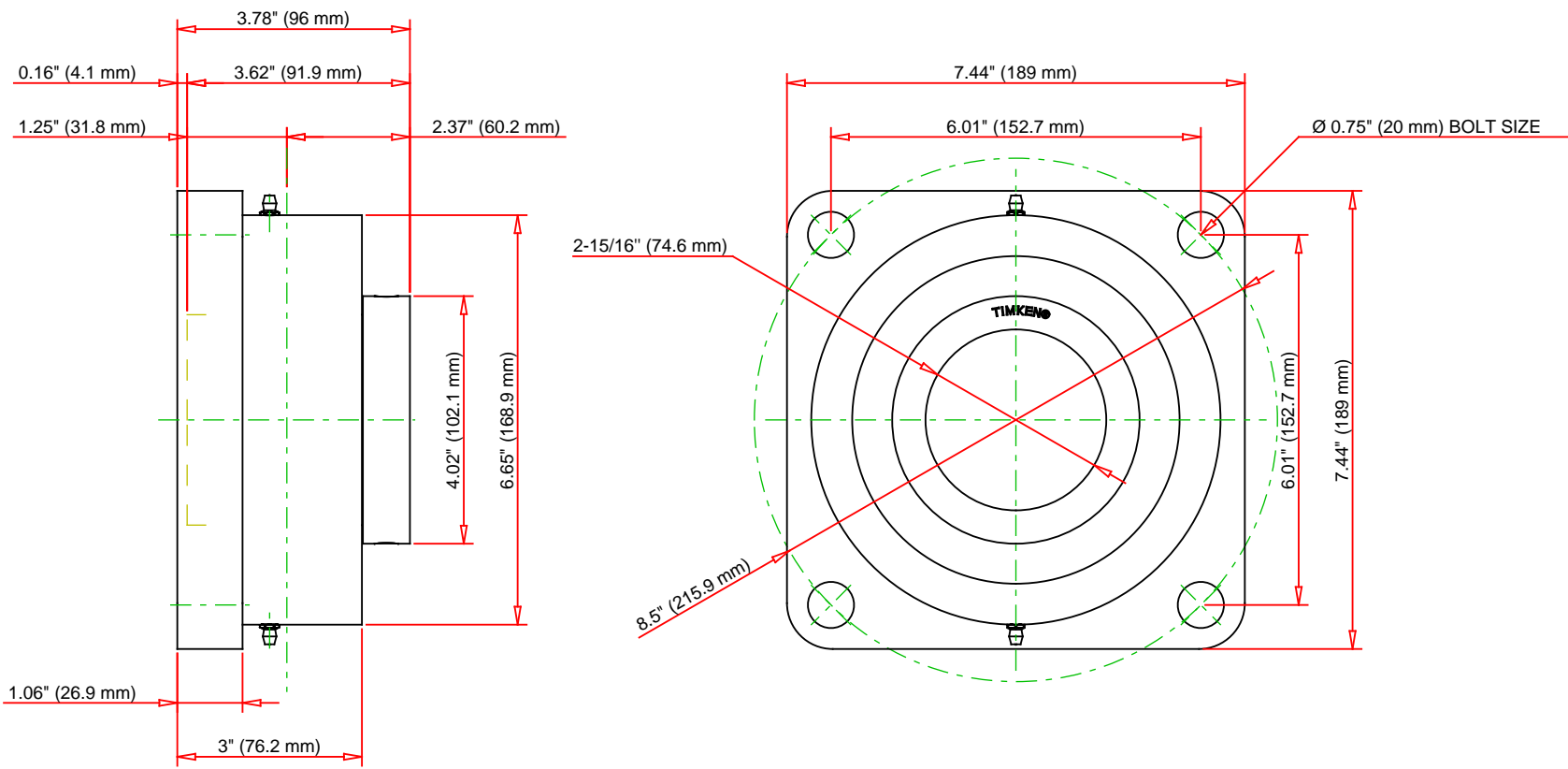

Note: Section View not to Scale

| | | | | |
|-----------------------------|--------|-----|--------|----|
| C - Dynamic Load | 49900 | lbf | 222000 | N |
| C0 - Static Load | 54100 | lbf | 240000 | N |
| Weight | 17 | lb | 7.7 | kg |
| Max. Speed T-Seals & Grease | 2400 | rpm | | |
| Rad. Clearance - Max. | 0.0031 | | | |

TIMKEN
THE TIMKEN COMPANY
NORTH CANTON, OHIO USA

QMF15J215S
Eccentric Four Bolt Square Flange
Block

Every reasonable effort has been made to ensure the accuracy of the information contained in this writing, but no liability is accepted for errors, omissions or for any other reason.

FOR DISCUSSION ONLY