



The Timken Company

4500 Mt Pleasant St. NW

N. Canton, OH 44720

Phone: (234) 262-3000

E-Mail: CustomerCAD@timken.com • **Web site:** www.timken.com

Part Number QAFL15A075S, Single Concentric Four Bolt Square Flange Block

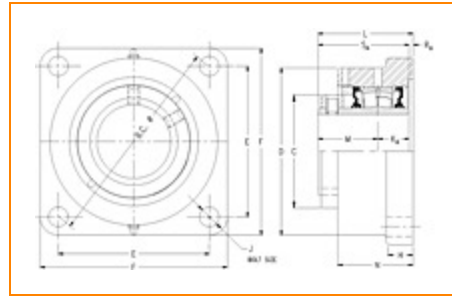

[Specifications](#) | [Dimensions](#) | [Radial and Thrust Factors](#) | [Engineering Seal Speed](#) | [Engineering Bearing Attributes](#) | [Engineering Internal Radial Clearance](#)

Specifications

Engineering Group Mounted Bearing

Bearing Number 22215

Shaft Size 75 mm

Shaft Size Type Metric

Full Timken Part Number

- QAFL15A075SB
- QAFL15A075SC
- QAFL15A075SEB
- QAFL15A075SEC
- QAFL15A075SEM
- QAFL15A075SEN
- QAFL15A075SEO
- QAFL15A075SET
- QAFL15A075SM
- QAFL15A075SN
- QAFL15A075SO



QAFL15A075ST

Locking Style Single Concentric

Housing Construction Four-Bolt Square Flange

UPC Code

0883450040204
0883450040211
0883450040235
0883450040242
0883450040259
0883450040266
0883450040273
0883450040280
0883450191388
0883450191548
0883450268745
0883450268905

Dimensions

Dimension BC 7.88 in
200.2 mm

Dimension C 4.5 in
114.3 mm

Dimension D 6.63 in
168.4 mm

Dimension E 5.56 in
141.2 mm

Dimension F 7.19 in
182.6 mm

Dimension H 1.06 in
26.9 mm

Dimension J (Bolt Size) 0.75 in
20 mm

Dimension KA 1.25 in
31.8 mm

Dimension L Exp	3.85 in 97.8 mm
------------------------	--------------------

Dimension L Fix	3.77 in 95.8 mm
------------------------	--------------------

Dimension M	2.37 in 60.2 mm
--------------------	--------------------

Dimension N	2.93 in 74.4 mm
--------------------	--------------------

Dimension RA	0.15 in 3.8 mm
---------------------	-------------------

Dimension SA	3.62 in 91.9 mm
---------------------	--------------------

Radial and Thrust Factors

C0 - Static Load	54100 lbf 240000 N
-------------------------	-----------------------

C - Dynamic Load (Basic)	49900 lbf 222000 N
---------------------------------	-----------------------

e - Geometry Factor	0.22
----------------------------	------

Y1 - Geometry Factor	3.01
-----------------------------	------

Y2 - Geometry Factor	4.48
-----------------------------	------

Engineering Seal Speed

Oil Lubrication - M/N Seal	1600 rpm
-----------------------------------	----------

Oil Lubrication - T Seal	2900 rpm
---------------------------------	----------

Oil Lubrication - B/C/O Seal	1300 rpm
-------------------------------------	----------

Grease Lubrication - M/N Seal	1600 rpm
--------------------------------------	----------

Grease Lubrication - T Seal	2400 rpm
------------------------------------	----------

Grease Lubrication - B/C/O Seal	1300 rpm
--	----------

Engineering Bearing Attributes

Float	0.083 in 2.108 mm
--------------	----------------------

Shaft Tolerance	0.0020 in 0.051 mm
------------------------	-----------------------

Engineering Internal Radial Clearance

Eng Internal Radial Clearance - Min	0.002
--	-------

Eng Internal Radial Clearance - Max	0.0031
--	--------

Pre Install Clearance Min	0.0020 in 0.050 mm
----------------------------------	-----------------------

Pre Install Clearance Max	0.0031 in 0.080 mm
----------------------------------	-----------------------

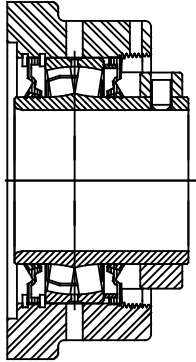
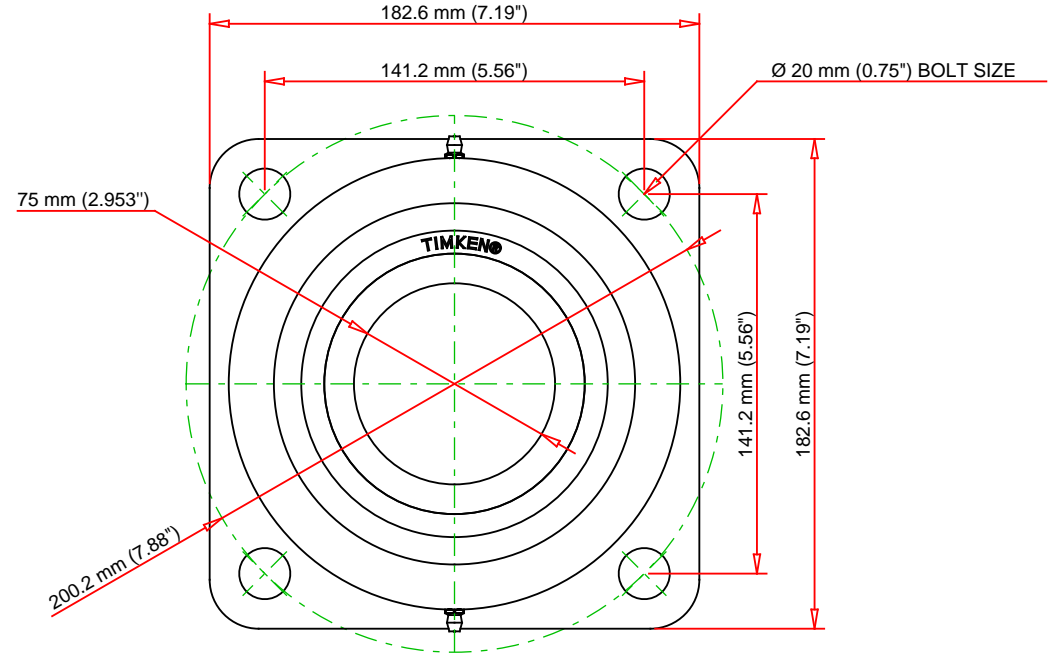
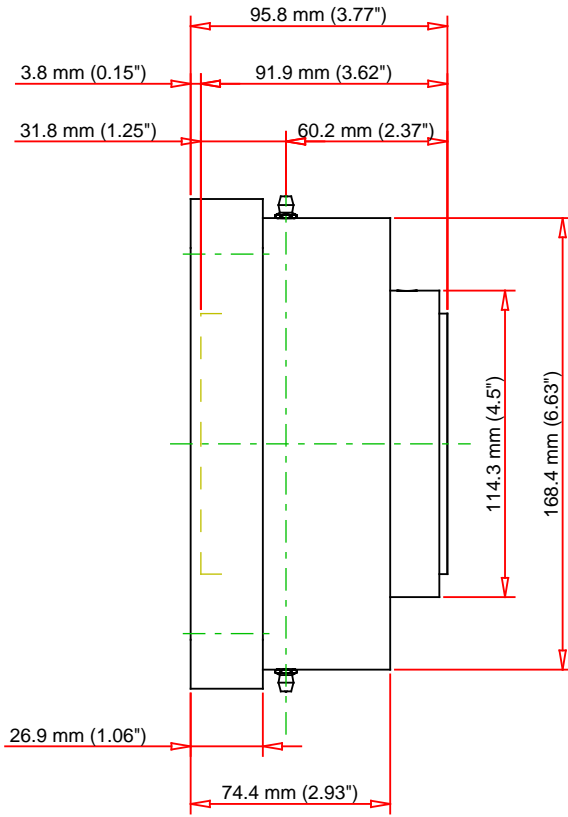

Note: Section View not to Scale

C - Dynamic Load	49900	lbf	222000	N
C0 - Static Load	54100	lbf	240000	N
Weight	23	lb	10.4	kg
Max. Speed T-Seals & Grease	2400	rpm		
Rad. Clearance - Max.	0.0031			

TIMKEN

THE TIMKEN COMPANY
NORTH CANTON, OHIO USA

QAFL15A075S

Single Concentric Four Bolt Square
Flange Block

Every reasonable effort has been made to ensure the accuracy of the information contained in this writing, but no liability is accepted for errors, omissions or for any other reason.

FOR DISCUSSION ONLY