



The Timken Company

4500 Mt Pleasant St. NW

N. Canton, OH 44720

Phone: (234) 262-3000

E-Mail: CustomerCAD@timken.com • **Web site:** www.timken.com

Part Number QAMC15A215S, Single Concentric Cartridge Block

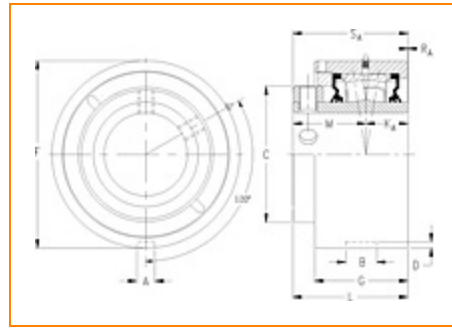

[Specifications](#) | [Dimensions](#) | [Radial and Thrust Factors](#) | [Engineering Seal Speed](#) | [Engineering Bearing Attributes](#) | [Engineering Internal Radial Clearance](#)

Specifications

Engineering Group Mounted Bearing

Bearing Number 22215

Shaft Size 2 15/16 in

Shaft Size Type Imperial

Full Timken Part Number

- QAMC15A215SB
- QAMC15A215SC
- QAMC15A215SEB
- QAMC15A215SEC
- QAMC15A215SEM
- QAMC15A215SEN
- QAMC15A215SEO
- QAMC15A215SET
- QAMC15A215SM
- QAMC15A215SMT
- QAMC15A215SN
- QAMC15A215SO



QAMC15A215ST

Locking Style	Single Concentric
Housing Construction	Cartridge
UPC Code	0883450043502 0883450043519 0883450043533 0883450043540 0883450043557 0883450043564 0883450043571 0883450043588 0883450194570 0883450194730 0883450271745 0883450271905 0883450399845

Dimensions

Dimension A	0.59 in 15 mm
Dimension B	1.03 in 26.2 mm
Dimension C	4.29 in 109 mm
Dimension D	0.25 in 6.4 mm
Dimension F	5 7/8 in 149.2 mm
Dimension G	3.14 in 79.8 mm
Dimension KA	1.25 in 31.8 mm

Dimension L Exp	4.04 in 102.6 mm
Dimension L Fix	3.96 in 100.6 mm
Dimension M	2.37 in 60.2 mm
Dimension RA	0.32 in 8.1 mm
Dimension SA	3.62 in 91.9 mm

Radial and Thrust Factors

C0 - Static Load	54100 lbf 240000 N
C - Dynamic Load (Basic)	49900 lbf 222000 N
e - Geometry Factor	0.22
Y1 - Geometry Factor	3.14
Y2 - Geometry Factor	4.67

Engineering Seal Speed

Oil Lubrication - M/N Seal	1600 rpm
Oil Lubrication - T Seal	2900 rpm
Oil Lubrication - B/C/O Seal	1300 rpm
Grease Lubrication - M/N Seal	1600 rpm
Grease Lubrication - T Seal	2400 rpm
Grease Lubrication - B/C/O Seal	1300 rpm

Engineering Bearing Attributes

Float	0.083 in 2.108 mm
Shaft Tolerance	0.0020 in 0.051 mm

Engineering Internal Radial Clearance

Eng Internal Radial Clearance - Min	0.0020
Eng Internal Radial Clearance - Max	0.0031
Pre Install Clearance Min	0.0020 in 0.050 mm
Pre Install Clearance Max	0.0031 in 0.080 mm

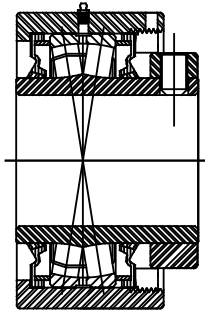
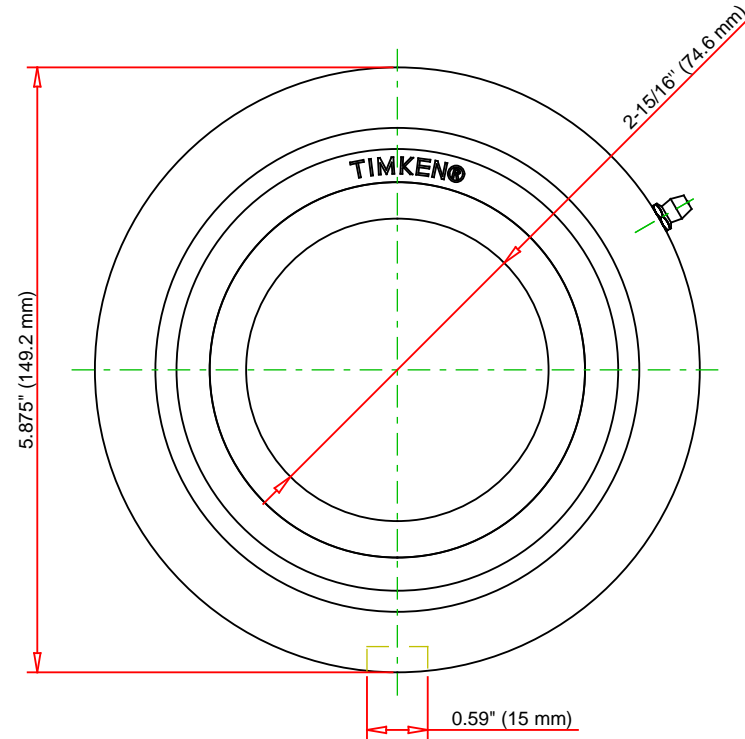
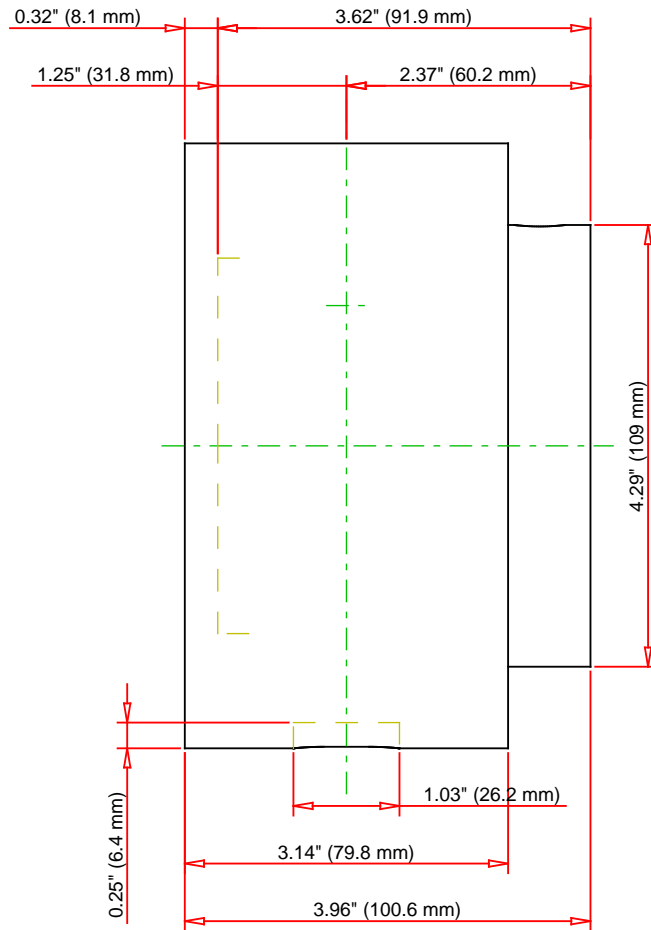

Note: Section View not to Scale

C - Dynamic Load	49900	lbf	222000	N
C0 - Static Load	54100	lbf	240000	N
Weight	18	lb	8.2	kg
Max. Speed T-Seals & Grease	2400	rpm		
Rad. Clearance - Max.	0.0031			

TIMKEN

THE TIMKEN COMPANY
NORTH CANTON, OHIO USA

QAMC15A215S
Single Concentric Cartridge Block

Every reasonable effort has been made to ensure the accuracy of the information contained in this writing, but no liability is accepted for errors, omissions or for any other reason.

FOR DISCUSSION ONLY