

The Timken Company

4500 Mt Pleasant St. NW

N. Canton, OH 44720

Phone: (234) 262-3000

E-Mail: CustomerCAD@timken.com • **Web site:** www.timken.com

Part Number QAMC18A303S, Single Concentric Cartridge Block



[Specifications](#) | [Dimensions](#) | [Radial and Thrust Factors](#) | [Engineering Seal Speed](#) | [Engineering Bearing Attributes](#) | [Engineering Internal Radial Clearance](#)

Specifications

Engineering Group	Mounted Bearing
Bearing Number	22218
Shaft Size	3 3/16 in
Shaft Size Type	Imperial
Full Timken Part Number	QAMC18A303SB QAMC18A303SC QAMC18A303SEB QAMC18A303SEC QAMC18A303SEM QAMC18A303SEN QAMC18A303SEO QAMC18A303SET QAMC18A303SM QAMC18A303SN QAMC18A303SO QAMC18A303ST



Locking Style	Single Concentric
Housing Construction	Cartridge
UPC Code	883450330480 883450330497 883450330503 883450330510 883450330527 883450330534 883450330541 883450330558 883450330565 883450330572 883450330589 883450330596

Dimensions

Dimension A	0.59 in 15 mm
Dimension B	1.06 in 26.9 mm
Dimension C	5.13 in 130.3 mm
Dimension D	0.23 in 5.8 mm
Dimension F	6.7500 in 171.5 mm
Dimension G	3.45 in 87.6 mm
Dimension KA	1.44 in 36.6 mm
Dimension L Exp	4.42 in 112.3 mm

Dimension L Fix	4.34 in 110.2 mm
------------------------	---------------------

Dimension M	2.59 in 65.8 mm
--------------------	--------------------

Dimension RA	0.29 in 7.4 mm
---------------------	-------------------

Dimension SA	4.03 in 102.4 mm
---------------------	---------------------

Radial and Thrust Factors

C0 - Static Load	87200 lbf 388000 N
-------------------------	-----------------------

C - Dynamic Load (Basic)	79700 lbf 355000 N
---------------------------------	-----------------------

e - Geometry Factor	0.23
----------------------------	------

Y1 - Geometry Factor	2.90
-----------------------------	------

Y2 - Geometry Factor	4.31
-----------------------------	------

Engineering Seal Speed

Oil Lubrication - M/N Seal	1400 rpm
-----------------------------------	----------

Oil Lubrication - T Seal	2400 rpm
---------------------------------	----------

Oil Lubrication - B/C/O Seal	1000 rpm
-------------------------------------	----------

Grease Lubrication - M/N Seal	1400 rpm
--------------------------------------	----------

Grease Lubrication - T Seal	2000 rpm
------------------------------------	----------

Grease Lubrication - B/C/O Seal	1000 rpm
--	----------

Engineering Bearing Attributes

Float	0.083 in 2.108 mm
--------------	----------------------

Shaft Tolerance	0.0030 in 0.076 mm
------------------------	-----------------------

Engineering Internal Radial Clearance

Eng Internal Radial Clearance - Min	0.0024
--	--------

Eng Internal Radial Clearance - Max	0.0039
--	--------

Pre Install Clearance Min	0.0024 in 0.060 mm
----------------------------------	-----------------------

Pre Install Clearance Max	0.0039 in 0.100 mm
----------------------------------	-----------------------

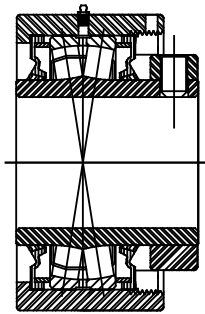
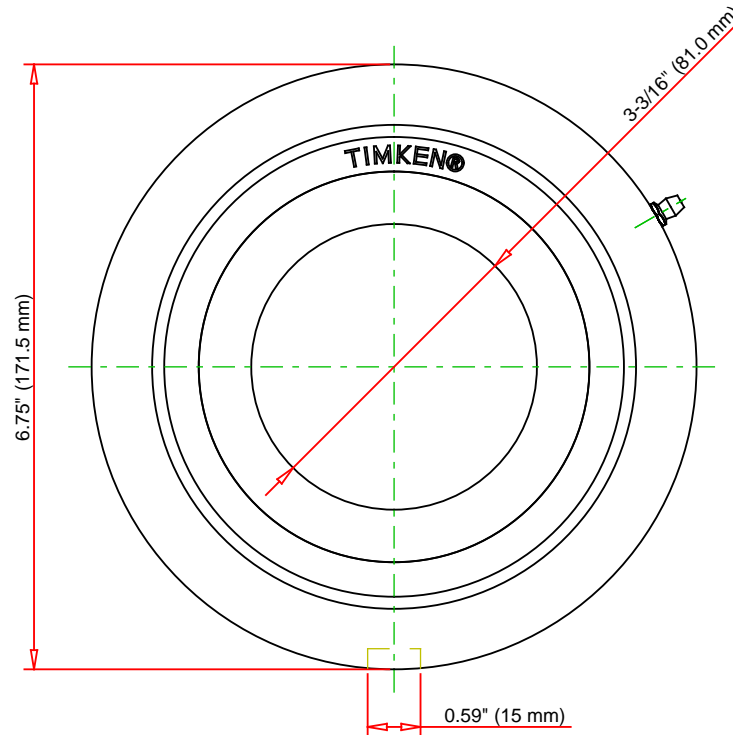
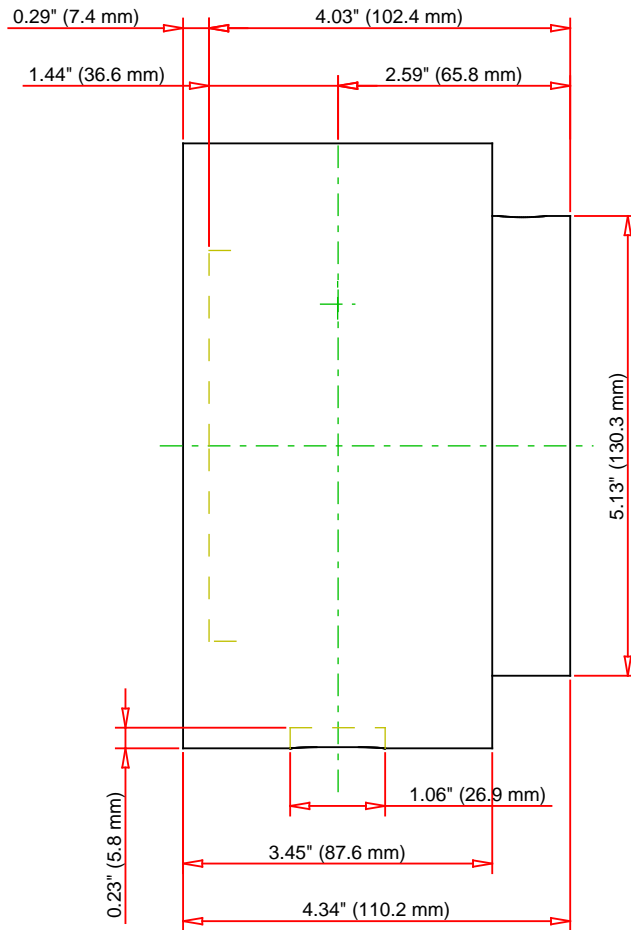

Note: Section View not to Scale

C - Dynamic Load	79700	lbf	355000	N
C0 - Static Load	87200	lbf	388000	N
Weight	26	lb	11.8	kg
Max. Speed T-Seals & Grease	2000	rpm		
Rad. Clearance - Max.	0.0039			

TIMKEN

THE TIMKEN COMPANY
NORTH CANTON, OHIO USA

QAMC18A303S
Single Concentric Cartridge Block

Every reasonable effort has been made to ensure the accuracy of the information contained in this writing, but no liability is accepted for errors, omissions or for any other reason.

FOR DISCUSSION ONLY