

**The Timken Company**

4500 Mt Pleasant St. NW

N. Canton, OH 44720

**Phone:** (234) 262-3000

**E-Mail:** [CustomerCAD@timken.com](mailto:CustomerCAD@timken.com) • **Web site:** [www.timken.com](http://www.timken.com)

## Part Number CS12STEEL, Steel Closed End Cover



[Specifications](#) | [Dimensions](#)
**Specifications**

<b>Type</b>	Closed
-------------	--------

**Dimensions**

<b>Outside Diameter</b>	4.3 in 109.2 mm
<b>Width</b>	1.79 in 45.5 mm
<b>Dimension F</b>	3.88 in 98.6 mm

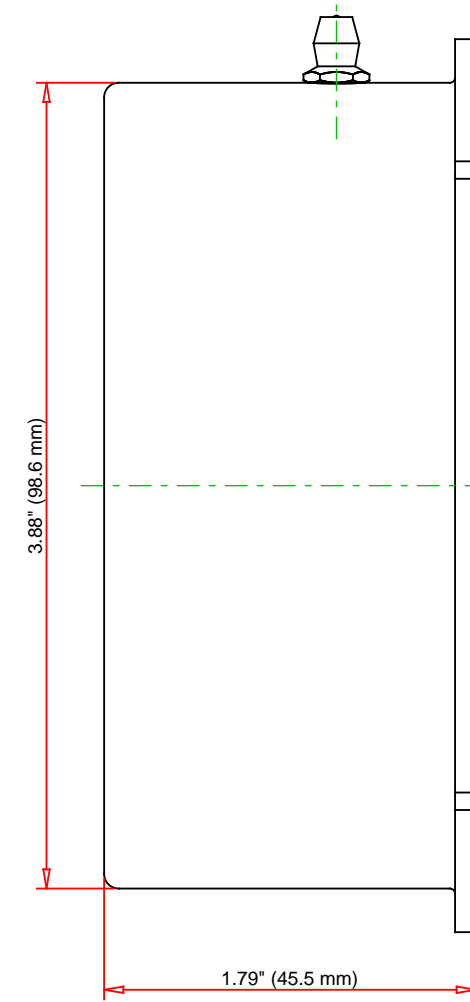
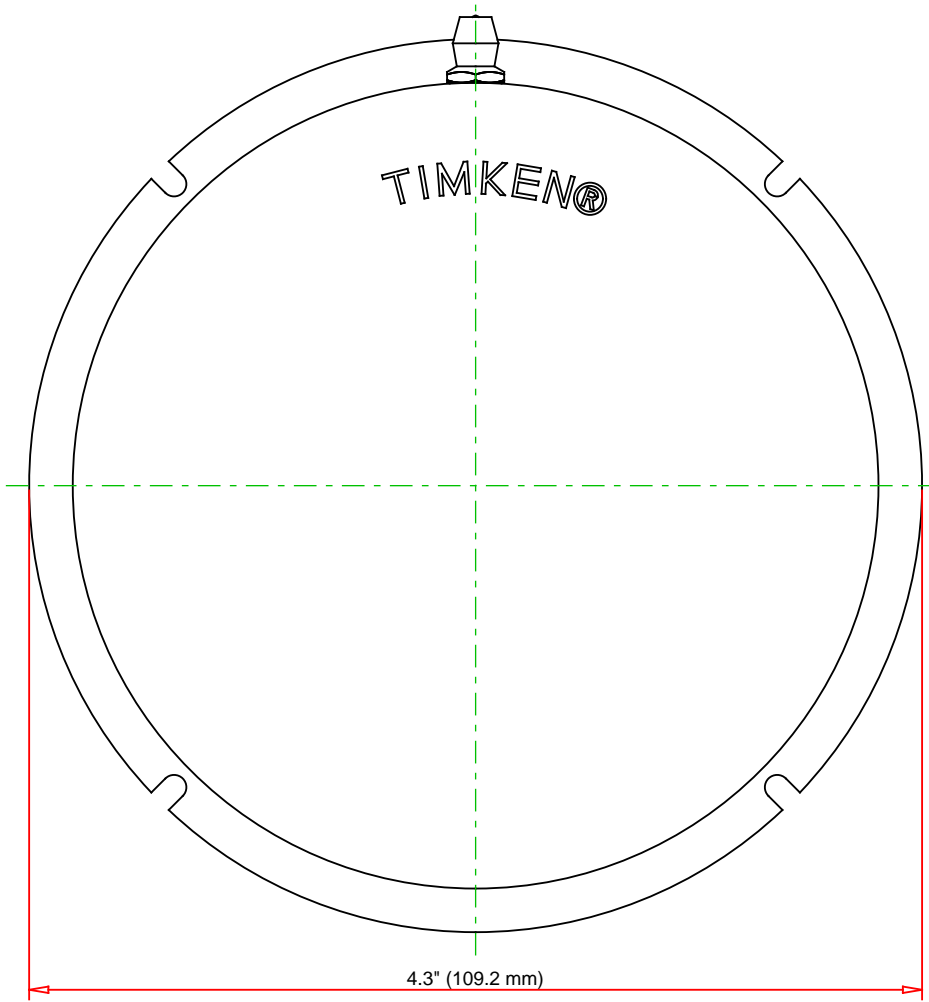



IMPERIAL UNITS

**TIMKEN**

THE TIMKEN COMPANY  
NORTH CANTON, OHIO USA

**CS12STEEL**  
Steel Closed End Cover

Every reasonable effort has been made to ensure the accuracy of the information contained in this writing, but no liability is accepted for errors, omissions or for any other reason.

**FOR DISCUSSION ONLY**