

The Timken Company

4500 Mt Pleasant St. NW

N. Canton, OH 44720

Phone: (234) 262-3000

E-Mail: CustomerCAD@timken.com • **Web site:** www.timken.com

Part Number QMTP20J311S, Eccentric Top Pull Take-Up Block



[Specifications](#) | [Dimensions](#) | [Radial and Thrust Factors](#) | [Engineering Seal Speed](#) | [Engineering Bearing Attributes](#) | [Engineering Internal Radial Clearance](#)

Specifications

Engineering Group	Mounted Bearing
Bearing Number	22220
Shaft Size	3 11/16 in
Shaft Size Type	Imperial
Full Timken Part Number	QMTP20J311SM
Locking Style	Eccentric
Housing Construction	Top Pull Take-Up

Dimensions

**Dimension A1**4.76 in
121 mm**Dimension B**4.63 in
117.6 mm**Dimension C**6 in
152.5 mm**Dimension D**11.38 in
289.1 mm**Dimension E**9.25 in
234.9 mm**Dimension F**2.5 in
63.5 mm**Dimension G**3.13 in
79.5 mm**Dimension H**5.5 in
139.7 mm**Dimension J**2.31 in
58.7 mm**Dimension K**1.63 in
41.3 mm**Dimension L**11 in
279.4 mm**Dimension M**2.97 in
75.5 mm**Dimension N**4.97 in
126.1 mm**Dimension P**10.5 in
266.7 mm**Dimension Q**1.31 in
33.3 mm

Dimension R	0.37 in 9.4 mm
Dimension S	1.38 in 35.1 mm
Dimension T	4.6 in 116.8 mm
Dimension U	0.81 in 20.6 mm

Radial and Thrust Factors

C0 - Static Load	113000 lbf 502000 N
C - Dynamic Load (Basic)	97700 lbf 435000 N
e - Geometry Factor	0.24
Y1 - Geometry Factor	2.85
Y2 - Geometry Factor	4.24

Engineering Seal Speed

Oil Lubrication - M/N Seal	1200 rpm
Oil Lubrication - T Seal	2000 rpm
Oil Lubrication - B/C/O Seal	900 rpm
Grease Lubrication - M/N Seal	1200 rpm
Grease Lubrication - T Seal	1600 rpm
Grease Lubrication - B/C/O Seal	900 rpm

Engineering Bearing Attributes

Float	0.08 in 2.03 mm
Shaft Tolerance	0.0030 in 0.076 mm

Engineering Internal Radial Clearance

Eng Internal Radial Clearance - Min	0.0030
Eng Internal Radial Clearance - Max	0.0047
Pre Install Clearance Min	0.0030 in 0.075 mm
Pre Install Clearance Max	0.0047 in 0.120 mm

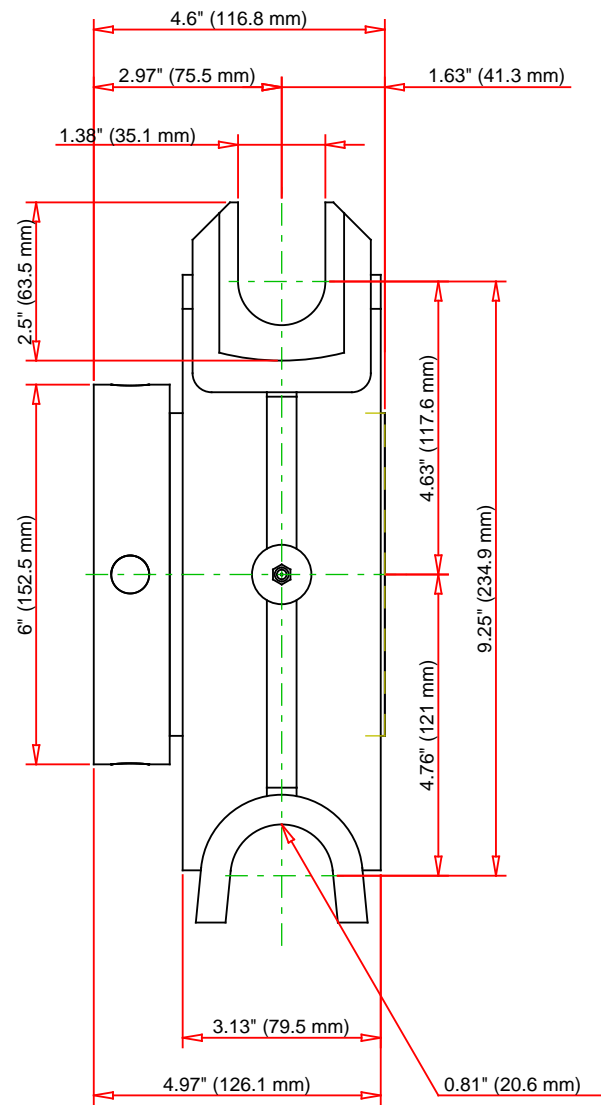
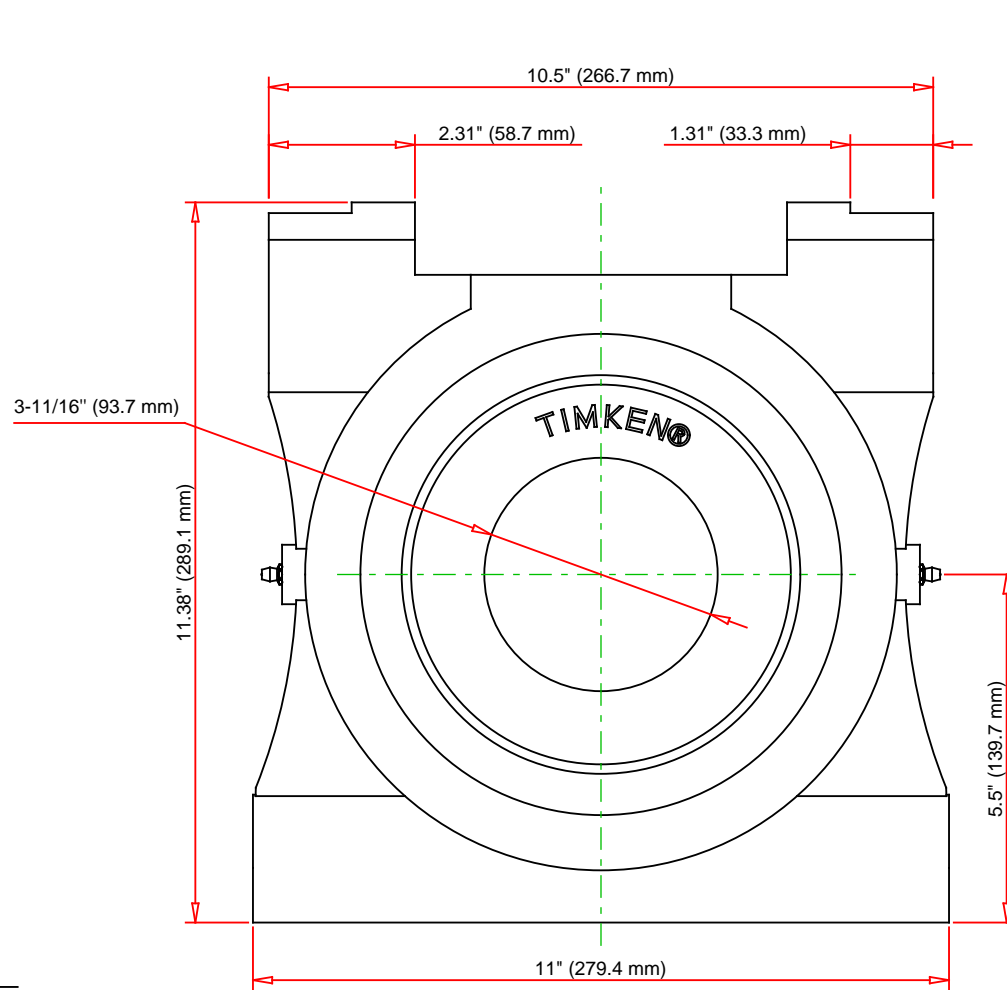

Note: Section View not to Scale

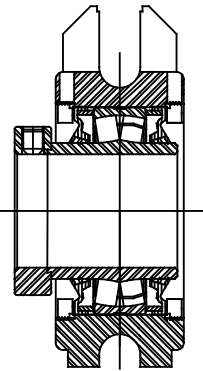

C - Dynamic Load	97700	lbf	435000	N
C0 - Static Load	113000	lbf	502000	N
Weight		lb		kg
Max. Speed T-Seals & Grease	1600	rpm		
Rad. Clearance - Max.	0.0047			

TIMKEN

THE TIMKEN COMPANY
NORTH CANTON, OHIO USA

QMTP20J311S

Eccentric Top Pull Take-Up Block

Every reasonable effort has been made to ensure the accuracy of the information contained in this writing, but no liability is accepted for errors, omissions or for any other reason.

FOR DISCUSSION ONLY