

BALDOR • RELIANCE

Customer information packet

34L47-5871G1

1HP, 1725RPM, 1PH, 60HZ, 56, 3432L, TENV, F1, N

Class - None

Division - Not Applicable

Specifications

Enclosure	TENV
Frame	56
Frame Material	Steel
Frequency	60.00 Hz
Haz Area Class and Group	None
Haz Area Division	Not Applicable
Motor Letter Type	Cap Start, Induction Run
Output @ Frequency	1.000 HP @ 60 HZ
Phase	1
Synchronous Speed @ Frequency	1800 RPM @ 60 HZ
Voltage @ Frequency	115.0 V @ 60 HZ 230.0 V @ 60 HZ
Agency Approvals	UR CSA
Ambient Temperature	40 °C
Auxillary Box	No Auxillary Box
Auxillary Box Lead Termination	None
Base Indicator	Resilient
Bearing Grease Type	Polyrex EM (-20F +300F)
Blower	None
Current @ Voltage	13.000 A @ 115.0 V 6.500 A @ 230.0 V
Design Code	N
Drip Cover	No Drip Cover
Duty Rating	AIR OVER
Efficiency @ 100% Load	68.0 %
Electrically Isolated Bearing	Not Electrically Isolated
Feedback Device	NO FEEDBACK
Front Face Code	Resilient Mount
Front Shaft Indicator	None
Heater Indicator	No Heater
High Voltage Full Load Amps	6.5 a

Part detail

Revision	Y
Type	AC
Mech. spec.	34L047
Base	
Status	PRD/A
Elec. spec.	34WG5871
Layout	34LYL047
Eff. date	09-18-2023
CD Diagram	CD0052
Poles	04
Leads	6#18,1#14 #1TH
Proprietary	False
Created date	01-01-0001

Insulation Class	B
Inverter Code	Not Inverter
KVA Code	G
Lifting Lugs	No Lifting Lugs
Locked Bearing Indicator	No Locked Bearing
Motor Lead Exit	Terminal Panel
Motor Lead Quantity/Wire Size	6 @ 18 AWG
Motor Lead Termination	Flying Leads
Motor Standards	NEMA
Motor Type	3432L
Mounting Arrangement	F1
Number of Poles	4
Overall Length	12.97 IN
Power Factor	72
Product Family	General Purpose
Pulley End Bearing Type	Ball
Pulley Face Code	Resilient Mount
Pulley Shaft Indicator	Standard
Rodent Screen	None
Service Factor	1.00
Shaft Diameter	0.625 IN
Shaft Extension Location	Pulley End
Shaft Ground Indicator	No Shaft Grounding
Shaft Rotation	Reversible: Connected Standard
Shaft Slinger Indicator	No Slinger
Speed	1725 rpm
Speed Code	Single Speed
Starting Method	Direct on line
Thermal Device - Bearing	None
Thermal Device - Winding	None
Vibration Sensor Indicator	No Vibration Sensor
Winding Thermal 1	Automatic Thermal Overload
Winding Thermal 1 Location	SB
Winding Thermal 2	None

Nameplate

NP1257L									
CAT.NO.									
SPEC.	34L47-5871G1								
HP	1								
VOLTS	115/208-230								
AMP	13/7-6.5								
RPM	1725								
FRAME	56			HZ	60		PH	1	
SER.F.	1.15	CODE	G	DES	N	CL	B		
NEMA-NOM-EFF	68	PF	72						
RATING	40C AMB-AIR OVER								
CC									
DE	6203	ODE	6203						
ENCL	TENV	SN							

AC Induction Motor Performance Data

Record # 6829

Typical performance - not guaranteed values

Winding: 34WG5871-R001		Type: 3432L		Enclosure: TEAO	
Nameplate Data			230 V, 60 Hz: High Voltage Connection		
Rated Output (HP)	1		Full Load Torque	3 LB-FT	
Volts	115/230		Start Configuration	direct on line	
Full Load Amps	13/6.5		Breakdown Torque	6.5 LB-FT	
R.P.M.	1725		Pull-up Torque	6 LB-FT	
Hz	60	Phase	1	Locked-rotor Torque	11 LB-FT
NEMA Design Code	N	KVA Code	G	Starting Current	29 A
Service Factor (S.F.)	1		No-load Current	3.8 A	
NEMA Nom. Eff.	68	Power Factor	72	Line-line Res. @ 25°C	2.2 Ω A Ph 1.1 Ω B Ph
Rating - Duty	40C AMB-AIR OVER		Temp. Rise @ Rated Load		

Load Characteristics 230 V, 60 Hz, 1 HP

% of Rated Load	25	50	75	100	125	150
Power Factor	38	54	67	67	77	79
Efficiency	53.7	67.5	72.5	73.9	73.4	71.3
Speed	1782	1767	1750	1731	1709	1682
Line amperes	4	4.5	5	6.5	7	8.3

ABB Motors and Mechanical Inc.

WINDING # 34WG5871

Typical performance - not guaranteed values.

1 HP 1 PH 60 HZ 1725 RPM 230 V 3432L

TORQUES (LB-FT): PO=6.5 PU=6 LR=11 LRA=29

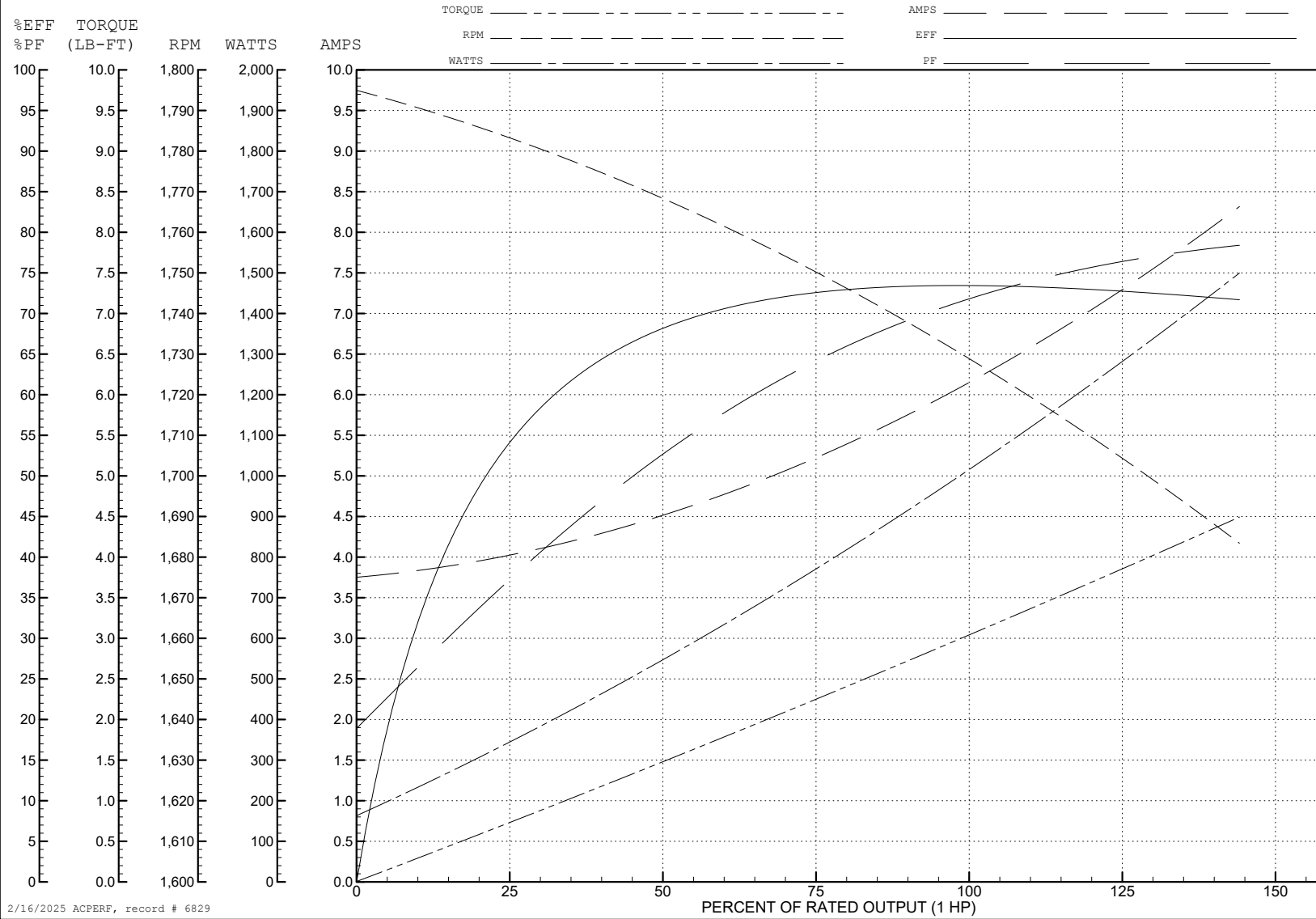

2/16/2025 ACPERF, record # 6829

34L047

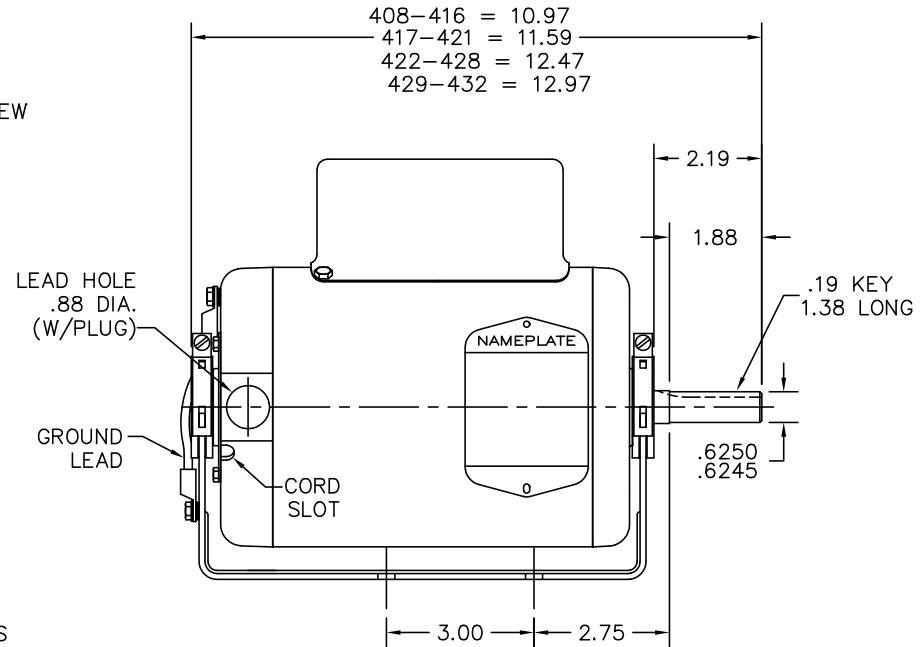
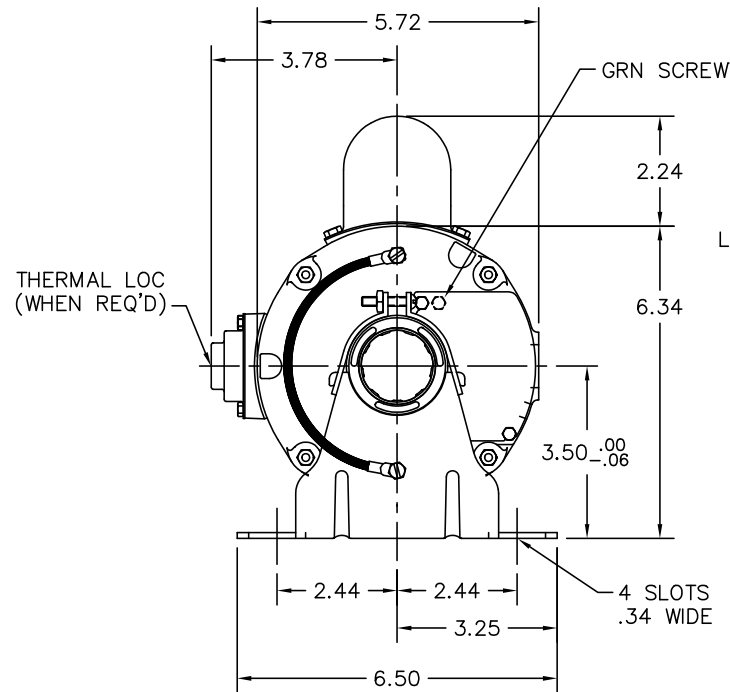

CUST. NAME		CUST. P.O.		CERTIFIED BY		MODEL		INSUL		AMB	
H.P.		MTG		TYPE		R.P.M.		VOLTS		ENCL	
PHASE		FREQ		FRAME		REMARKS:					
REV:	A	MOVED TO ACAD AND TEXT TO TDB									
34L047		REF: 34K020		BY: WMB		REVISED: 04/23/97		BALDOR ELECTRIC Co.			
		FILE: AAA00039811		TDR: 0113005		HORZ 34L NEMA 56 TENV RESIL MTG W/TERM. PLATE & 35 CAPAC.					

34L047

CD0052

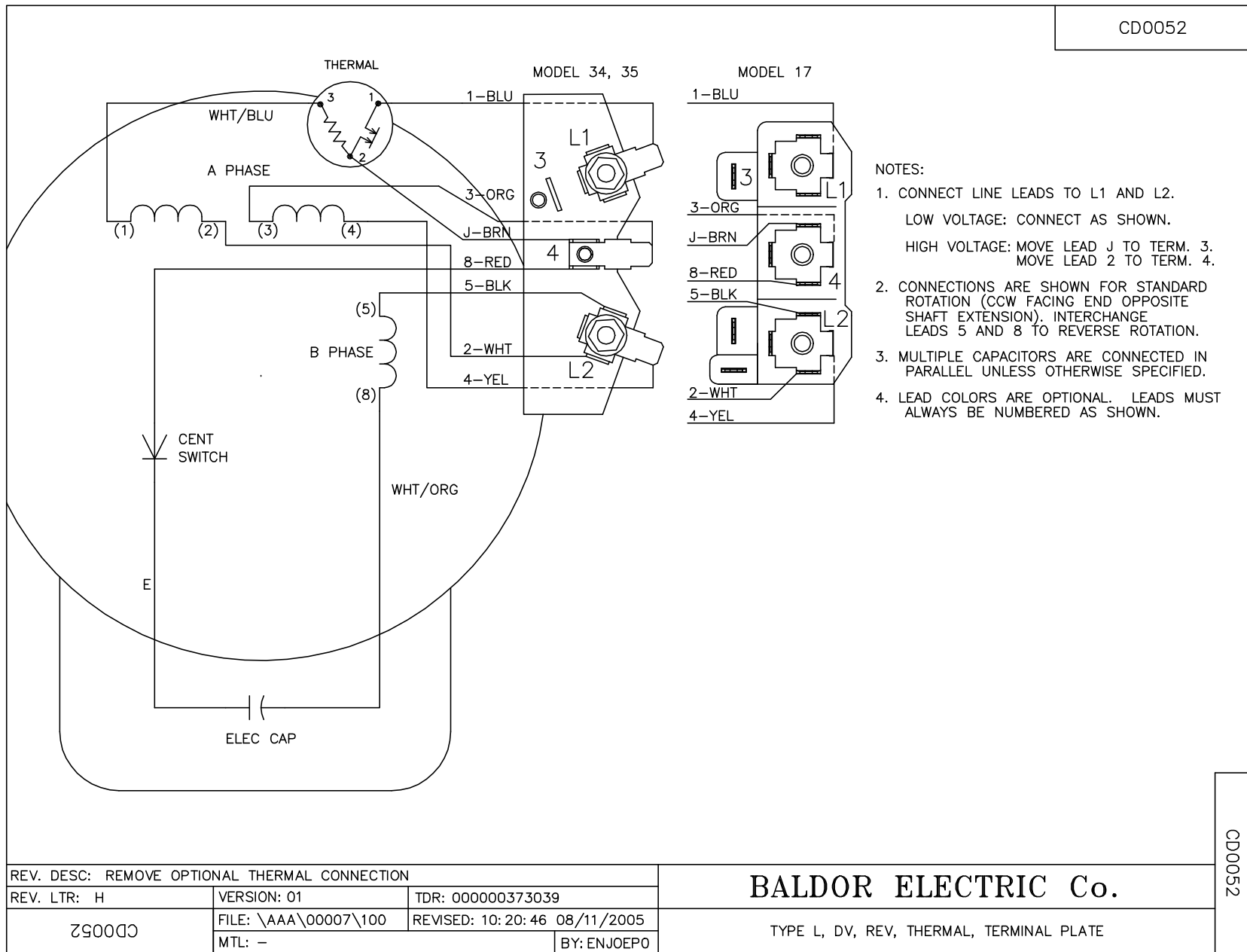

REV. DESC: REMOVE OPTIONAL THERMAL CONNECTION		
REV. LTR: H	VERSION: 01	TDR: 000000373039
CD0052	FILE: \AAA\00007\100	REVISED: 10:20:46 08/11/2005
	MTL: -	BY: ENJOEPO

BALDOR ELECTRIC Co.

TYPE L, DV, REV, THERMAL, TERMINAL PLATE

CD0052