

BFNXXX

CUSTOMER DWG

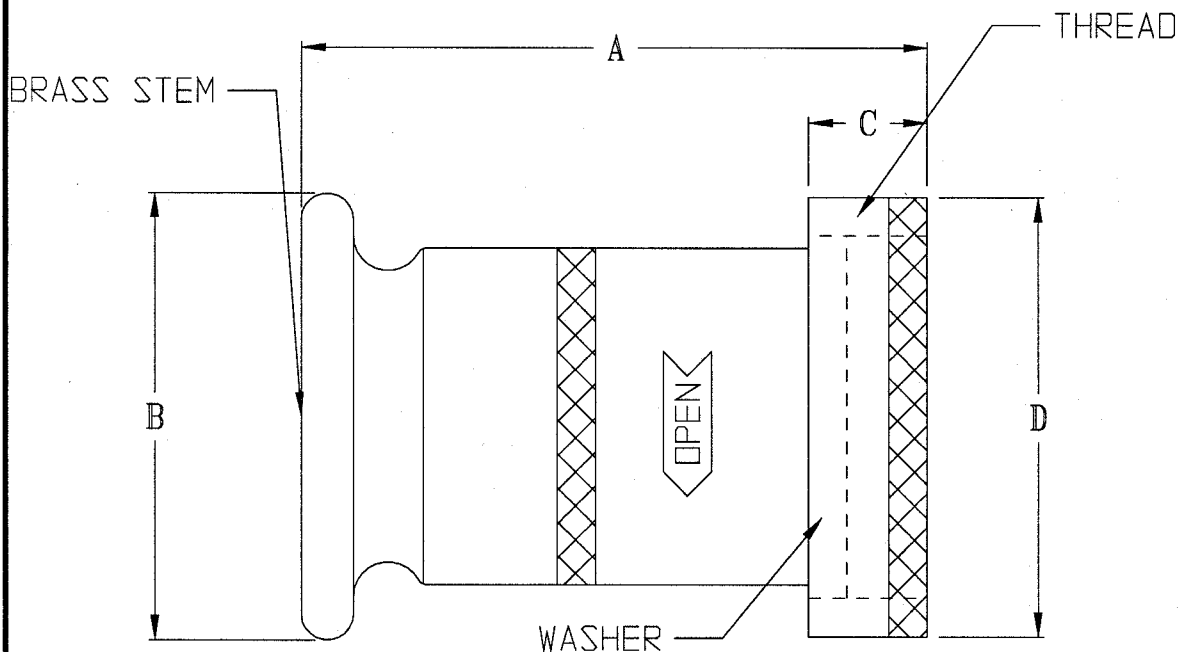

AGREEMENT TO MAINTAIN CONFIDENTIALITY

This drawing is owned by Dixon Valve & Coupling Co. and shall be returned upon demand. It is loaned on condition that it shall not be copied or reproduced or submitted to others without the owners consent. In accepting it subject to this condition the recipient further agrees that this drawing or any design detail or concept disclosed herein shall not be used in any way detrimental to or in competition with the Owner. If the recipient does not agree to the terms of this agreement, they shall return this drawing immediately.

NOTES:

- 1) THREAD IDENTIFICATION NOT INDICATED.
- 2) WASHER IDENTIFICATION #'S.

WASHER NOZZLE

BFN100	NPSH	1"	3 3/4	3 1/4	2 1/8	3/4	1 7/8
BFN150	NPSH	1 1/2"	3 3/4	3 1/4	2 5/16	5/8	2 9/32
BFN200	NPSH	2"	5	4 1/2	3 1/4	3/4	2 5/8
BFN150NST	NST	1 1/2"	3 3/4	3 1/4	2 5/16	5/8	2 9/32
BFNE150	NPSH	1 1/2"	3 3/4	3 1/4	2 5/16	5/8	2 9/32
BFNE150NST	NST	1 1/2"	3 3/4	3 1/4	2 5/16	5/8	2 9/32
PART#	THREAD	SIZE	A CLOSED	A OPEN	B	C	D

CUSTOMER DWG

DIXON VALVE & COUPLING CO.
U. S. A.

TITLE BRASS INDUSTRIAL FOG NOZZLES
WITH BUMPER

DRAWN BY: *[Signature]* 06/03/96
CHECKED BY: *Diore C.* 4/3/96
APPROVAL: *[Signature]* 6/13/96

MAT'L BRASS

BFNXXX

