

Lever Guns

Description

Models 6243-J3 and 6679-J3 heavy-duty, lever guns are designed to handle fibrous, heavy- or lightbodied lubricants. Both models are spring primed and equipped with a special loader fitting, a check valve and an extra long handle for maximum leverage.

These units can be loaded with a 14 oz. lubricant cartridge or with 24 oz. of bulk grease by either the suction-filling method, or by a loader pump.

Specifications

Capacity 24 oz. bulk or 14 oz. cartridge
Pressure Capabilities (Model 6243-J3) .. 10,000 PSI
(Model 6679-J3) 5000 PSI
Delivery (Model 6243-J3) 1 oz./20 strokes
(Model 6679-J3) 1 oz./10 strokes
Gun Outlet 1/4 N.P.T.F.

Preparing for Operation

Attach extension (not supplied) or hose assembly (not supplied) with appropriate type coupler to unit and prepare for operation by filling lever gun as follows:

Cartridge Loading

1. Separate head assembly from cylinder.
2. Pull follower rod out and engage first groove on follower rod with offset hole in end cap (Figure 5).
3. Remove cap from end of cartridge and insert opened end into cylinder.
4. Remove seal from other end of cartridge.
5. Screw head assembly onto cylinder.
6. Release follower rod from end cap offset hole and push into cylinder.

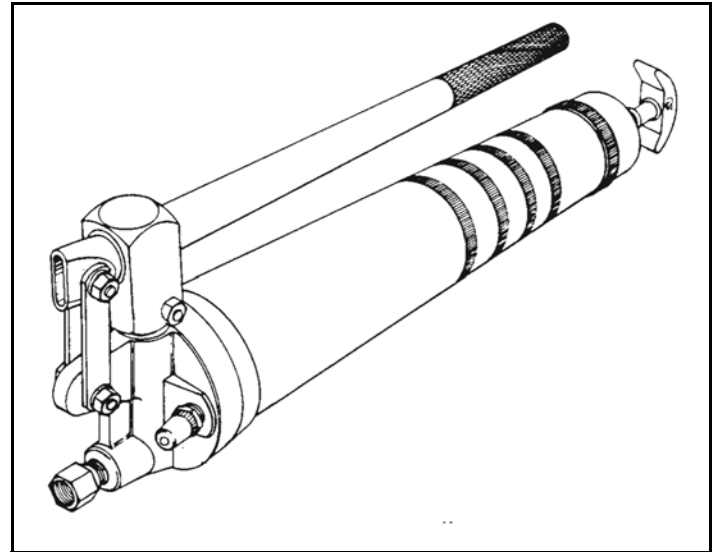

Figure 1 Model 6243-J3 or 6679-J3 Lever Gun

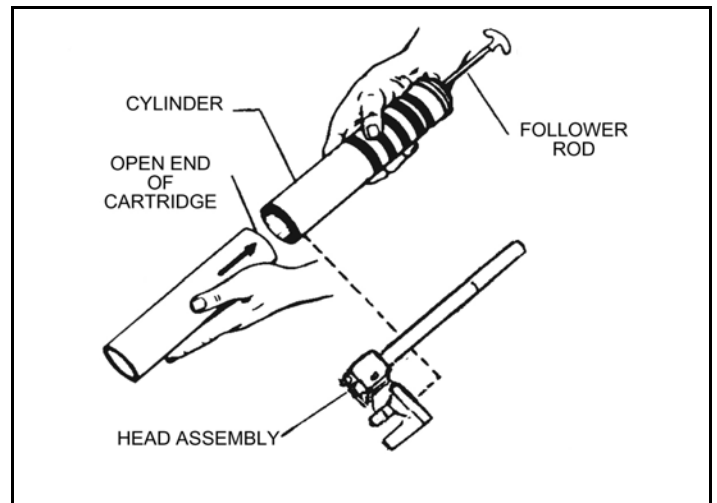

Figure 2 Cartridge Loading

Suction Filling

ATTENTION

If an extremely heavy lubricant is used, it may be necessary to pack lubricant by hand, using a clean paddle or putty knife, rather than employing the suction method. These two means of filling should be done with follower rod engaged in offset hole in end cap. Follower rod should show both grooves to enable cylinder to be filled completely.

When using medium weight lubricants, perform the steps following:

1. Remove head assembly from cylinder.
2. Insert open end of cylinder two inches below surface of lubricant.
3. Slowly pull back follower rod, drawing in lubricant until second groove in follower rod can be engaged with the offset hole in end cap.
4. Screw head assembly onto cylinder.
5. Release follower rod from end cap offset hole and push into cylinder.

Bulk Loading

(Using loader pump):

CAUTION

These guns are equipped with a bulk loader fitting for use with hand powered, low pressure loader pumps. Modification to substitute a high pressure grease fitting so that air or electric powered pumps can be used for loading can result in damage to the gun and serious personal injury. This will also void the warranty.

1. Wipe loader fitting B322610 (Figure 6) clean of any material.
2. Pull back and rotate follower rod to engage locking tab in "twist-lock" slot on follower backup plate (Figure 5).
3. Insert loader fitting into valve of loader pump.
4. Operate loader pump to fill cylinder until second groove on follower rod is exposed.

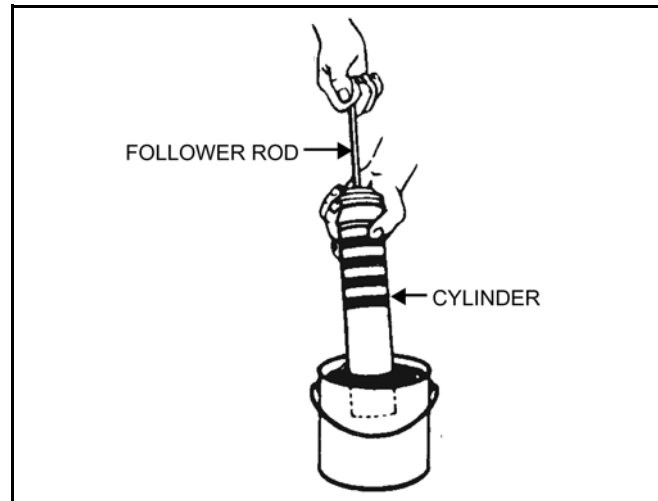

Figure 3 *Suction Filling*

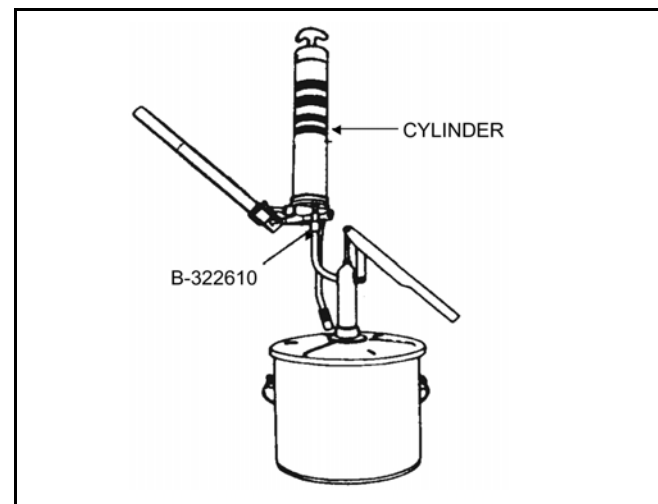

Figure 4 *Bulk Loading*

5. Disengage "twist-lock" and push follower rod into cylinder.

Operation

1. Clean any dirt or grease from the fitting to be lubricated.
2. Attach the coupling end of the extension or hose assembly to the lubrication fitting.
3. Operate the lever until desired amount of lubricant is dispensed.

CAUTION

These guns can develop up to 10,000 psi pressure. Excessive lubrication may damage equipment.

4. Remove coupler by tilting sideways and rolling off of fitting.

Maintenance

Packing screw should be checked occasionally for snug fit to prevent leakage. If leakage persists after screw has been fully tightened, check piston for damage and/or replace jewett ring packing (Figure 6).

Common causes of gun malfunction are air pockets, malfunctioning check valves, and defective lubricant cartridges. If gun fails to pump lubricant, follow these steps:

1. Loosen head assembly from cylinder.
2. Pull out follower rod and engage locking tab in "twist-lock" slot on follower backup plate (Figure 5).
3. Slowly push follower inward, toward head to eliminate air pockets.
4. Tighten head assembly to cylinder.
5. If pumping on lever now sends lubricant through coupler, disengage locking tab from "twist-lock" slot and push follower rod into container.

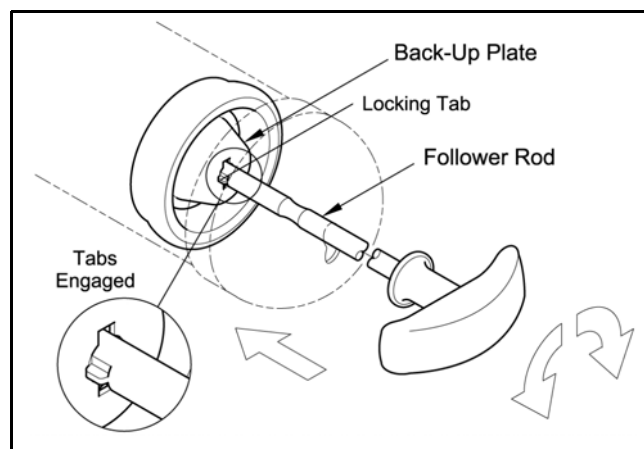

Figure 5 "Twist Lock" Follower

6. If lubricant still does not pump out, sharply tap gun head on a block of wood several times.

CAUTION

Do not tap gun head on hard surfaces such as metal or concrete.

7. Pump lever until lubricant appears at coupler.

NOTE: If using lubricant cartridge, and problem persists after performing steps 1 through 7, discard defective cartridge and replace with a new one. If cartridge has an irregular inner surface, the steps above probably will not force gun to pump lubricant.

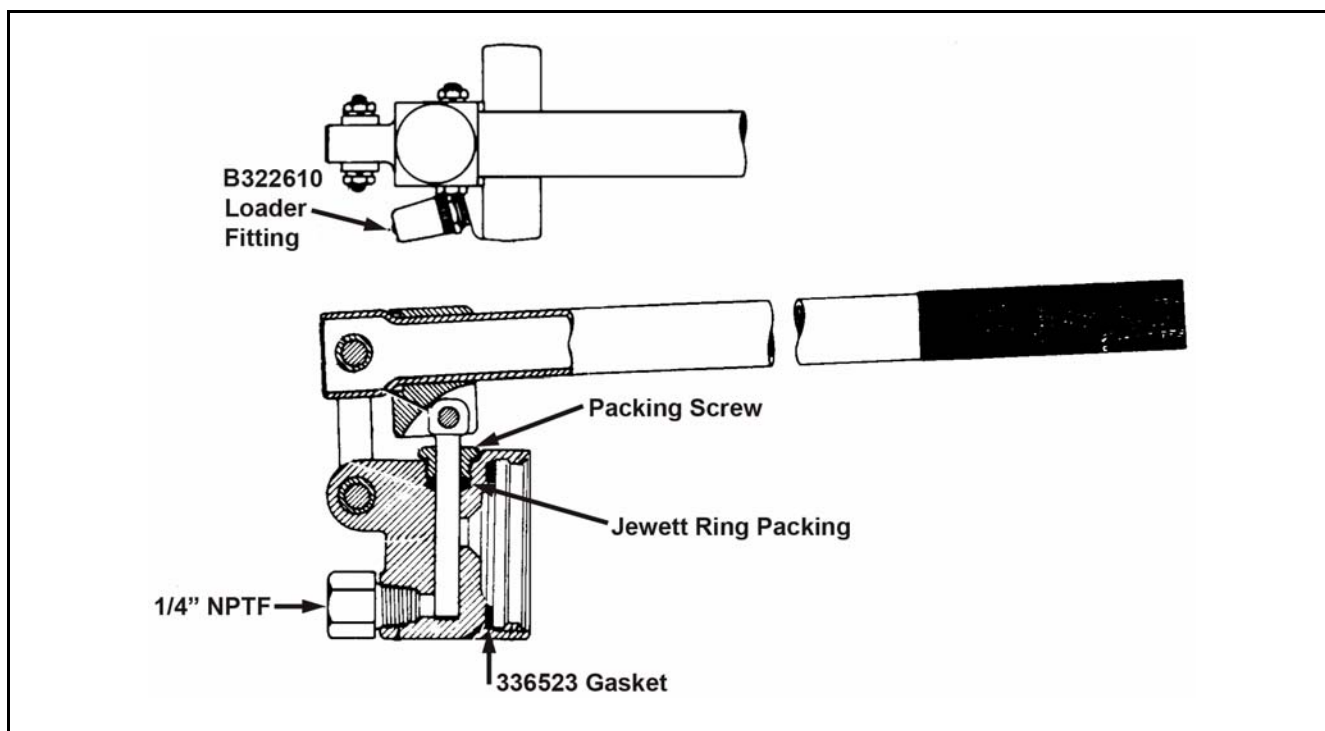

Figure 6 Head Assembly for Models 6243-J3 and 6679-J3 Guns

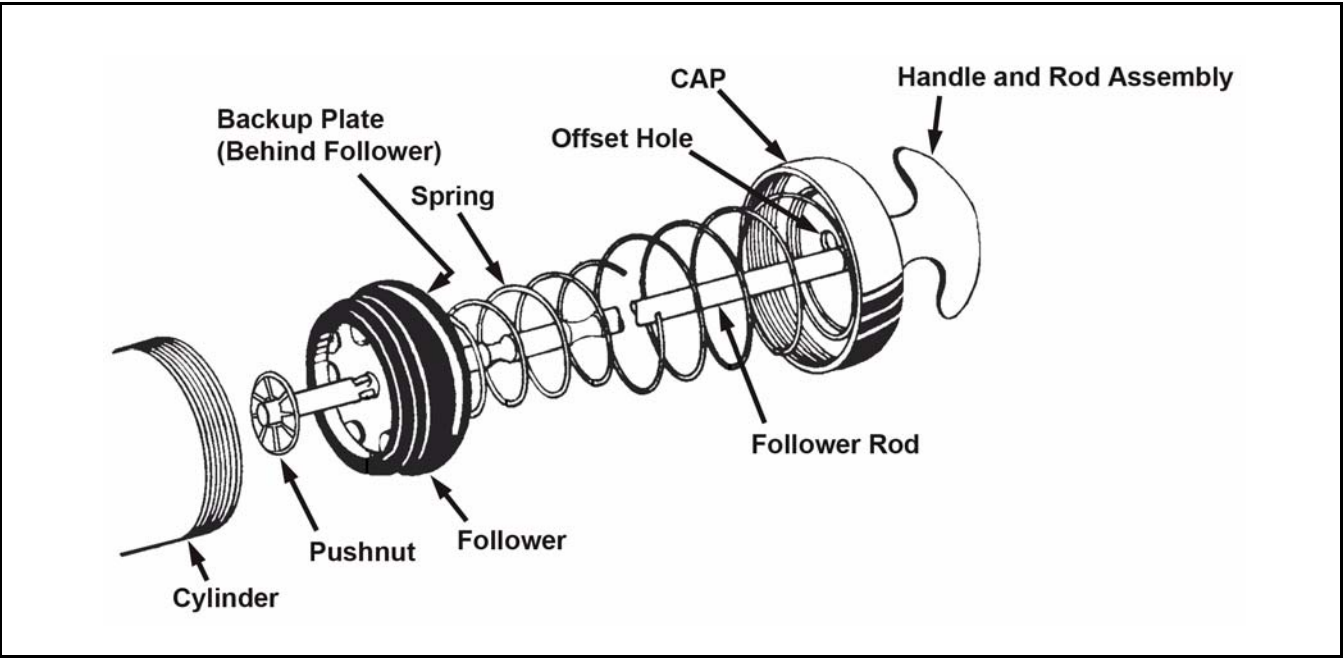

Figure 7 Cylinder Assembly

Repair Kits

393604 For Cylinder Assembly of 6243-J3 & 6679-J3 Grease Guns	
Description	Qty.
Follower	5
Backup Plate	2
Pushnut	5
393525 For Cylinder Assembly of 6243-J3 & 6679-J3 Grease Guns	
Follower	1
Backup Plate	1
Spring	1
Cap	1
Pushnut	1
Handle and Rod Assembly	1
393610 For Cylinder Head of 6243-J3 Gun	
Jewett-Ring Packing	1
Packing Screw	1

Changes Since Last Printing
Edited Repair Kits