

## Grease Loader Pump

### Description

The major components of pump assembly 7118-1 consist of a:

- hand-operated pump
- drum cover assembly
- follower plate
- loader fitting
- loader coupler

This hand-operated pump is designed to load grease guns directly from 35-pound containers. See **Figure 1**.

---

**The loader fitting included must be used in place of an existing gun fitting to ensure compatibility.**

---

### Pump Delivery

The pump delivers approximately 14 ounces (420 grams) of grease in 15 strokes.

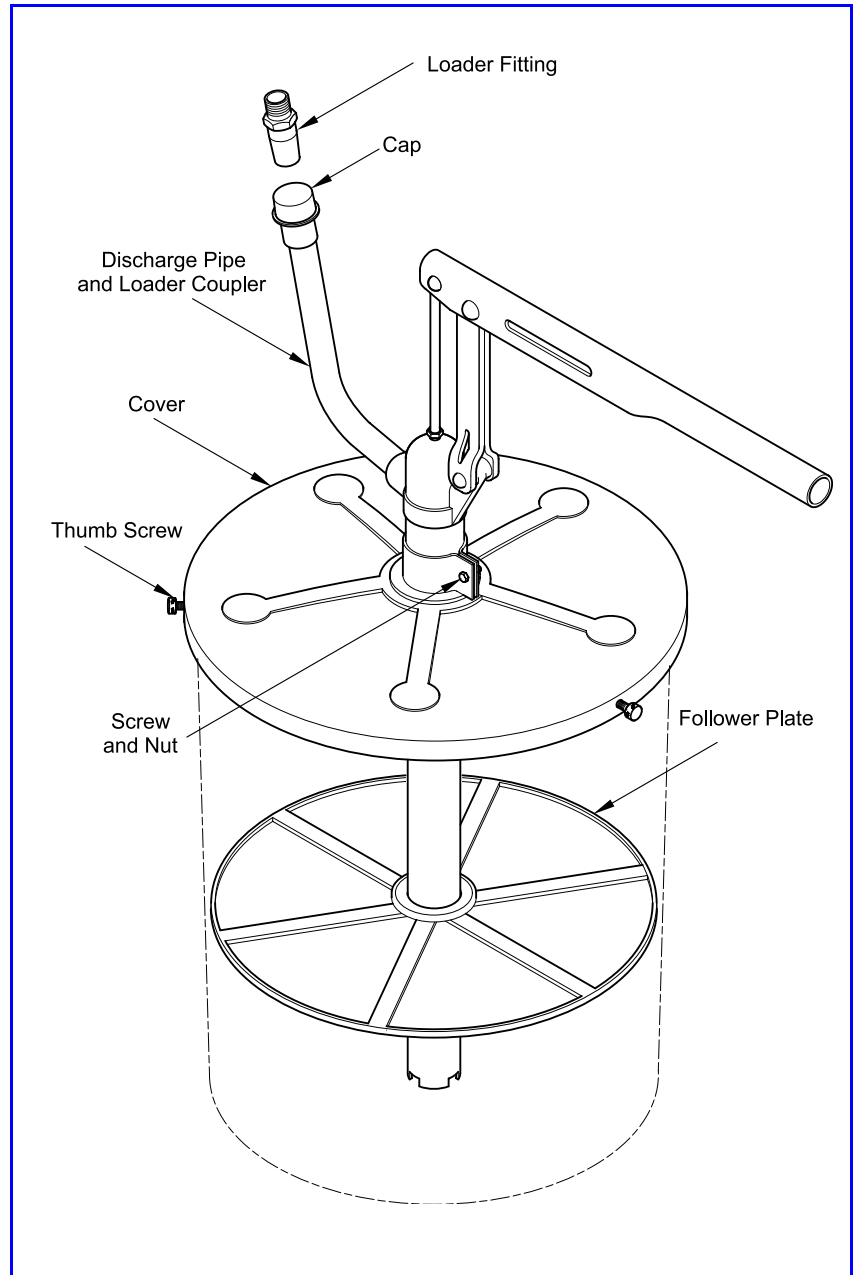

**Figure 1** Grease Loader Pump Model 7118-1

---

Alemite Corporation  
PO Box 473515, Charlotte, North Carolina 28247-3515  
[www.alemite.com](http://www.alemite.com)

Copyright © 2001 by Alemite Corporation

This document contains confidential information that is the property of Alemite Corporation and is not to be copied, used, or disclosed to others without express written permission.

SER 7118-1  
Revision (8-01)

## Assembly

1. Insert the Pump Assembly through the Cover.

**NOTE:** Do not tighten the Screw and Nut that clamps the Pump Tube to the Cover at this time.

2. Place the Follower Plate onto the top of the grease.
  - With a wobbling motion, eliminate any air that may be trapped underneath the Follower Plate. Force the grease through the hole in the center of the plate.
3. Guide the Pump Tube into the Follower Plate and fit the Cover onto the Container.
  - Allow the Pump Tube to touch the bottom of the container.
4. Secure the Cover to the Container with Thumb Screws.
5. Tighten the Screw and Nut to clamp the Pump Assembly firmly in place.
6. Screw the Discharge Pipe and Loader Coupler Assembly into the Pump Head.
  - Tighten to the upright position.

## Priming the Pump

1. Remove the Cap from the Loader Coupler.
2. Pump the Lever until grease is visible at the Loader Coupler.

## Grease Gun Loading

---

### CAUTION

**The Loader Fitting on the grease gun must mate with the Loader Coupler. The pump will not operate if the components are not compatible.**

---

Grease guns equipped with an **Alemite** loader fitting can connect directly to the loader pump.

Non-compatible loader fittings must be replaced with the included loader fitting B306740.

**NOTE:** Optional loader fitting B322610 is available for fibrous or heavy greases.

### Loading Operation

1. Make sure the follower rod on the grease gun is engaged with the back-up plate.
2. Remove the Cap on the pump's Loader Coupler.
3. Seat the Loader Fitting into the Loader Coupler.
4. Operate the pump and view the movement of the follower rod.
5. Discontinue pump operation once the groove on the follower rod is visible.

**Changes Since Last Printing**

Initial Release