

**Climax Metal Products Company**

8141 Tyler Boulevard

Mentor, Ohio 44060

USA

Toll free: 800-542-6552

Phone: 440-585-0300

Fax: 800-860-5553

Email: sales@climaxmetal.comWebsite: www.climaxmetal.com

ITEM # H2C-087, TWO-PIECE CLAMPING COLLAR RECESSED SCREW H2C-SERIES

Black Oxide Plated Steel Two-Piece Clamping Collar - Recessed Screw Head. Recessed Screw Head provides an outside surface free of major projections for safety. Design fully engages the shaft without marring. Easily installed where major disassembly would otherwise be required. Greater axial holding power than set screw or one-piece clamping collars. Effective on hard & soft shafts.

[Drawing](#) | [Specifications](#) |

Drawing

Dimensional Drawing

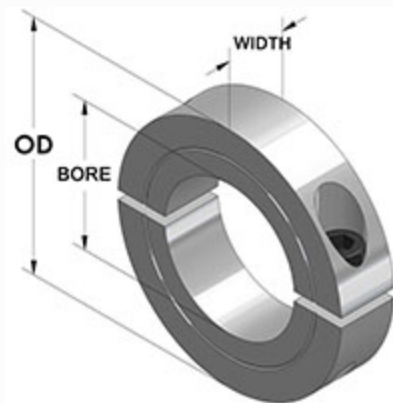

Two-Piece Clamping Collar Recessed Screw

Specifications

| | |
|---------------------------|---|
| Bore | 7/8 in |
| OD | 1 7/8 in |
| Width | 1/2 in |
| Style | Two-Piece Clamp |
| Material | Steel, ASTM A108 |
| Finish | Black Oxide |
| Clamp Screw | Hex Socket Cap Screw, 3A Thread, Steel, ASTM A574: 1/4-28 x 5/8 |
| Recessed Screw | Yes |
| Approximate Weight | 4.10 oz |
| UPC Code | 044861251782 |
| Downloads | Catalog Page |

Competitor Part Number

| | |
|------------------------------|--|
| Alternate Part Number | 101783931 1570058 175D03348 214373 214374 214375 2L014 2SC87 3444081 H2C087 |
|------------------------------|--|