

Climax Metal Products Company

8141 Tyler Boulevard

Mentor, Ohio 44060

USA

Toll free: 800-542-6552

Phone: 440-585-0300

Fax: 800-860-5553

 Email: sales@climaxmetal.com

 Website: www.climaxmetal.com

ITEM # H2C-118-S, TWO-PIECE CLAMPING COLLAR RECESSED SCREW H2C-SERIES

Stainless Steel Two-Piece Clamping Collar - Recessed Screw Head. Recessed Screw Head provides an outside surface free of major projections for safety. Design fully engages the shaft without marring. Easily installed where major disassembly would otherwise be required. Greater axial holding power than set screw collars. Effective on hard & soft shafts.



[Drawing](#) | [Specifications](#) |

Drawing

Dimensional Drawing

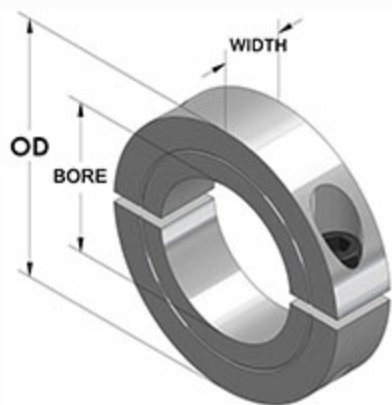

Two-Piece Clamping Collar Recessed Screw

Specifications

Bore	1 3/16 in
OD	2 1/8 in
Width	1/2 in
Style	Two-Piece Clamp
Material	Stainless Steel, ASTM A582
Finish	Plain
Clamp Screw	Hex Socket Cap Screw, 3A Thread, Stainless Steel, ASTM F837: 1/4-28 x 3/4
Recessed Screw	Yes
Approximate Weight	4.64 oz
UPC Code	044861963791
Downloads	Catalog Page

Competitor Part Number

Alternate Part Number	0404406 101944392 175D03370 214408 214409 2774596 2S103 2SSC118 H2C118S
------------------------------	---