



Climax Metal Products Company

8141 Tyler Boulevard
Mentor, Ohio 44060
USA

Toll free: 800-542-6552

Phone: 440-585-0300

Fax: 800-860-5553

Email: sales@climaxmetal.com

Website: www.climaxmetal.com

ITEM # ISCC-050-050-KW, ONE-PIECE, CLAMPING COUPLINGS W/KEYWAY ISCC-SERIES

Black Oxide Steel One-Piece Industry Standard Clamping Coupling with Keyway. High axial load & torque capacity. Does not mar the shaft.



[Drawing](#) | [Specifications](#) |

Drawing

Dimensional Drawing

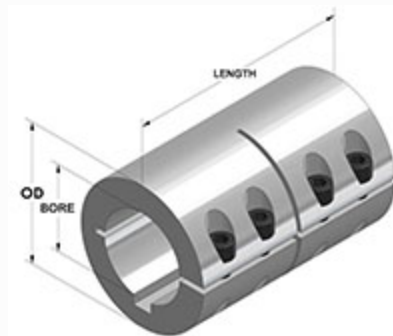

One-Piece Clamping Coupling with Keyway

Specifications

Bore	1/2 in
2nd Bore	1/2 in
OD	1 1/8 in
Length	1 3/4 in
Style	One-Piece Clamp
Keyway Size	1/8 x 1/16 in
Material	Steel, ASTM A108
Finish	Black Oxide
Clamp Screw	Hex Socket Cap Screw, 3A Thread, Steel, ASTM A574: 8-32 x 1/2
Recessed Screw	No
Approximate Weight	5.70 oz
UPC Code	044861416051
Downloads	Catalog Page

Competitor Part Number

Alternate Part Number	102173591
	175D50567
	2393075
	243574
	2AUW1
	4380469
	4819697
	61005K122
	7L008008K
	CC-105
	CLC88F
	CLC-8-8-F
	ISCC050050KW
	MA4380469