

Climax Metal Products Company

8141 Tyler Boulevard
Mentor, Ohio 44060
USA

Toll free: 800-542-6552

Phone: 440-585-0300

Fax: 800-860-5553

Email: sales@climaxmetal.com

Website: www.climaxmetal.com

ITEM # 2CC-075-075, TWO-PIECE CLAMPING COUPLINGS RECESSED SCREW 2CC-SERIES

Black Oxide Plated Steel Two-Piece Clamping Coupling - Recessed Screw Heads. Recessed Screw Head provides an outside surface free of major projections for safety. Easily installed where major disassembly would otherwise be required. Does not mar the shaft.

[View Catalog Page](#)



[Drawing](#) | [Specifications](#) |

Drawing

Dimensional Drawing

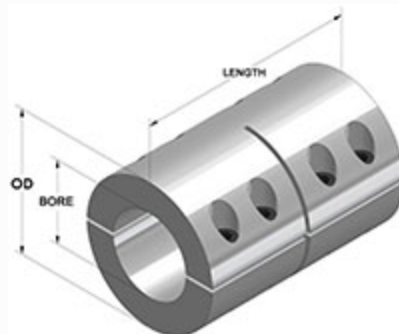

Two-Piece Clamping Coupling with Recessed Screw

Specifications

Bore	3/4 in
2nd Bore	3/4 in
OD	1 3/4 in
Length	2 5/8 in
Style	Two-Piece Clamp
Material	Steel, ASTM A108
Finish	Black Oxide
Clamp Screw	Hex Socket Cap Screw, 3A Thread, Steel, ASTM A574: 1/4-28 x 5/8
Recessed Screw	Yes
Approximate Weight	22.00 oz
UPC Code	044861267004
Downloads	Catalog Page

Competitor Part Number

Alternate Part Number	0403153 101782664 1510997 1571003 175D49495 243637 2CC075075 5L012012F
------------------------------	---