

Climax Metal Products Company

8141 Tyler Boulevard
Mentor, Ohio 44060
USA

Toll free: 800-542-6552

Phone: 440-585-0300

Fax: 800-860-5553

Email: sales@climaxmetal.com

Website: www.climaxmetal.com

ITEM # CC-112-112-KW, ONE-PIECE CLAMPING COUPLINGS RECESSED SCREW W/KEYWAY CC-SERIES

Black Oxide Plated Steel One-Piece Clamping Coupling with Keyway - Recessed Screw Heads. Recessed Screw Head provides an outside surface free of major projections for safety. Does not mar the shaft.

[View Catalog Page](#)



[Drawing](#) | [Specifications](#) |

Drawing

Dimensional Drawing

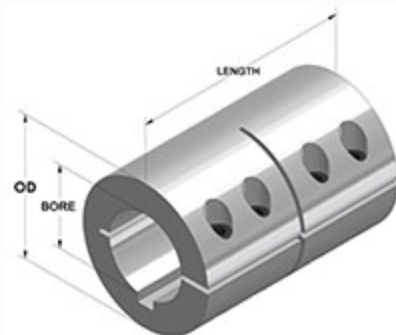

One-Piece Clamping Coupling Recessed Screw with Keyway

Specifications



Bore	1 1/8 in
2nd Bore	1 1/8 in
OD	2 1/8 in
Length	3 1/4 in
Style	One-Piece Clamp
Keyway Size	1/4 x 1/8 in
Material	Steel, ASTM A108
Finish	Black Oxide
Clamp Screw	Hex Socket Cap Screw, 3A Thread, Steel, ASTM A574: 1/4-28 x 3/4
Recessed Screw	Yes
Approximate Weight	34.70 oz
UPC Code	044861402429
Downloads	Catalog Page

Competitor Part Number



Alternate Part Number	0404332 102203118 175D50555 2393063 5L102102K 67366468 9688961 CC112112KW MA9688961
------------------------------	---