



### Climax Metal Products Company

8141 Tyler Boulevard  
Mentor, Ohio 44060  
USA

Toll free: 800-542-6552

Phone: 440-585-0300

Fax: 800-860-5553

Email: [sales@climaxmetal.com](mailto:sales@climaxmetal.com)

Website: [www.climaxmetal.com](http://www.climaxmetal.com)

## ITEM # 2MISCC-10-10-KW, METRIC TWO-PIECE INDUSTRY STANDARD CLAMPING COUPLINGS W/KEYWAY 2MISCC-SERIES

Black Oxide Steel Metric Two-Piece Industry Standard Clamping Coupling with Keyway. High axial load & torque capacity. Does not mar the shaft.



[Drawing](#) | [Specifications](#) |

### Drawing

#### Dimensional Drawing

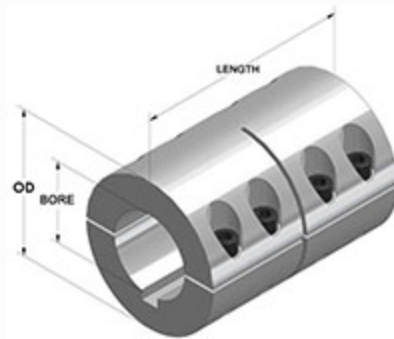

Metric Two-Piece Industry Standard Clamping Coupling with Keyway

## Specifications

<b>Bore</b>	10 mm
<b>2nd Bore</b>	10 mm
<b>OD</b>	29 mm
<b>Length</b>	45 mm
<b>Style</b>	Two-Piece Clamp
<b>Keyway Size</b>	3 x 1.8 mm
<b>Material</b>	Steel, ASTM A108
<b>Finish</b>	Black Oxide
<b>Clamp Screw</b>	Hex Socket Cap Screw, Steel: M4 x 12
<b>Recessed Screw</b>	No
<b>Approximate Weight</b>	5.00 oz
<b>UPC Code</b>	044861961858
<b>Downloads</b>	<a href="#">Catalog Page</a>

## Competitor Part Number

<b>Alternate Part Number</b>	0403863 103555135 175D49686 2278984 2337503 2758416 2ANG6 2MISCC1010KW 3999508 75256438 MSPC1010F MSPC-10-10-F
------------------------------	---