



Climax Metal Products Company

8141 Tyler Boulevard
Mentor, Ohio 44060
USA

Toll free: 800-542-6552

Phone: 440-585-0300

Fax: 800-860-5553

Email: sales@climaxmetal.com

Website: www.climaxmetal.com

ITEM # ISCC-125-125-KW, ONE-PIECE, CLAMPING COUPLINGS W/KEYWAY ISCC-SERIES

Black Oxide Steel One-Piece Industry Standard Clamping Coupling with Keyway. High axial load & torque capacity. Does not mar the shaft.



[Drawing](#) | [Specifications](#) |

Drawing

Dimensional Drawing

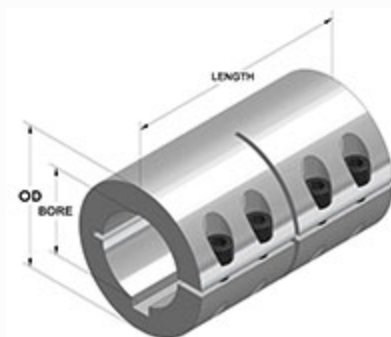

One-Piece Clamping Coupling with Keyway

Specifications

Bore	1 1/4 in
2nd Bore	1 1/4 in
OD	2 1/16 in
Length	3 1/4 in
Style	One-Piece Clamp
Keyway Size	1/4 x 1/8 in
Material	Steel, ASTM A108
Finish	Black Oxide
Clamp Screw	Hex Socket Cap Screw, 3A Thread, Steel, ASTM A574: 1/4-28 x 5/8
Recessed Screw	No
Approximate Weight	28.40 oz
UPC Code	044861410134
Downloads	Catalog Page

Competitor Part Number

Alternate Part Number	0404442
	1571441
	175D50560
	2393068
	243579
	2ALJ7
	61005K188
	7L104104K
	9655445
	CC-119
	CLC2020F
	CLC-20-20-F
	ISCC125125KW
	MA1571441