

Climax Metal Products Company

8141 Tyler Boulevard

Mentor, Ohio 44060

USA

Toll free: 800-542-6552

Phone: 440-585-0300

Fax: 800-860-5553

Email: sales@climaxmetal.com

Website: www.climaxmetal.com

ITEM # H2C-425, TWO-PIECE CLAMPING COLLAR RECESSED SCREW H2C-SERIES

Black Oxide Plated Steel Two-Piece Clamping Collar. Design fully engages the shaft without marring. Easily installed where major disassembly would otherwise be required. Greater axial holding power than set screw or one-piece clamping collars. Effective on hard & soft shafts.



[Drawing](#) | [Specifications](#) |

Drawing

Dimensional Drawing

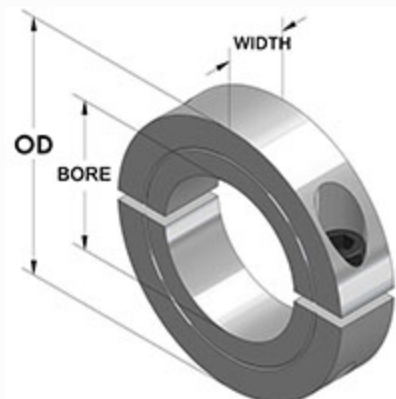

Two-Piece Clamping Collar Recessed Screw

Specifications

| | |
|---------------------------|---|
| Bore | 4 1/4 in |
| OD | 5 1/2 in |
| Width | 7/8 in |
| Style | Two-Piece Clamp |
| Material | Steel, ASTM A108 |
| Finish | Black Oxide |
| Clamp Screw | Hex Socket Cap Screw, 3A Thread, Steel, ASTM A574: 3/8-24 x 1 |
| Recessed Screw | No |
| Approximate Weight | 35.00 oz |
| UPC Code | 044861250310 |
| Downloads | Catalog Page |

Competitor Part Number

| | |
|------------------------------|---|
| Alternate Part Number | 101806821 1571117 175D03498 214590 2L404 62273636 H2C425 SP-68-F |
|------------------------------|---|