

**Climax Metal Products Company**

8141 Tyler Boulevard

Mentor, Ohio 44060

USA

Toll free: 800-542-6552

Phone: 440-585-0300

Fax: 800-860-5553

Email: sales@climaxmetal.comWebsite: www.climaxmetal.com

ITEM # C-418, SET SCREW COLLAR C-SERIES

Zinc Plated Steel Set Screw Collar. Traditional cost effective collar design.



[Drawing](#) | [Specifications](#) |

Drawing

Dimensional Drawing

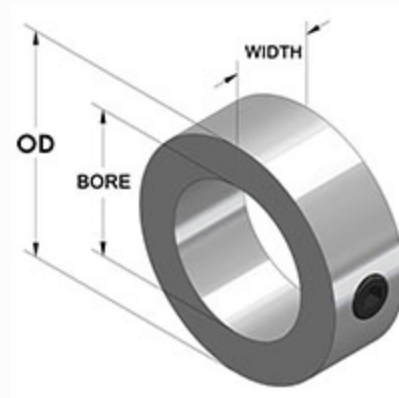

Set Screw Collar

Specifications

Bore	4 3/16 in
OD	5 1/2 in
Width	1 1/8 in
Style	Set Screw
Material	Steel, ASTM A108
Finish	Zinc Plated
Set Screw	Hex Socket Set Screw, 3A Thread, Steel, ASTM F912: 1/2-13 x 1/2
Approximate Weight	51.00 oz
UPC Code	044861002001
Downloads	Catalog Page

Competitor Part Number**Alternate Part Number**

101781105
1570492
175D08436
228075
6L403P2
C418
SC-67-FZ