



### Climax Metal Products Company

8141 Tyler Boulevard  
Mentor, Ohio 44060  
USA

Toll free: 800-542-6552

Phone: 440-585-0300

Fax: 800-860-5553

Email: [sales@climaxmetal.com](mailto:sales@climaxmetal.com)

Website: [www.climaxmetal.com](http://www.climaxmetal.com)

## ITEM # 2MISCC-08-08SKW, METRIC TWO-PIECE INDUSTRY STANDARD CLAMPING COUPLINGS W/KEYWAY 2MISCC-SERIES

Stainless Steel Metric Two-Piece Industry Standard Clamping Coupling with Keyway. High axial load & torque capacity. Does not mar the shaft.



[Drawing](#) | [Specifications](#) |

### Drawing

#### Dimensional Drawing

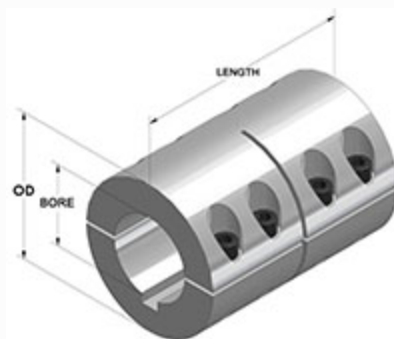

Metric Two-Piece Industry Standard Clamping Coupling with Keyway

## Specifications

<b>Bore</b>	8 mm
<b>2nd Bore</b>	8 mm
<b>OD</b>	24 mm
<b>Length</b>	35 mm
<b>Style</b>	Two-Piece Clamp
<b>Keyway Size</b>	2 x 1.2 mm
<b>Material</b>	Stainless Steel, ASTM A582
<b>Finish</b>	Plain
<b>Clamp Screw</b>	Hex Socket Cap Screw, Stainless Steel: M3 x 10
<b>Recessed Screw</b>	No
<b>Approximate Weight</b>	2.70 oz
<b>UPC Code</b>	044861992029
<b>Downloads</b>	<a href="#">Catalog Page</a>

## Competitor Part Number

<b>Alternate Part Number</b>	0403861 103187604 175D49685 2337530 2758415 2774654 2ANR3 2MISCC0808SKW 3999525 MSPC88SS MSPC-8-8-SS
------------------------------	--