



Climax Metal Products Company

8141 Tyler Boulevard
Mentor, Ohio 44060
USA

Toll free: 800-542-6552

Phone: 440-585-0300

Fax: 800-860-5553

Email: sales@climaxmetal.com

Website: www.climaxmetal.com

ITEM # 2ISCC-150-150, TWO-PIECE INDUSTRY STANDARD CLAMPING COUPLINGS 2ISCC-SERIES

Black Oxide Steel Two-Piece Industry Standard Clamping Coupling. High axial load & torque capacity. Does not mar the shaft.



[Drawing](#) | [Specifications](#) |

Drawing

Dimensional Drawing

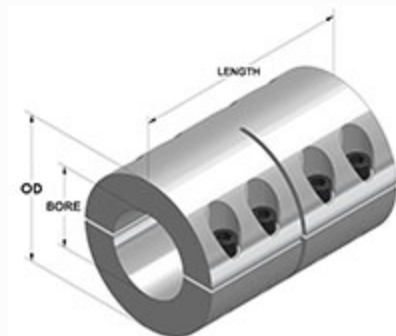

Two-Piece Industry Standard Clamping Coupling

Specifications

Bore	1 1/2 in
2nd Bore	1 1/2 in
OD	2 5/8 in
Length	3 7/8 in
Style	Two-Piece Clamp
Material	Steel, ASTM A108
Finish	Black Oxide
Clamp Screw	Hex Socket Cap Screw, 3A Thread, Steel, ASTM A574: 5/16-24 x 1
Recessed Screw	No
Approximate Weight	49.50 oz
UPC Code	044861051696
Downloads	Catalog Page

Competitor Part Number

Alternate Part Number

0403852
 101808476
 1571415
 175D50532
 2069810
 2393040
 2AUK7
 2ISCC150150
 3708784
 60845K67
 75242081
 7L108108F
 CC-523
 MA1571415
 SPX2424F
 SPX-24-24-F