



### Climax Metal Products Company

8141 Tyler Boulevard  
Mentor, Ohio 44060  
USA

Toll free: 800-542-6552

Phone: 440-585-0300

Fax: 800-860-5553

Email: [sales@climaxmetal.com](mailto:sales@climaxmetal.com)

Website: [www.climaxmetal.com](http://www.climaxmetal.com)

## ITEM # ISCC-075-075SKW, ONE-PIECE, CLAMPING COUPLINGS W/KEYWAY ISCC-SERIES

Stainless Steel One-Piece Industry Standard Clamping Coupling with Keyway. High axial load & torque capacity. Does not mar the shaft.



[Drawing](#) | [Specifications](#) |

### Drawing

#### Dimensional Drawing

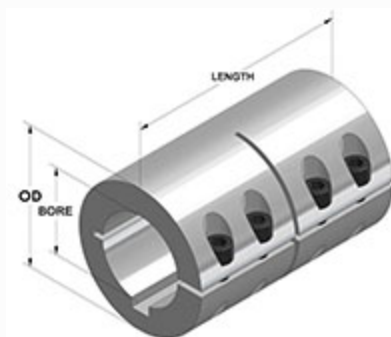

One-Piece Clamping Coupling with Keyway

### Specifications

|                           |  |
|---------------------------|--|
| <b>Bore</b>               | 3/4 in   |
| <b>2nd Bore</b>           | 3/4 in   |
| <b>OD</b>                 | 1 1/2 in   |
| <b>Length</b>             | 2 1/4 in   |
| <b>Style</b>              | One-Piece Clamp  |
| <b>Keyway Size</b>        | 3/16 x 3/32 in   |
| <b>Material</b>           | Stainless Steel, ASTM A582   |
| <b>Finish</b>             | Plain  |
| <b>Clamp Screw</b>        | Hex Socket Cap Screw, 3A Thread, Stainless Steel, ASTM F837:<br>1/4-28 x 5/8 |
| <b>Recessed Screw</b>     | No   |
| <b>Approximate Weight</b> | 12.20 oz   |
| <b>UPC Code</b>           | 044861431108   |
| <b>Downloads</b>          | <a href="#">Catalog Page</a>   |

### Competitor Part Number

|                              |  |
|------------------------------|--|
| <b>Alternate Part Number</b> | 102156576<br>1545173<br>175D50592<br>2393100<br>2ALH2<br>3866295<br>61005K244<br>70546148<br>79200<br>75012012K<br>CC-610<br>CLC1212SS<br>CLC-12-12-SS<br>ISCC075075SKW<br>MA3866295 |
|------------------------------|--|