

**Climax Metal Products Company**

8141 Tyler Boulevard  
Mentor, Ohio 44060  
USA

Toll free: 800-542-6552

Phone: 440-585-0300

Fax: 800-860-5553

Email: [sales@climaxmetal.com](mailto:sales@climaxmetal.com)

Website: [www.climaxmetal.com](http://www.climaxmetal.com)

## ITEM # 2MISCC-35-35-KW, METRIC TWO-PIECE INDUSTRY STANDARD CLAMPING COUPLINGS W/KEYWAY 2MISCC-SERIES

Black Oxide Steel Metric Two-Piece Industry Standard Clamping Coupling with Keyway. High axial load & torque capacity. Does not mar the shaft.



[Drawing](#) | [Specifications](#) |

### Drawing

#### Dimensional Drawing

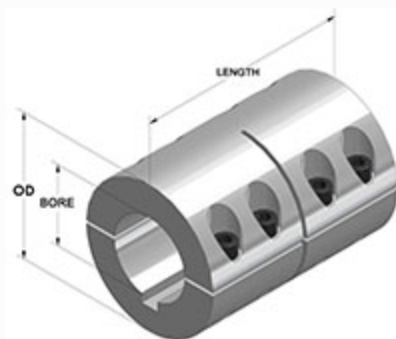

Metric Two-Piece Industry Standard Clamping Coupling with Keyway

## Specifications

<b>Bore</b>	35 mm
<b>2nd Bore</b>	35 mm
<b>OD</b>	67 mm
<b>Length</b>	95 mm
<b>Style</b>	Two-Piece Clamp
<b>Keyway Size</b>	10 x 5 mm
<b>Material</b>	Steel, ASTM A108
<b>Finish</b>	Black Oxide
<b>Clamp Screw</b>	Hex Socket Cap Screw, Steel: M8 x 25
<b>Recessed Screw</b>	No
<b>Approximate Weight</b>	38.40 oz
<b>UPC Code</b>	044861962534
<b>Downloads</b>	<a href="#">Catalog Page</a>

## Competitor Part Number

<b>Alternate Part Number</b>	0403895
	101784346
	1571424
	175D40958
	2337521
	2391845
	2AU6
	2MISCC3535KW
	3999520
	75256669
	MA1571424
	MSPC3535F
	MSPC-35-35-F