



Climax Metal Products Company

8141 Tyler Boulevard
Mentor, Ohio 44060
USA

Toll free: 800-542-6552

Phone: 440-585-0300

Fax: 800-860-5553

Email: sales@climaxmetal.com

Website: www.climaxmetal.com

ITEM # R2CC-100-100-S, RE-MACHINABLE COUPLINGS R2CC-SERIES

Stainless Steel Re-Machinable Coupling. These unique two-piece rigid clamping couplings come with an undersized ID. Allows you room to re-bore the ID without damaging the clamp screws. Pilot bore can be opened to the nominal ID reflected in the part number.



[Drawing](#) | [Specifications](#) |

Drawing

Dimensional Drawing

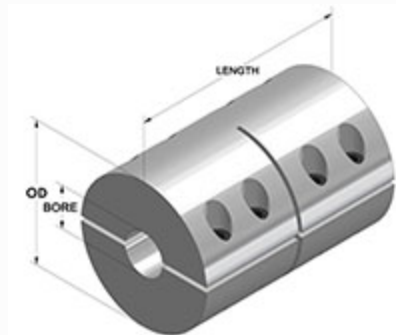

Re-Machinable Coupling

Specifications

| | |
|---------------------------|---|
| Pilot Bore | 1/2 in |
| Max Bore | 1 in |
| OD | 2 in |
| Length | 3 in |
| Style | Two-Piece Clamp |
| Material | Stainless Steel, ASTM A582 |
| Finish | Plain |
| Clamp Screw | Hex Socket Cap Screw, 3A Thread, Stainless Steel, ASTM F837: 1/4-28 x 5/8 |
| Approximate Weight | 36.40 oz |
| UPC Code | 044861470152 |
| Downloads | Catalog Page |

Competitor Part Number

| | |
|------------------------------|-------------|
| Alternate Part Number | 0404643 |
| | 101783780 |
| | 1571763 |
| | 175D50650 |
| | 2393158 |
| | 70548151 |
| | MA1571763 |
| | R2CC100100S |