



Climax Metal Products Company

8141 Tyler Boulevard
Mentor, Ohio 44060
USA

Toll free: 800-542-6552

Phone: 440-585-0300

Fax: 800-860-5553

Email: sales@climaxmetal.com

Website: www.climaxmetal.com

ITEM # ISCC-150-150SKW, ONE-PIECE, CLAMPING COUPLINGS W/KEYWAY ISCC-SERIES

Stainless Steel One-Piece Industry Standard Clamping Coupling with Keyway. High axial load & torque capacity. Does not mar the shaft.



[Drawing](#) | [Specifications](#) |

Drawing

Dimensional Drawing

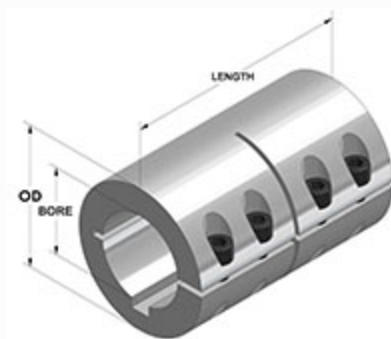

One-Piece Clamping Coupling with Keyway

Specifications

Bore	1 1/2 in
2nd Bore	1 1/2 in
OD	2 5/8 in
Length	3 7/8 in
Style	One-Piece Clamp
Keyway Size	3/8 x 3/16 in
Material	Stainless Steel, ASTM A582
Finish	Plain
Clamp Screw	Hex Socket Cap Screw, 3A Thread, Stainless Steel, ASTM F837: 5/16-24 x 1
Recessed Screw	No
Approximate Weight	49.50 oz
UPC Code	044861431283
Downloads	Catalog Page

Competitor Part Number

Alternate Part Number	103556633
	175D31020
	2025944
	2336636
	2758600
	2ALK8
	61005K733
	70546254
	7S108108K
	CLC2424SS
	CLC-24-24-SS
	ISCC150150SKW