



Climax Metal Products Company

8141 Tyler Boulevard
Mentor, Ohio 44060
USA

Toll free: 800-542-6552

Phone: 440-585-0300

Fax: 800-860-5553

Email: sales@climaxmetal.com

Website: www.climaxmetal.com

ITEM # 2MISCC-40-40SKW, METRIC TWO-PIECE INDUSTRY STANDARD CLAMPING COUPLINGS W/KEYWAY 2MISCC-SERIES

Stainless Steel Metric Two-Piece Industry Standard Clamping Coupling with Keyway. High axial load & torque capacity. Does not mar the shaft.



[Drawing](#) | [Specifications](#) |

Drawing

Dimensional Drawing

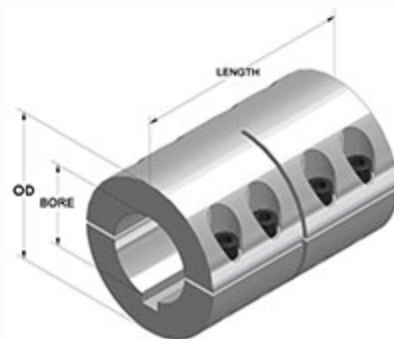

Metric Two-Piece Industry Standard Clamping Coupling with Keyway

Specifications

Bore	40 mm
2nd Bore	40 mm
OD	77 mm
Length	108 mm
Style	Two-Piece Clamp
Keyway Size	12 x 5 mm
Material	Stainless Steel, ASTM A582
Finish	Plain
Clamp Screw	Hex Socket Cap Screw, Stainless Steel: M8 x 25
Recessed Screw	No
Approximate Weight	89.00 oz
UPC Code	044861961971
Downloads	Catalog Page

Competitor Part Number

Alternate Part Number	0403901
	103555970
	175D30816
	1926968
	2093413
	2279004
	2758533
	2ANN9
	2MISCC4040SKW
	75256727
	MSPC4040SS
	MSPC-40-40-SS