

SELECTION/DIMENSIONS

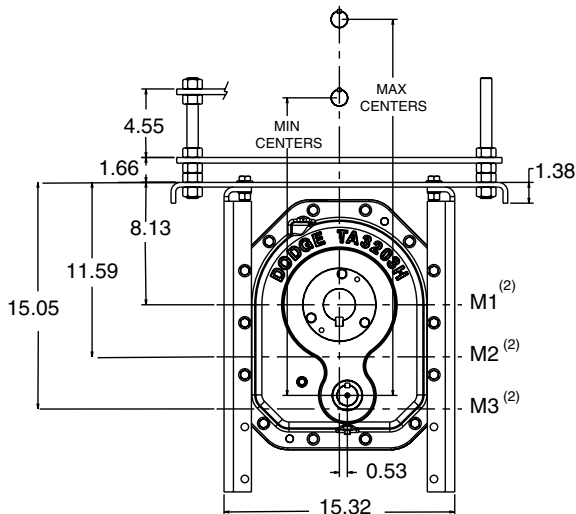

TORQUE-ARM II Shaft Mount Speed Reducers

MOTOR MOUNT DIMENSIONS - TA3203H, POSITION B & D



POSITION B

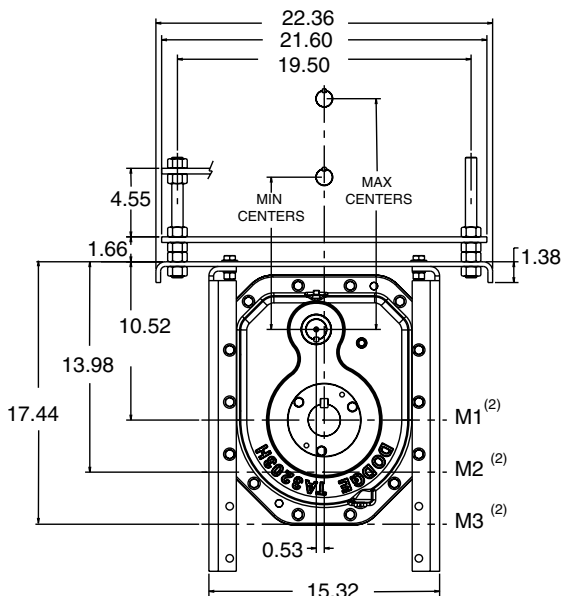

POSITION D

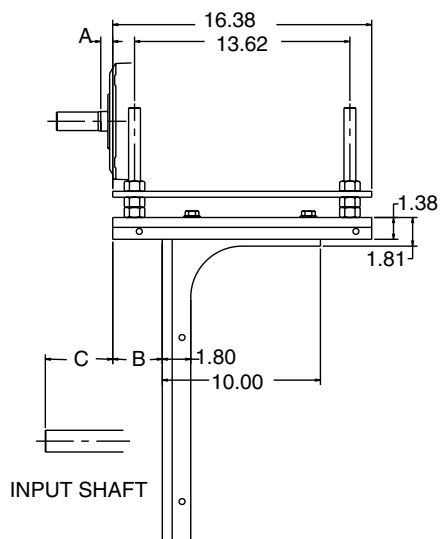

EASY SELECTION PAGE 9	SELECTION PAGE 12	RELATED PRODUCTS PAGE 123	ENGINEERING/TECHNICAL PAGE 129
--------------------------	----------------------	------------------------------	-----------------------------------

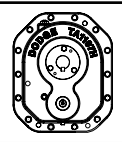

SELECTION/DIMENSIONS

TORQUE-ARM II Shaft Mount Speed Reducers

MOTOR MOUNT DIMENSIONS - TA3203H, POSITION B & D ⁽¹⁾

Mounting	Lateral Adjustment				Motor Mount Height (2)	Motor Frame					
						143T & 145T			182T & 184T		
	B Min	B max	C Min	C max		A	Centers		A	Centers	
							Min	Max		Min	Max
Position B	0.04	5.34	2.06	7.36	M1	1.22	19.8	23.9	1.37	20.8	24.9
					M2		23.3	27.3		24.3	28.3
					M3		26.7	30.8		27.7	31.8
Position D	0.04	5.34	2.06	7.36	M1	1.22	10.2	14.2	1.37	11.2	15.2
					M2		13.6	17.7		14.6	18.7
					M3		17.1	21.1		18.1	22.1

Mounting	Motor Mount Height (2)	Motor Frame								
		213T & 215T			254T & 256T			284T & 286T		
		A	Centers		A	Centers		A	Centers	
			Min	Max		Min	Max		Min	Max
Position B	M1	1.55	21.6	25.6	1.56	22.6	26.6	1.16	23.3	27.4
	M2		25.0	29.1		26.0	30.1		26.8	30.8
	M3		28.5	32.5		29.5	33.5		30.2	34.3
Position D	M1	1.55	11.9	16.0	1.56	12.9	17.0	1.16	13.7	17.7
	M2		15.4	19.4		16.4	20.4		17.1	21.2
	M3		18.8	22.9		19.8	23.9		20.6	24.6

Note:

Minimum centers contain 0.5" to allow for belt assembly

(1) Motor mount will fit NEMA and IEC frame motors; hardware are inch dimensions

(2) M1, M2, M3 go through output shaft centerline

SELECTION/DIMENSIONS

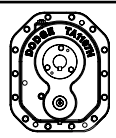

TORQUE-ARM II Shaft Mount Speed Reducers

MOTOR MOUNT DIMENSIONS - TA3203H, POSITION A & C

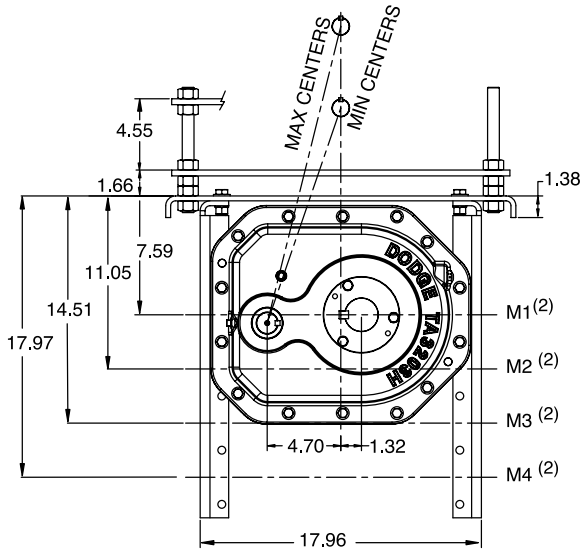

POSITION A

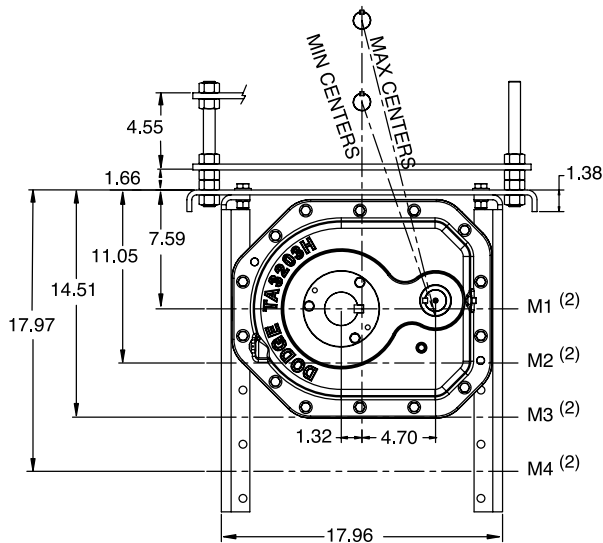
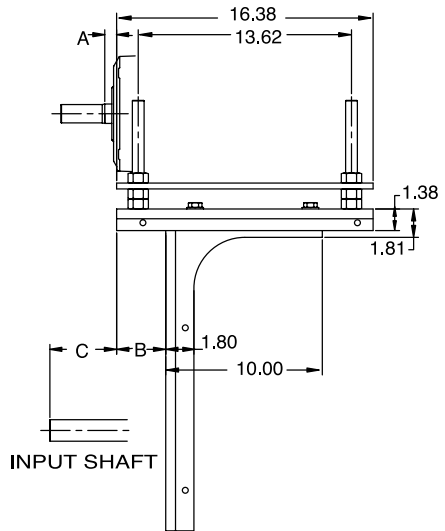

POSITION C

EASY SELECTION PAGE 9	SELECTION PAGE 12	RELATED PRODUCTS PAGE 123	ENGINEERING/TECHNICAL PAGE 129
--------------------------	----------------------	------------------------------	-----------------------------------

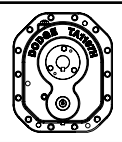

SELECTION/DIMENSIONS

TORQUE-ARM II Shaft Mount Speed Reducers

MOTOR MOUNT DIMENSIONS - TA3203H, POSITION A & C ^{(1) (3)}

Mounting	Lateral Adjustment				Motor Mount Height (2)	Motor Frame					
						143T & 145T			182T & 184T		
						A	Centers		A	Centers	
Min	Max	Min	Max								
Position A	0.04	5.34	3.07	8.37	M1	1.22	14.6	18.4	1.37	15.5	19.4
					M2		17.9	21.8		18.9	22.8
					M3		21.2	25.2		22.2	26.2
					M4		24.6	28.6		25.6	29.6
Position C	0.04	5.34	3.07	8.37	M1	1.22	13.6	17.4	1.37	14.5	18.4
					M2		16.9	20.8		17.8	21.7
					M3		20.2	24.2		21.2	25.1
					M4		23.6	27.6		24.6	28.5

Mounting	Motor Mount Height (2)	Motor Frame								
		213T & 215T			254T & 256T			284T & 286T		
		A	Centers		A	Centers		A	Centers	
Min	Max		Min	Max		Min	Max			
Position A	M1	1.55	16.2	20.1	1.56	17.2	21.1	1.16	17.9	21.8
	M2		19.6	23.5		20.5	24.5		21.3	25.2
	M3		22.9	26.9		23.9	27.9		24.7	28.6
	M4		26.3	30.3		27.3	31.3		28.1	32.1
Position C	M1	1.55	15.2	19.1	1.56	16.2	20.1	1.16	16.9	20.8
	M2		18.6	22.5		19.5	23.5		20.2	24.2
	M3		21.9	25.9		22.9	26.9		23.6	27.6
	M4		25.3	29.3		26.3	30.3		27.0	31.0

Note:

Minimum centers contain 0.5" to allow for belt assembly

- (1) Motor mount will fit NEMA and IEC frame motors; hardware are inch dimensions
- (2) M1, M2, M3, M4 go through output shaft centerline
- (3) See Table A, below, for minimum "M" mounting position required for specific screw diameter and reducer size

Table A - Screw Conveyor Motor Mount Minimum "M" Mounting Positions (1)

Nominal Screw Dia	Trough Height Dim	Minimum Mounting Position							
		TA0107L	TA1107H	TA2115H	TA3203H	TA4207H	TA5215H	TA6307H	TA7315H
6	7.00	M2	M3	M2	M2	M2	M1	M1	M1
9	9.00	M3	M4	M3	M3	M2	M2	M2	M1
12	10.00	M4	M4	M3	M3	M2	M2	M2	M1
14	11.00	M4	M4	M4	M3	M3	M2	M2	M2
16	11.50	M4	***	M4	M4	M3	M2	M2	M2
18	12.13	***	***	M4	M4	M3	M3	M2	M2
20	13.50	***	***	M4	M4	M3	M3	M3	M2
24	16.50	***	***	***	***	M4	M3	M3	M3

(1) For U Or Flared Trough Ends Per CEMA 300-014