

Catalog designation

SA37 AMS56
Helical-worm gear units S..

Click these icons for further information in Online Support



Reference data

Transaction : 424146014
Item : 100

Product data

Speed [r/min]	: 1750 / 78
Total ratio [i]	: 22,50 / finite
No. of teeth nom./denominator	: 45/2
Ma max [Nm]	: 70
Ta max [lb-in]	: 620
Mounting position	: M4A
Lubricant / -volume [l]	: CLP 680 Miner.Oil / 0,50
Lubricant volume [US gal]	: 0.13
Corrosion protection	: Yes
Surface protection	: OS2 to technical data sheet 01802_94
Paint coat	: Stainless Steel Gray
 Gear unit	 : SA37
Ma max G [Nm]	: 70
Ma max G [lb-in]	: 620
Hollow shaft	: 0.750 inch
Design	: Hollow shaft
Safety cover	: None
Breather variant	: Standard
Delivery state	: Breather valve mounted in flange
Screw plug bore dimens. sheet	: 27001_97
Documentation no. A	: 31978088
Spare parts list	: You can find the SWPL (spare and wearing parts list) under the serial number in the Online Support.
 Adapter	 : AMS56
Input flange	: Centering diameter 114.3mm, hole circle 149.2mm, bore 10.5 (NEMA)
 Coupling/bore D1	 : 0.625 inch (15.875mm)
Max. insertion depth (mot. SE)	: 52.3mm
Spare parts list	: You can find the SWPL (spare and wearing parts list) under the serial number in the Online Support.
 Nameplate	 : English / Imperial units
Nameplate position	: Attached to the gear unit
Opera.instr. A lang./quantity	: English / 0
Parts list/language/quantity	: English / 0
Commodity code	: 84834025

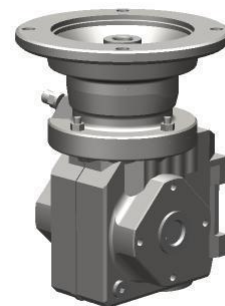

Weight : 9.86 kg