

# 100 Sprockets

## 1 1/4" Pitch

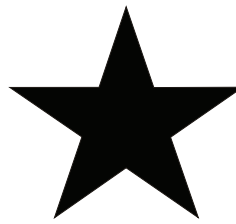

# BLACKSTAR®

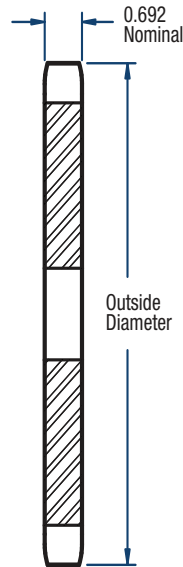

TYPE A

### Single- Type A

No. of Teeth	Catalog Number	Diameters (in)		Stock Bore (in)	Approx. Weight (lbs)
		Outside	Pitch		
7	H100A7	3.35	2.881	1	1.2
8	H100A8	3.77	3.266	1	1.4
9	H100A9	4.19	3.655	1	1.6
10	H100A10	4.60	4.045	1	2.0
11	H100A11	5.01	4.438	1-1/4	2.5
12	H100A12	5.42	4.830	1-1/4	3.0
13	H100A13	5.82	5.224	1-1/4	3.5
14	H100A14	6.23	5.618	1-1/4	4.1
15	H100A15	6.63	6.013	1-1/4	4.7
16	H100A16	7.03	6.408	1-1/4	5.4
17	H100A17	7.44	6.803	1-1/4	6.1
18	H100A18	7.84	7.199	1-1/4	7.0
19	H100A19	8.24	7.595	1-1/4	7.8
20	H100A20	8.64	7.990	1-1/4	8.8
21	H100A21	9.04	8.388	1-1/4	9.8
22	H100A22	9.44	8.784	1-1/4	10.5
23	H100A23	9.85	9.180	1-1/4	11.8
24	H100A24	10.25	9.576	1-1/4	12.8
25	H100A25	10.65	9.974	1-1/4	13.9
26	H100A26	11.05	10.370	1-1/4	15.0
27	H100A27	11.45	10.768	1-1/4	16.0
28	H100A28	11.84	11.164	1-1/4	17.4
29	H100A29	12.24	11.561	1-1/4	19.6
30	H100A30	12.64	11.959	1-1/4	20.1
31	100A31	13.04	12.355	1-1/4	21.5
32	100A32	13.44	12.753	1-1/4	22.6
33	100A33	13.84	13.150	1-1/4	24.1
34	100A34	14.24	13.548	1-1/4	26.0
35	100A35	14.64	13.945	1-1/4	27.2
36	100A36	15.04	14.343	1-1/4	30.0
37	100A37	15.44	14.740	1-1/4	31.0

No. of Teeth	Catalog Number	Diameters (in)		Stock Bore (in)	Approx. Weight (lbs)
		Outside	Pitch		
38	100A38	15.84	15.138	1-1/4	33.0
39	100A39	16.23	15.535	1-1/4	35.0
40	100A40	16.63	15.933	1-1/4	36.0
41	100A41	17.03	16.330	1-1/4	39.0
42	100A42	17.43	16.728	1-1/4	40.0
43	100A43	17.83	17.125	1-1/2	43.0
44	100A44	18.23	17.523	1-1/2	45.0
45	100A45	18.63	17.920	1-1/2	47.0
46	100A46	19.02	18.318	1-1/2	48.0
47	100A47	19.42	18.715	1-1/2	52.0
48	100A48	19.82	19.113	1-1/2	54.0
49	100A49	20.22	19.510	1-1/2	56.0
50	100A50	20.62	19.908	1-1/2	57.0
51	100A51	21.02	20.305	1-1/2	63.0
52	100A52	21.42	20.703	1-1/2	64.0
53	100A53	21.81	21.100	1-1/2	64.2
54	100A54	22.21	21.498	1-1/2	68.0
55	100A55	22.61	21.895	1-1/2	70.0
56	100A56	23.01	22.294	1-1/2	72.0
57	100A57	23.41	22.691	1-1/2	75.8
58	100A58	23.81	23.089	1-1/2	76.0
59	100A59	24.20	23.486	1-1/2	77.0
60	100A60	24.60	23.884	1-1/2	80.0
70	100A70	28.58	27.861	1-1/2	113.0
72	100A72	29.38	28.658	1-1/2	119.0
76	100A76	30.97	30.248	1-1/2	133.0
80	100A80	32.57	31.839	1-1/2	146.0
84	100A84	34.16	33.430	1-1/2	162.0
90	100A90	36.55	35.818	1-1/2	193.0
96	100A96	38.93	38.204	1-1/2	215.0

Sprockets with "H" prefix have hardened teeth.