

100 Sprockets

1 1/4" Pitch

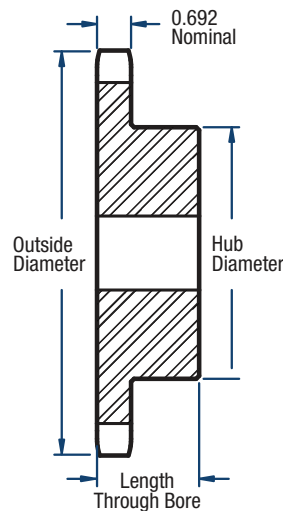

BLACKSTAR®



TYPE B

Single- Type B

No. of Teeth	Catalog Number	Diameters (in)		Bore (in)		Hub (in)		Approx. Weight (lbs)
		Outside	Pitch	Min.	Max.	Diameter	Length Through Bore	
8	H100B8	3.77	3.266	1	1-1/4	2-7/16*	1-7/8	2.3
9	H100B9	4.19	3.655	1	1-5/8	2-13/16*	1-7/8	3.2
10	H100B10	4.60	4.045	1	1-7/8	3-1/4*	1-7/8	4.1
11	H100B11	5.01	4.438	1	2-1/4	3-9/16*	1-7/8	5.3
12	H100B12	5.42	4.830	1	2-1/4	4*	1-7/8	6.4
13	H100B13	5.82	5.224	1	2-3/8	3-7/8	1-5/8	6.6
14	H100B14	6.23	5.618	1-1/4	2-3/4	4-3/16	1-5/8	7.4
15	H100B15	6.63	6.013	1-1/4	3	4-1/2	1-3/4	9.2
16	H100B16	7.03	6.408	1-5/16	3	4-1/2	1-3/4	9.9
17	H100B17	7.44	6.803	1-5/16	3	4-1/2	1-3/4	10.8
18	H100B18	7.84	7.199	1-5/16	3	4-1/2	1-3/4	11.5
19	H100B19	8.24	7.595	1-5/16	3	4-1/2	2	13.1
20	H100B20	8.64	7.990	1-5/16	3	4-1/2	2	14.2
21	H100B21	9.04	8.388	1-5/16	3	4-1/2	2	15.3
22	H100B22	9.44	8.784	1-5/16	3	4-1/2	2	16.1
23	H100B23	9.85	9.180	1-1/4	3	4-1/2	2	17.2
24	H100B24	10.25	9.576	1-1/4	3	4-1/2	2	19.2
25	H100B25	10.65	9.974	1-1/4	3	4-1/2	2	19.5
26	H100B26	11.05	10.370	1-1/4	3-5/16	5	2	21.7
27	H100B27	11.45	10.768	1-1/4	3-5/16	5	2	23.0
28	H100B28	11.84	11.164	1-1/4	3-5/16	5	2	24.4
29	H100B29	12.24	11.561	1-1/4	3-5/16	5	2	25.0
30	H100B30	12.64	11.959	1-1/4	3-5/16	5	2	26.9
32	H100B32	13.44	12.753	1-1/4	3-5/16	5	2	29.8
35	100B35	14.64	13.945	1-1/4	3-5/16	5	2-1/2	36.9
36	100B36	15.04	14.343	1-1/4	3-5/16	5	2-1/2	38.6
38	100B38	15.84	15.138	1-1/4	3-5/16	5	2-1/2	41.5
39	100B39	16.23	15.535	1-1/4	3-5/16	5	2-1/2	43.6
40	100B40	16.63	15.933	1-1/4	3-5/16	5	2-1/2	46.9
42	100B42	17.43	16.728	1-1/4	3-5/16	5	2-1/2	50.4
45	100B45	18.63	17.920	1-1/2	3-5/16	5	2-1/2	54.0
48	100B48	19.82	19.113	1-1/2	4	6	2-1/2	66.0

*Has a recessed groove in the hub for chain clearance.
Sprockets with "H" prefix have hardened teeth.

NOTE: Maximum bores shown will accommodate a standard keyseat and a setscrew over the keyseat. Slightly larger bores are possible with no keyseat, a shallow keyseat, or a setscrew at an angle to the keyseat.