

# 100 Sprockets

## 1 1/4" Pitch

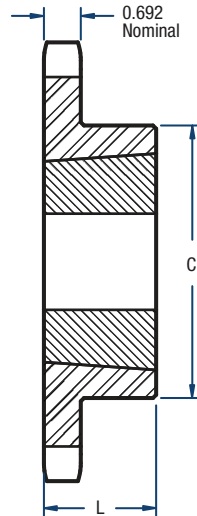

# BLACKSTAR®



TYPE B

### Single- TL Style

No. of Teeth	Catalog Number	Bushing	Diameters (in)		Type	Max. Bore	Dimensions (in)		Approx. Weight (lbs)	
			Outside	Pitch			L	C	Bushing Only	Sprocket Only
11	H100BTL11	1615	5.01	4.438	B	1-5/8	1-1/2	3	0.9	2.7
12	H100BTL12	1615	5.42	4.830	B	1-5/8	1-1/2	3-1/4	0.9	3.5
13	H100BTL13	2012	5.82	5.224	B	2	1-1/4	3-9/16	1.4	3.6
14	H100BTL14	2012	6.23	5.618	B	2	1-1/4	3-9/16	1.4	3.9
15	H100BTL15	2517	6.63	6.013	B	2-1/2	1-3/4	4-1/4	3.0	5.0
16	H100BTL16	2517	7.03	6.408	B	2-1/2	1-3/4	4-1/2	3.0	6.4
17	H100BTL17	2517	7.44	6.803	B	2-1/2	1-3/4	4-1/2	3.0	7.1
18	H100BTL18	2517	7.84	7.199	B	2-1/2	1-3/4	4-1/2	3.0	7.8
19	H100BTL19	2517	8.24	7.595	B	2-1/2	1-3/4	4-1/2	3.0	8.7
20	H100BTL20	2517	8.64	7.990	B	2-1/2	1-3/4	4-1/2	3.0	9.6
21	H100BTL21	2517	9.04	8.388	B	2-1/2	1-3/4	4-1/2	3.0	10.6
22	H100BTL22	2517	9.44	8.784	B	2-1/2	1-3/4	4-1/2	3.0	11.0
24	H100BTL24	2517	10.25	9.576	B	2-1/2	1-3/4	4-1/2	3.0	13.0
26	H100BTL26	2517	11.05	10.370	B	2-1/2	1-3/4	4-1/2	3.0	15.0
28	H100BTL28	3020	11.84	11.164	B	3	2	5-1/4	5.4	16.5
30	H100BTL30	3020	12.64	11.959	B	3	2	5-1/4	5.4	22.0
32	100BTL32	3020	13.44	12.753	B	3	2	5-1/4	5.4	23.0
35	100BTL35	3020	14.64	13.945	B	3	2	5-1/4	5.4	28.0
36	100BTL36	3020	15.04	14.343	B	3	2	5-1/4	5.4	31.0
40	100BTL40	3020	16.63	15.933	B	3	2	5-1/4	5.4	37.0
45	100BTL45	3020	18.63	17.920	B	3	2	5-1/4	5.4	46.0
48	100BTL48	3020	19.82	19.113	B	3	2	5-1/4	5.4	53.0
54	100BTL54	3020	22.21	21.498	B	3	2	5-1/4	5.4	62.0
60	100BTL60	3020	24.60	23.884	B	3	2	5-1/4	5.4	72.0

Sprockets with "H" prefix have hardened teeth.

**NOTE:** Maximum bores shown will accommodate a standard keyseat and a setscrew over the keyseat. Slightly larger bores are possible with no keyseat, a shallow keyseat, or a setscrew at an angle to the keyseat.