

100 Sprockets

1 1/4" Pitch

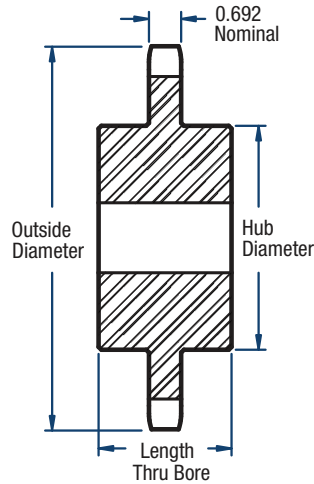
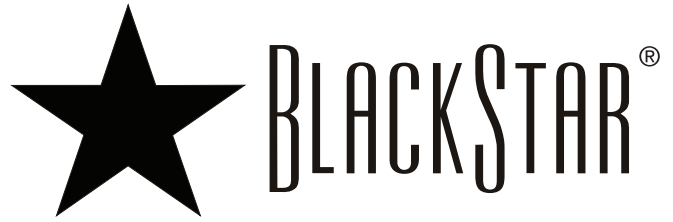

TYPE C

Single- Type C

No. of Teeth	Catalog Number	Diameters (in)		Bore (in)		Hub (in)		Approx. Weight (lbs)
		Outside Diameter	Pitch Diameter	Min.	Max.	Diameter	Length Through Bore	
10	H100C10	4.60	4.045	1	1-7/8	3-9/32	2 7/8	6.1
11	H100C11	5.01	4.438	1	2-1/4	3-9/16	2 7/8	7.1
12	H100C12	5.42	4.830	1	2-1/46	4	2 7/8	8.4
13	H100C13	5.82	5.224	1	2-3/8	3-57/64	2 7/8	10.0
14	H100C14	6.23	5.618	1-1/4	2-3/4	4-3/16	2 7/8	12.2
54	100C54	22.21	21.498	1-1/2	4	6	3-1/4	78.0
60	100C60	24.60	23.884	1-1/2	4	6	3-1/4	89.0
70	100C70	28.58	27.861	1-1/2	5-1/4	7	3-3/4	125.0
72	100C72	29.38	28.658	1-1/2	5-1/4	7	3-3/4	134.0
76	100C76	30.97	30.248	1-1/2	5-1/4	7	3-3/4	143.0
80	100C80	32.57	31.839	1-1/2	5-1/4	7	3-3/4	151.0
84	100C84	34.16	33.430	1-1/2	5-1/4	7	3-3/4	170.0
90	100C90	36.55	35.818	1-1/2	5-1/4	7	3-3/4	184.0
96	100C96	38.93	38.204	1-1/2	5-1/4	7	4-1/2	203.0

Sprockets with "H" prefix have hardened teeth.

NOTE: Maximum bores shown will accommodate a standard keyseat and a setscrew over the keyseat. Slightly larger bores are possible with no keyseat, a shallow keyseat, or a setscrew at an angle to the keyseat.